



OWNER'S MANUAL
Model Number
700455



BERCO PIONEER
Two Stage 48" Snowblower
For
ALL TERRAIN VEHICLES & UTILITY VEHICLES

- * ASSEMBLY
- * OPERATION

- * REPAIR PARTS
- * MAINTENANCE

CAUTION:
**READ & FOLLOW ALL SAFETY RULES & INSTRUCTIONS BEFORE
OPERATING YOUR EQUIPMENT**

LIMITED WARRANTY

Conditions and Products Covered:

BERCOMAC guarantees any part of the product or accessory manufactured by BERCOMAC and found in the reasonable judgment of BERCOMAC to be defective in material and or workmanship will be repaired or replaced by an authorized dealer without charge up to our maximum labor rates and pre-established times. For replacement parts only standard ground freight services are covered. This warranty extends to the original retail purchaser only and is not transferable to any subsequent purchasers.

Warranty Period

(from date of the original retail purchase):

- Residential use: 1 year
- Commercial or rental use: 90 days

Exceptions Noted Below: the following items are guaranteed by the original manufacturer and have their own warranty, conditions and limited time.

- Tire Chains: 90 days
- Engines (installed on BERCO equipment): 2 years
- Engines (sold separately): Validate with the dealer.

Please refer to the engine manufacturer's warranty statement included with the unit. Bercomac is not authorized to handle warranty adjustments on engines.

Items and Conditions NOT Covered:

This warranty does not cover the following:

- Pick-up or delivery charges or in-home services fees.
- Any damage or deterioration of the unit, parts and or finish of these due to normal use, wear and tear, or exposure.
- Cost of regular use or maintenance service or parts, such as gas, oil, lubricants, tune-up parts, and adjustments.
- Any part or accessory which has been altered, modified, misused, neglected, accidentally damaged or not properly installed, maintained, stored or repaired not in accordance with the instructions in the owner's manual.
- Repair due to normal wear and or any wear items such as shear pins, bolts, belts, etc.
- Expedited freight fee services for replacement parts.
- Shear bolts and shear pins are to be considered as a preventive measure not as an assured protection, any damages resulting from the lack of shear bolts breakage are not covered.

NOTE: All warranty work must be performed by an authorized

Note: BERCOMAC reserves the right to change or improve the design of any part or accessory without assuming any obligation to modify any product previously manufactured.

Instructions for Obtaining Warranty Services:

Contact dealer where equipment was purchased or any other Authorized Service Dealer to arrange service at their dealership. Bring the product and your proof of purchase (sales receipt). Requests for warranty claims must be carried out through the same distribution network used to purchase the product.

dealer using original (manufacturer) replacement parts.

Owner's Responsibilities:

Any defective equipment or part must be returned to an authorized dealer within the warranty period for repairs. In the event that defective merchandise must be returned to manufacturer for repairs, the dealer must first obtain a written authorization from either KIMPEX or BERCOMAC, freight fees are prepaid prior to the shipment. This warranty extends only to equipment operated under normal conditions. To validate a warranty claim, it is the user's responsibility to maintain and service the unit as specified in the owner's manual or to have the unit serviced at their dealer at their expense.

General Conditions:

The sole liability of BERCOMAC with respect to this warranty shall be strictly and exclusively repair and replacement as mentioned herein. BERCOMAC shall not have any liability for any other costs, loss or damage, including but not limited to, any incidental or consequential loss or damage.

In particular, without being limited to, BERCOMAC shall have no liability or responsibility for:

- Travel time, overtime, after hours time or other extraordinary repair charges or relating to repairs and or replacements outside of normal business hours.
- Rental of like or similar replacement equipment during the period of any, repair or replacement work.
- Any communicating or travel charges.
- Loss or damage to person or property other than that covered by the terms of this warranty.
- Any claims for lost revenue, lost profit or any similar costs as a result of damage or repair.
- Attorney's fees.

BERCOMAC'S responsibility in respect to claims is limited to making the required repairs or replacement without charge up to our maximum labor rates and pre-established times and no claim of breach of warranty shall be cause for cancellation or rescission of the contract of sale of any product or accessory.

This warranty gives you specific legal rights. You may also have other rights, which vary from state to state.

TABLE OF CONTENTS

	PAGE
INTRODUCTION	2
SAFETY PRECAUTIONS	3
SAFETY DECALS	5
ASSEMBLY	
Step 1: Snowblower Preparation	6
Step 2: Engine Installation	8
Step 3: Vehicle Preparation	10
Step 4: Subframe Preparation	11
Step 5: Control Box Installation	14
Step 6: Final Adjustments	16
OPERATION	
Operating the Snowblower	18
Electrical Controls	18
Removing Snow	18
MAINTENANCE & DISMOUNTING	
Maintenance	19
Adjustments	19
Lubrication	19
Cutting Edge Maintenance	19
Clearing a Clogged Discharge Chute	19
Shear Bolt Replacement	19
Dismounting	19
Storage	19
BELT REPLACEMENT	20
TROUBLESHOOTING	21
TORQUE SPECIFICATION TABLE	23
PARTS BREAKDOWN AND PARTS LIST	
Rotation System with Chute	24
Subframe	26
Snowblower	28
OPTIONS	32

INTRODUCTION

TO THE PURCHASER

This new attachment was carefully designed to give years of dependable service. This manual has been provided to assist in the safe operation and servicing of your attachment.

NOTE: All photographs and illustrations in the manual may not necessarily depict the actual models or attachment, but are intended for reference only and are based on the latest product information available at the time of publication.

Familiarize yourself fully with the safety recommendations and operating procedures before putting the machine to use. Carefully read, understand and follow these recommendations and insist that they be followed by those who will use this attachment.



THIS SAFETY ALERT SYMBOL IDENTIFIES AN IMPORTANT SAFETY MESSAGE IN THIS MANUAL THAT HELPS YOU AND OTHERS AVOID PERSONAL INJURY OR EVEN DEATH. DANGER, WARNING, AND CAUTION ARE SIGNAL WORDS USED TO IDENTIFY THE LEVEL OF HAZARD. HOWEVER, REGARDLESS OF THE HAZARD, BE EXTREMELY CAREFUL.

DANGER: Signals an extreme hazard that will cause serious injury or death if recommended precautions are not followed.

WARNING: Signals a hazard that may cause serious injury or death if the recommended precautions are not followed.

CAUTION: Signals a hazard that may cause minor or moderate injury if the recommended precautions are not followed.

Record your attachment serial number and purchase date in the section reserved below (there is no serial number on the subframe). Your dealer requires this information to give you prompt, efficient service when ordering replacement parts. Use only genuine parts when replacements are required.

If warranty repairs are required please present this registration booklet and original sales invoice to your selling dealer for warranty service.

This manual should be kept for future reference.

Please check if you have received all the parts for your kit with the list of the bag and the list of the box.

SERIAL NUMBER : _____

PURCHASE DATE : _____

In this manual, right and left sides are determined by sitting on the vehicle seat facing forward.

SAFETY PRECAUTIONS

Careful operation is your best insurance against an accident. Read this section carefully before operating the vehicle and accessory. This accessory is capable of amputating hands and feet and throwing objects. Failure to observe the following safety instructions could result in serious injury. All operators, no matter how experienced they may be, should read this and other manuals related to the vehicle and accessory before operating. It is the owner's legal obligation to instruct all operators in safe operation of the accessory.

GLOSSARY:

In this manual, right and left sides are determined by sitting on the seat of the vehicle facing forward.

In this manual, "accessories" means attachments (snowblower, rotary broom, blade etc.) that you install on the vehicle (lawn tractors, A.T.V. s etc).

TRAINING:



This symbol, "Safety Alert Symbol", is used throughout this manual and on the accessory's safety labels to warn of the possibility of serious injury. Please take special care in reading and understanding the safety precautions before operating the vehicle and accessory.

1. Read this owner's manual carefully. Be thoroughly familiar with the controls and proper use of the vehicle and accessory. Know how to stop the unit and disengage the controls quickly.
2. Never allow children to operate the vehicle nor the accessory. Never allow adults to operate the vehicle nor the accessory without proper instructions.
3. No one should operate the vehicle nor the accessory while intoxicated or while taking medication that impairs the senses or reactions.
4. Keep the area of operation clear of all people, particularly small children and pets.

PREPARATION:

1. Thoroughly inspect the area where the accessory is to be used and remove door mats, all foreign objects and the like.
2. For motorized accessories, disengage all clutches and shift into neutral before starting engine.
3. Do not operate the accessory without wearing adequate winter outer garments. Avoid loose fitting clothing that can get caught in moving parts. Wear footwear that will improve footing on slippery surfaces.

4. Handle fuel with care, it is highly flammable.
 - a) Use approved fuel container.
 - b) Never add fuel to a running engine or hot engine.
 - c) Fill fuel tank outdoors with extreme care. Never fill fuel tank indoors.
 - d) Never fill containers inside a vehicle, or on a truck or a trailer bed with a plastic liner. Always place containers on the ground, away from your vehicle, before filling.
 - e) When practical, remove gas-powered equipment from the truck or trailer and refuel it on the ground. If this is not possible, then refuel such equipment on a trailer with a portable container, rather than from a gasoline dispenser nozzle.
 - f) Keep the nozzle in contact with the rim of the fuel tank or container opening at all times, until refueling is complete. Do not use a nozzle lock-open device.
 - g) Replace fuel cap securely and wipe up spilled fuel.
 - h) If fuel is spilled on clothing, change clothing immediately.
5. Never attempt to make any adjustments while the engine (motor) is running (except when specifically recommended by manufacturer).
6. Let the vehicle and accessory adjust to outdoor temperatures before starting to clear snow.
7. Always wear safety glasses or eye shields during operation or while performing an adjustment or repairs to protect the eyes from foreign objects that may be thrown from the accessory.
8. **Never modify the accessory or any part without the written consent from the manufacturer.**

SAFETY PRECAUTIONS

OPERATION:

1. Do not put hands or feet near, under or inside rotating parts.
2. Exercise extreme caution when operating on or crossing gravel drives, walks or roads. Stay alert for hidden hazards or traffic. Do not carry passengers.
3. After striking a foreign object, stop the engine (motor), disconnect the wire from the spark plug(s) and keep wire away to prevent accidental starting. Thoroughly inspect the accessory for any damage and repair damage before restarting and using the accessory.
4. If the unit should start to vibrate abnormally, stop the engine (motor) and check immediately for the cause. Vibration is generally a warning of trouble.
5. Take all possible precautions when leaving the vehicle unattended. Disengage the power take-off, lower the attachment, place the transmission into neutral, set the parking brake, stop the engine and remove the contact key.
6. Do not run the engine indoors, except when starting the engine and for transporting in or out of the building. Do not operate or let motor run in a storage area without ventilation because gas contains carbon monoxide which is odorless, colorless and can cause death.
7. Never clean across the face of slopes, go from top to bottom. Exercise extreme caution when using equipment on slopes. Do not attempt to clear a steep slope.
8. Never use an accessory without proper guards, plates, or other safety protective devices in place
9. Never tolerate bystanders in the working zone. Never use an accessory in the direction of bystanders, it might throw gravel or debris that can hurt people or damage property.
10. Never operate the accessory at high transport speeds on slippery surfaces. Use care when backing up.
11. Do not carry passengers.
12. Disengage power to the accessory when it is transported or not in use.

13. Never operate the accessory without good visibility or light.
14. Keep the accessory away from heat sources or flames.
15. Always wear a dust mask when working in a dusty environment.

MAINTENANCE AND STORAGE

1. When cleaning, repairing or inspecting the vehicle and accessory, make certain that all moving parts have stopped. Disconnect wire from the spark plug (s) and keep wire away to prevent accidental starting.
2. Check all the bolts at frequent intervals to make sure that they are properly tightened .
3. Never store a motorized accessory with fuel in the fuel tank inside a building where ignition sources are present such as hot water and space heaters, clothes dryers, and the like. Allow the engine to cool before storing in any enclosure.
4. Always refer to the owner's manual when you store the accessory and vehicle for a prolonged or an unspecified length of time.
5. Maintain or replace safety and instruction labels, as necessary.
6. For winter accessories, (if applicable), let the engine run for a few minutes after clean snow in order to prevent the rotary parts from freezing.
7. Inspect the vehicle's and accessory's air filter every day. Clean it or replace it as necessary. Change the oil more often when working in dusty conditions. See the vehicle's and accessory's owner's manual.

WHENEVER YOU SEE THIS SYMBOL



**IT MEANS:
WARNING!
BECOME ALERT !
YOUR SAFETY IS INVOLVED!**

SAFETY DECALS

REPLACE IF DECALS ARE DAMAGED
SEE PARTS BREAKDOWN FOR DECAL LOCATION



Decal # 102125



Decal # 102126



Decal # 102128



Decal # 102127

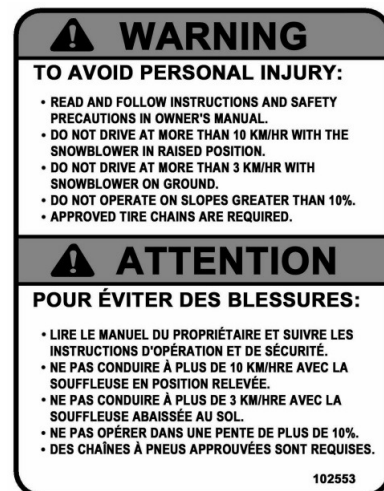

Decal # 102553

ASSEMBLY

IMPORTANT: TORQUE ALL BOLTS ACCORDING TO TORQUE SPECIFICATION TABLE (SEE TABLE OF CONTENTS) WHEN STATED: TIGHTEN FIRMLY. REFER TO PARTS BREAKDOWN SECTION FOR PART IDENTIFICATION.

STEP 1 **SNOWBLOWER PREPARATION:**

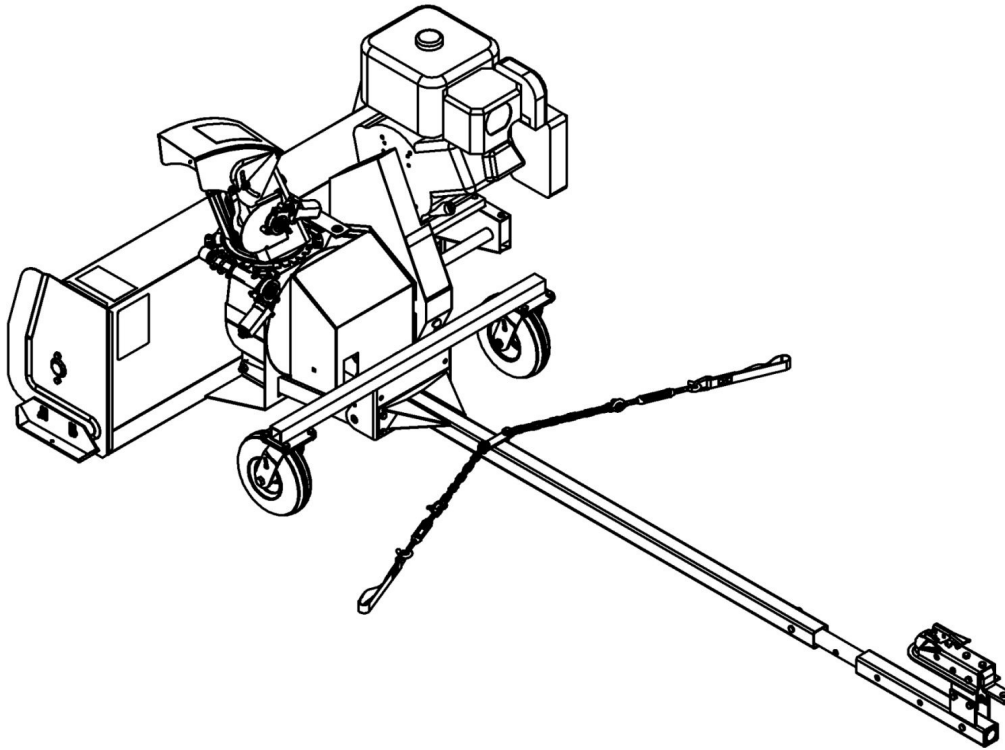

Overall view of snowblower

Place the rotation ring (item 1) on top of the snowblower (item 2) as shown.

Only one position provides a perfect fit.

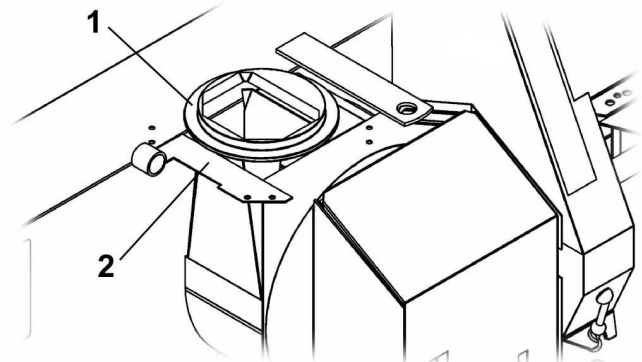

Install rotation ring

ASSEMBLY

Grease the end of the rotation worm of the motor assembly (item 1).

Insert the bushing (item 2) on the end of the rotation worm as shown.

Insert the motor assembly in the sleeve (item 3).

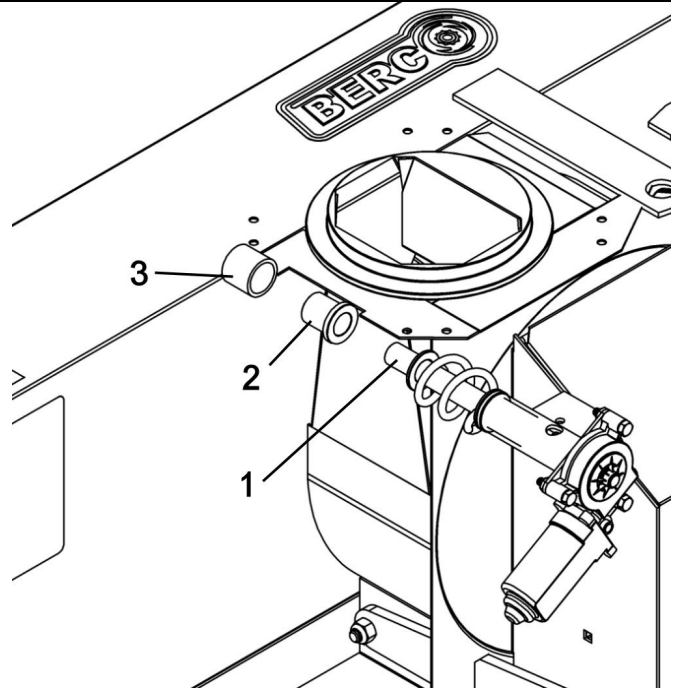

Install the motor assembly

Apply grease on the rotation ring (item 1).

Install the chute assembly (item 2) with four retaining plates (item 3) as shown.

On the rear left hand corner, secure a retaining plate (item 3) on top and the motor assembly support (item 4) underneath with two 1/4 x 3/4" bolts (item 5) and flange nuts as shown.

Secure the other three retaining plates (item 3) with six 1/4 x 1/2" bolts (item 6) and flange nuts.

Tighten the bolts firmly.

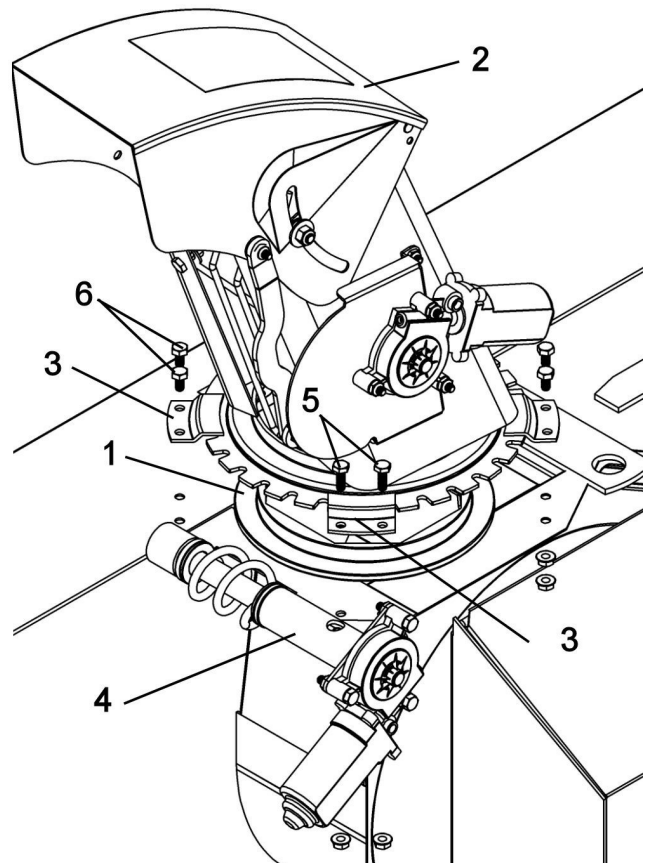

Install chute

ASSEMBLY

STEP 2

ENGINE INSTALLATION:

NOTE: THE RIGHT INSTALLATION OF THE ENGINE IS CRUCIAL TO THE GOOD WORKING ORDER OF THE SNOWBLOWER.

NOTE: Figures 1 and 2 show an engine that is not well positioned.

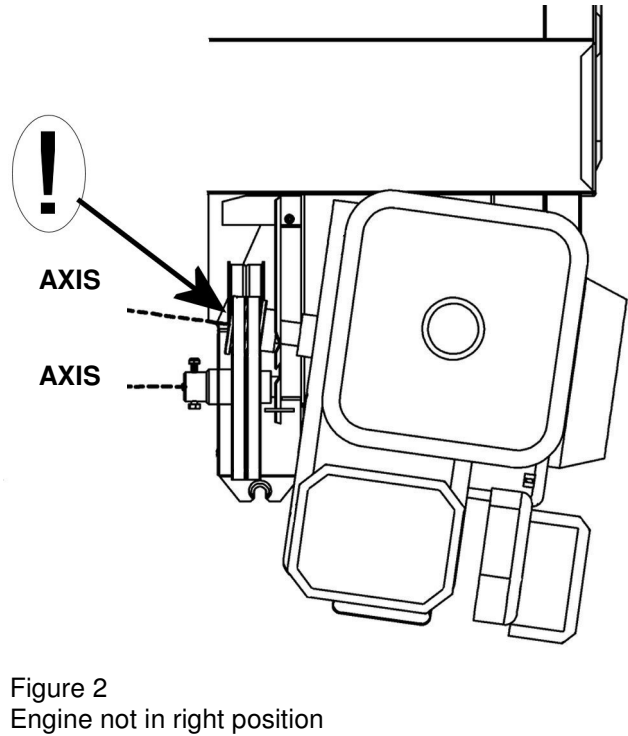
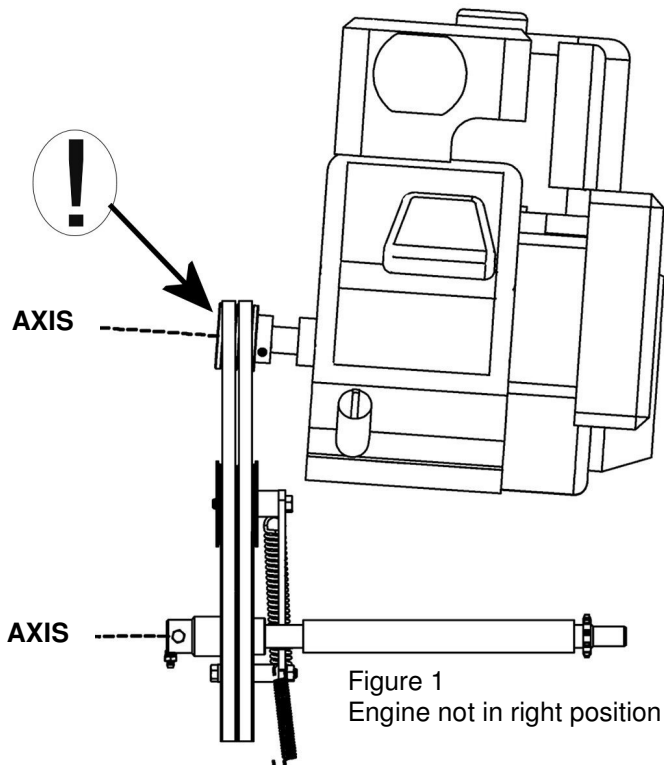

IMPORTANT: We recommend using a 13 H.P. motor on this snowblower.
DO NOT USE A MOTOR THAT EXCEEDS 13 HP, THE PULLEYS AND BELTS ARE CALIBRATED FOR A 13 HP MOTOR.

ENGINE INSTALLATION, (HONDA, BRIGGS & STRATTON OR TECUMSEH) 13 HP

Remove the belt guard (item 1)
Install the engine on the stand, using the holes identified as item A.

Secure with four 3/8 x 1 1/2" bolts, two flat washers (over the slot) and nuts.

NOTE: Make sure the side of the base of the engine is parallel with the snowblower's body.

Tighten the bolts firmly.

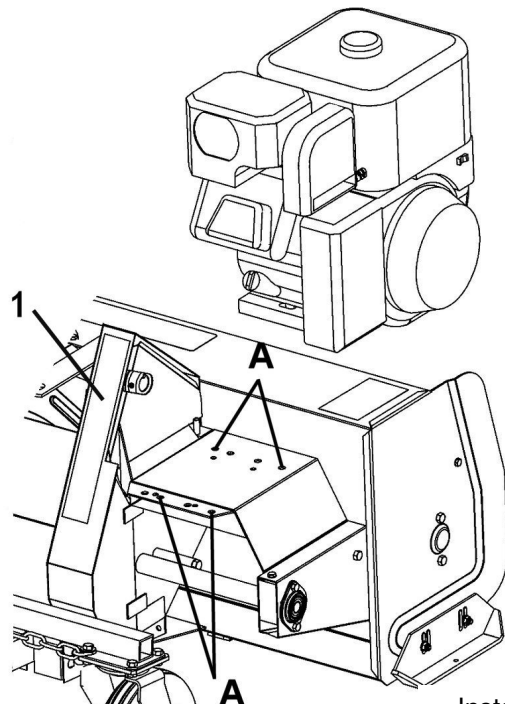

Install engine

ASSEMBLY

INSTALLATION OF OTHER BRANDS OF ENGINES:

Place the engine on a table. Measure the height (item B) from the middle of the crank shaft to the table.

Use one of the two shims (3/4" or 1") if required, to attain the height of 5.25". If more or less height is needed, use a couple of flat washers.

Install the engine and shims on the stand. Choose the set of holes that correspond with the holes at the base of the engine.

The center of the crank shaft must be 5.75" from the back of the snowblower.

Make sure that the base of the motor is parallel with the snowblower frame.

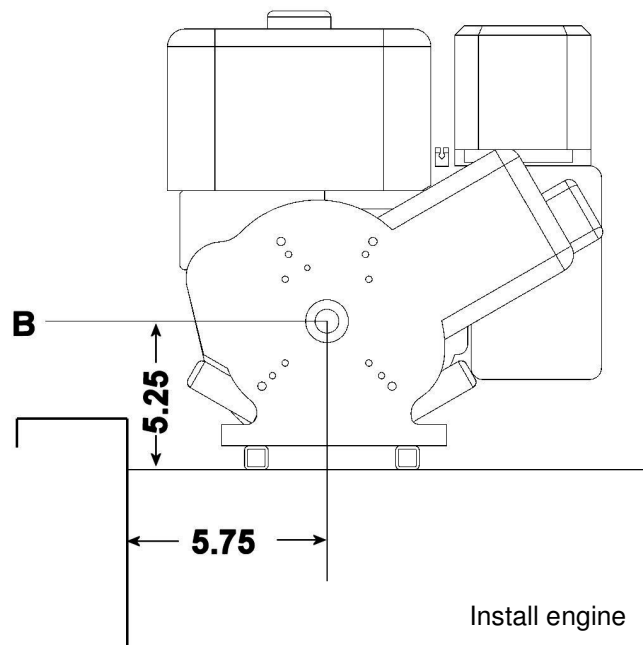

Install the 2 1/2" pulley (item 2) on the motor shaft as shown (hub towards the engine) with a 1/4" x 1/4" x 1 3/4" key.

After positioning the engine, the axis must be parallel as shown in figures 1 and 2 (hold a ruler (A) on the double pulley (item 3)).

(Use some shims if necessary).

NOTE: It is very important that the pulleys are aligned (as shown in the two views: back view of the snowblower (fig. 1) and the top view of the snowblower (fig. 2). No adjustments can be made on the bottom pulley (fig. 1, item 3).

Tighten the set screw firmly.

Figure 1
Back view of
snowblower

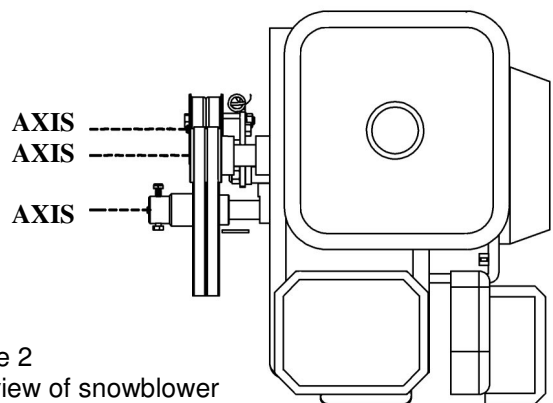
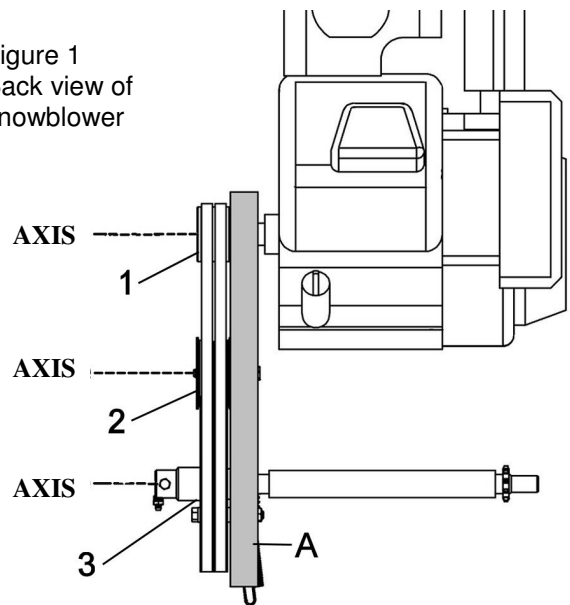

Figure 2
Top view of snowblower

ASSEMBLY

Install the belts on the snowblower pulleys as shown.

IMPORTANT:

Make sure that each strand of the belts are inside the pins that are used as belt guides (item 4).

NOTE: The adjustment with the tension on the belts will be done in Step 6.

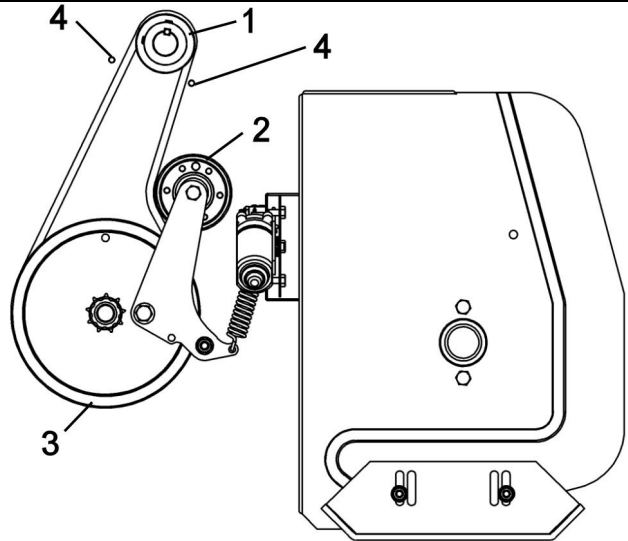

Install the belts

STEP 3

VEHICLE PREPARATION:

NOTE: A 1 7/8" tow hitch ball is required.

Remove the nut from the suspension arm (item 1) on the vehicle and install the bracket (item 2). Secure loosely with the original nut. Do the same for the other side.

If you can not install the brackets on your vehicle, install the lift strap (item 3) by looping it around the suspension arm (as shown) on the vehicle.

Tighten the loop firmly.

Do the same for the other side.

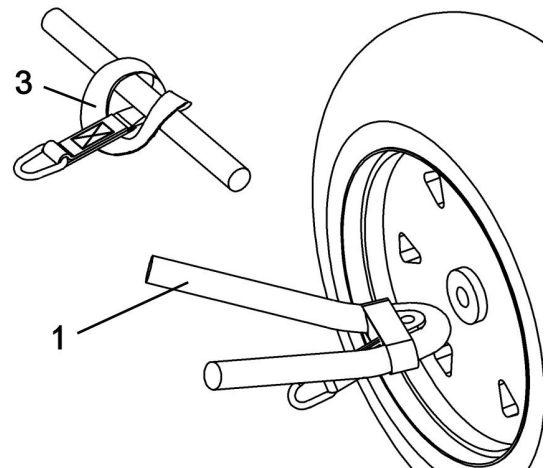
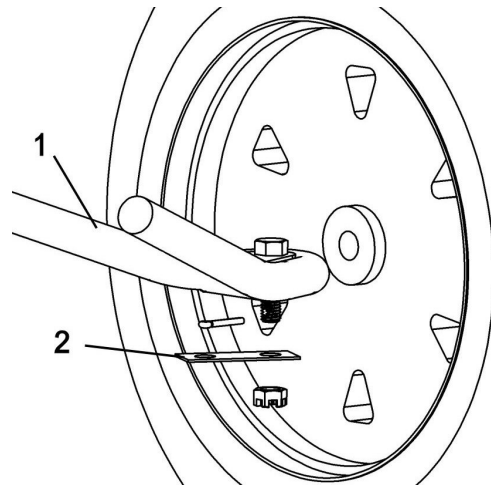

Install the brackets or the straps

ASSEMBLY

STEP 4

SUBFRAME PREPARATION:

Determine according to the height of the vehicle which set of holes to use to assemble the wheel support (item 1) to the subframe (item 2). The subframe must be parallel with the ground when the subframe is installed under the vehicle.

Install the wheel support (item 1) to the subframe (item 2) by using four 3/8" x 1" hex. bolts (item 3), four lock washers (item 4) and four hex nuts (item 5).

Tighten the bolts firmly.

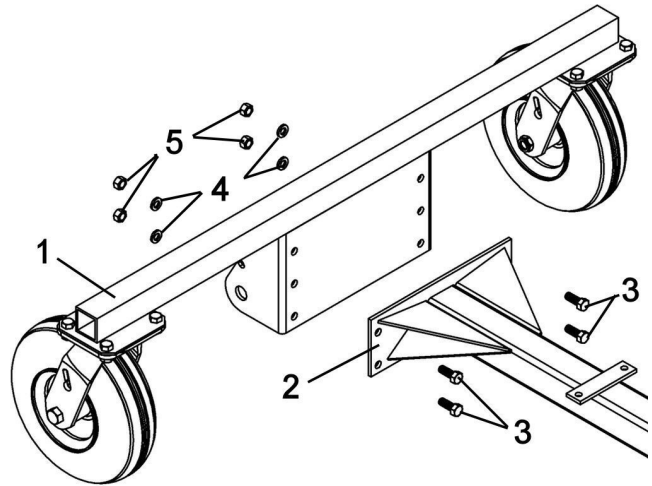

Install the wheel support to the subframe

Install the assembled turnbuckles (item 1) on the subframe (item 2). Secure with two 5/16" x 1" hex bolts (item 3), two 3/8" flat washers (item 4) and two nylon insert lock nuts (item 5).

Tighten loosely enough to allow the parts to move freely.

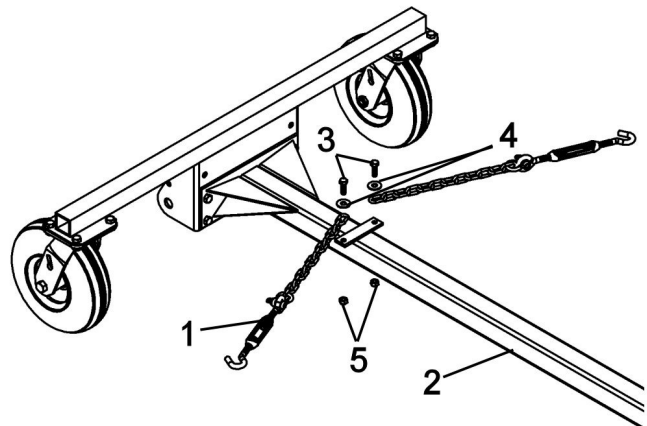

Install the assembled turnbuckles

Install the snowblower hitch (item 1) to the wheel support (item 2) with the pin (item 3). Make sure the pin is in the locked position. Secure with the 4mm hair pin (item 4).

Tighten firmly.

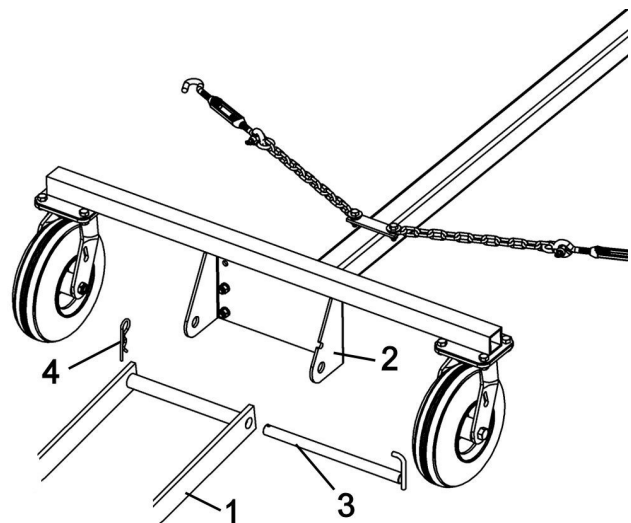

Install snowblower hitch

ASSEMBLY

You have nine different positions on the subframe extension (item 1) (the extension can be inverted) to adjust the length of the subframe.

To choose the right adjustment, insert the subframe extension (item 1) into the subframe (item 2) and insert the hitch support (item 3) on the subframe extension.

Do not secure.

Turn the hitch support to the side to facilitate installation.

Drive the vehicle over the subframe, make sure the caster wheels do not touch the front wheels on the vehicle.

Identify the right length and secure in place with a pin (item 4) and 3mm hair pin (item 5).

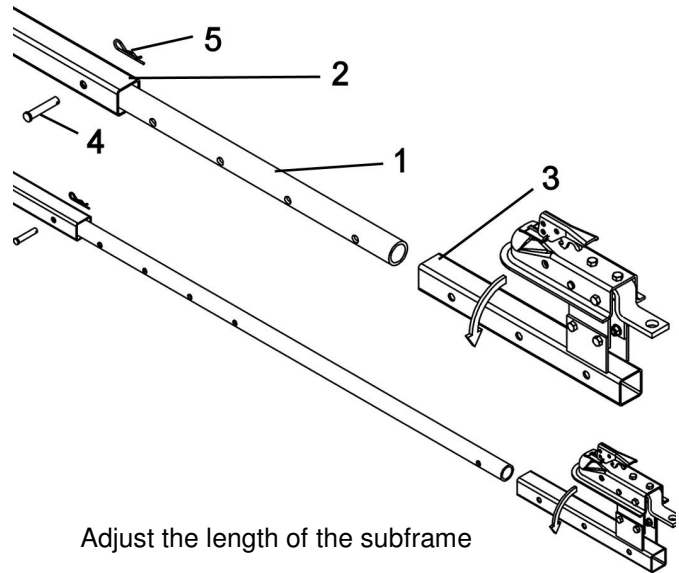

Choose between the three positions (see figure), the height of the hitch support.

There must be a maximum of ground clearance according to your vehicle.

Assemble the hitch support (items 1 & 2) with four 3/8" x 3/4" hex. bolts (item 3) and flange nuts (two on each side) if applicable (Figure A does not have the hitch supports (item 1)).

Install the hitch (item 4) with a 3/8" x 3" hex bolt (item 5) and nylon insert lock nut.

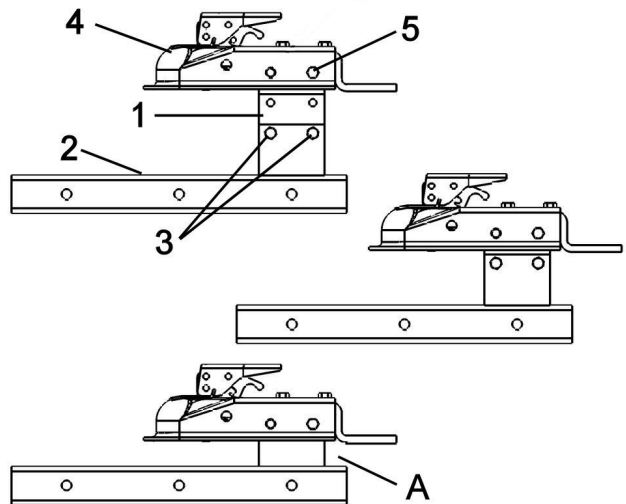

Assemble the hitch support

Insert the assembled hitch support (item 1) onto the subframe extension (item 2). Secure in place with the pin (item 3) and the 3mm hair pin (item 4). **NOTE:** The hitch support has three sets of holes to increase the length of the subframe if necessary.

Attach the hitch assembly on the tow hitch ball of the vehicle.

Insert the pin (item 5) and secure with a 3 mm hair pin (item 6). Make sure the subframe does not come into contact with vehicle at any time.

NOTE: You can turn the hitch assembly (item 1) to facilitate displacing the vehicle over the subframe by removing the pin (item 3).

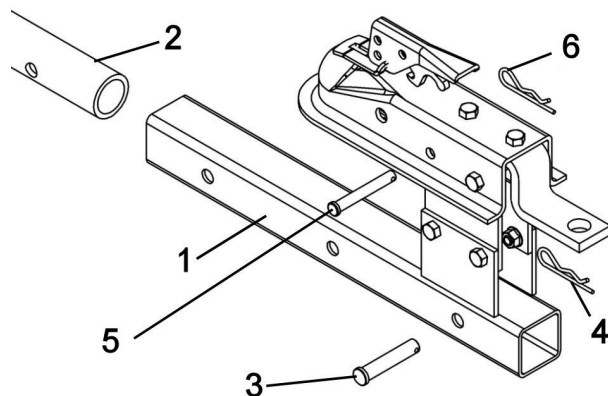

Secure the hitch support on the tow hitch ball

ASSEMBLY

Hook the turnbuckles (item 1) into the brackets (item 2) or into the lift straps (item 3) and adjust them so the subframe is centered under the vehicle.

IMPORTANT:

After adjusting the turnbuckles, tighten the nuts on the vehicle's wheel supports firmly.

Make sure to lock the nuts with the original locks.

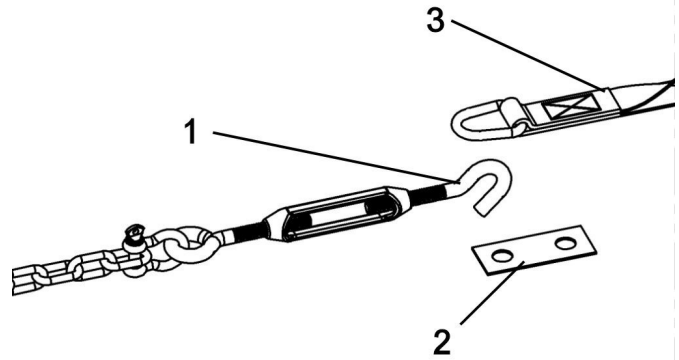

Hook the turnbuckles or the straps

Insert the hook of the winch (item 1) into the flat bar welded on the top of the snowblower.

NOTE: Optional kit #700269 Lift connection kit can be used to reduce the effort required by the winch to lift the accessory.

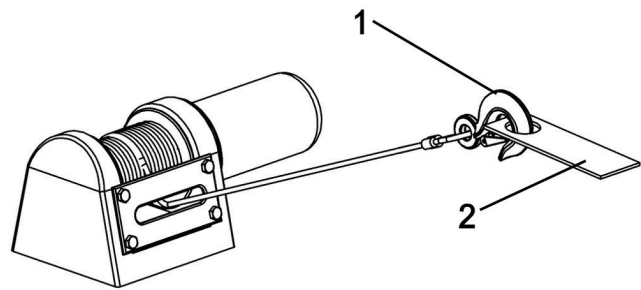

Install the winch cable

ASSEMBLY

STEP 5 CONTROL BOX INSTALLATION:

Choose between the three different ways of securing the control box support (item 1).

Insert the control box (item 2) in the support.

Connect the connectors of the wire on the control box to the three corresponding electric motors (the motor for the chute, for the deflector and for the belt tensioner).

Make sure the connectors are well connected together.

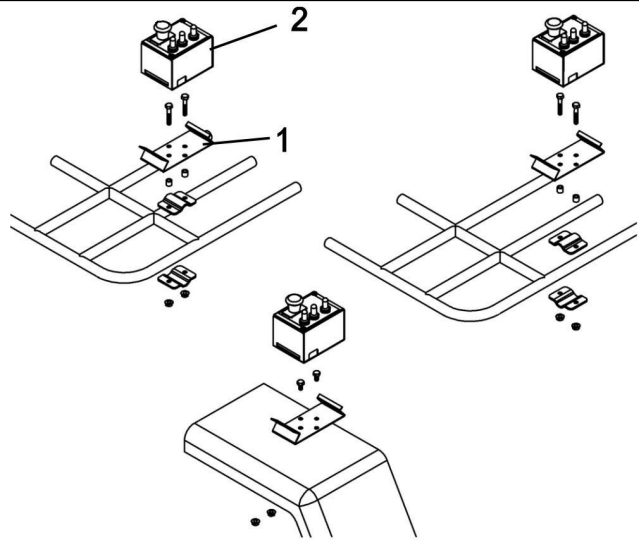

Install the control box

Install an engine circuit breaker: find the wire (item 1) that supplies the engine's booster coil and disconnect it.

Assemble the connectors (items 2 & 5) of the control box into the engine connectors (items 3 & 4) as shown.

IMPORTANT: the control box is equipped with a red emergency switch*. Push down on this button if it becomes necessary to stop the engine quickly.

*Which is relayed to the connectors (items 2 & 5).

NOTE: The emergency switch must be pulled out to start the engine of the snowblower.

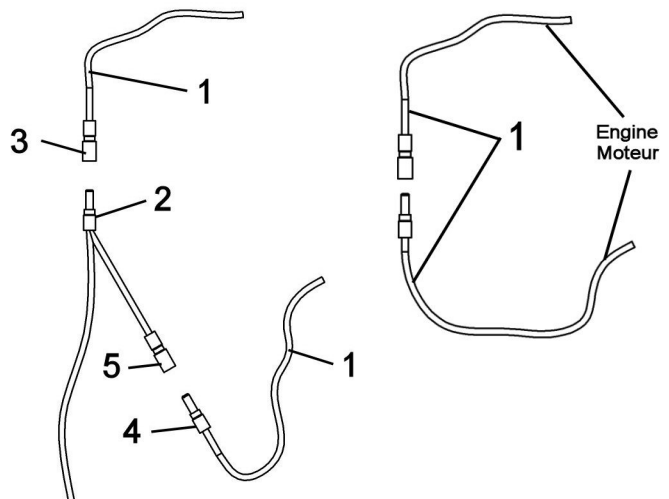

Install a circuit breaker for the engine

Connect the red wire to the vehicle's positive battery post (item 1) and the black wire to the negative battery post (item 2).

Tie the wires to the vehicle with the nylon tie wraps.

NOTE: These wires will stay attached to the vehicle.

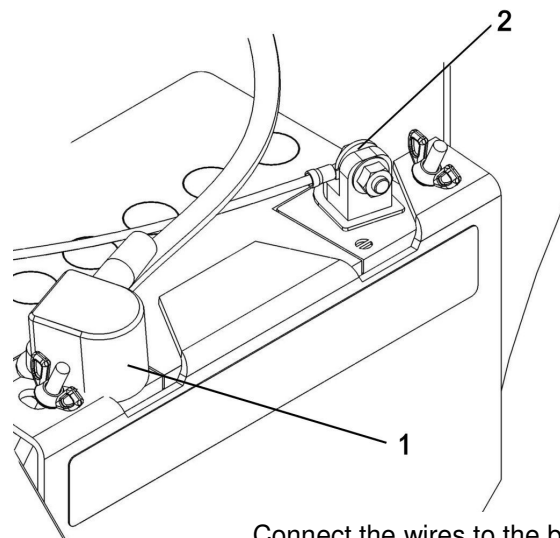

Connect the wires to the battery

ASSEMBLY

IMPORTANT:

Take the time to familiarize yourself with the location of the switches and with their use.

NOTE: If the switches don't match the right controls, reconnect the connectors with the right motors.

Pay particular attention to the switch for the belt tensioner (item 4).

This switch must be held in position for a few seconds in order to activate or deactivate the motor of the belt tensioner.

Make sure that the pulley is well seated onto the belts. If the pulley is not well positioned, the belts will wear out prematurely.

Identification of the switches:

1. Emergency switch. (**Pull out to start**)
2. Switch for the chute
3. Switch for the deflector
4. Switch for the belt tensioner.

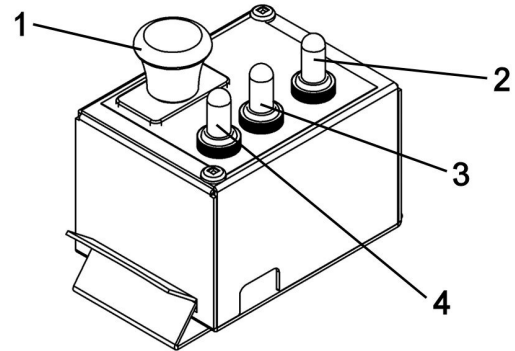

Identify the controls.

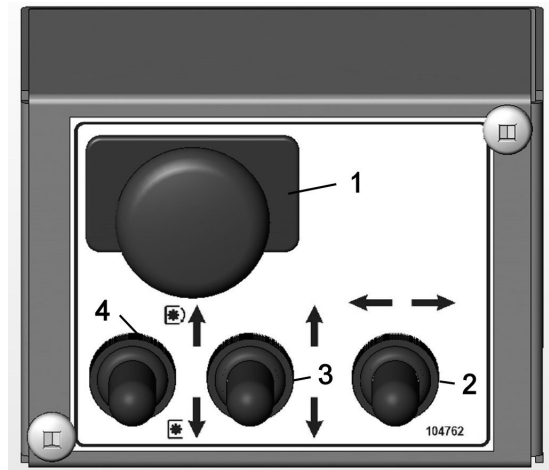

Turn the chute to its maximum towards the right.

Secure the two wires of the deflector motor with a tie wrap (item 1) around the motor.

Tie the wires with another tie wrap in the hole at the base of the deflector as shown.

Secure the four wires on the rotation motor with a tie wrap (item 2).

Be sure to leave enough wire length to be able to turn the chute.

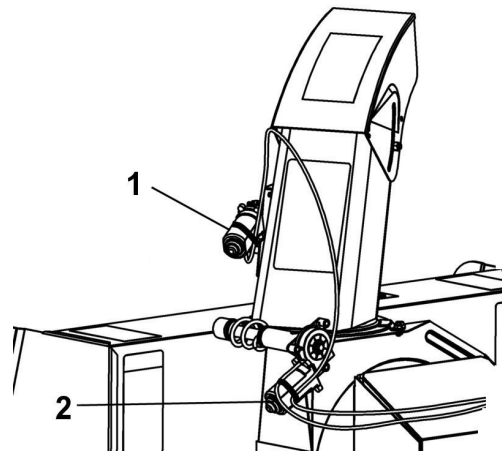

Secure wires on the motors

ASSEMBLY

STEP 6 FINAL ADJUSTMENTS

Adjust the idler pulley (item 2) as follows:

After installing the belts, you may run the engine without the belt guard but only for the time needed to verify the belt alignment. Do not leave the snowblower without supervision. **Neither you or anyone must approach the moving parts.**

Engage and disengage the snowblower to make sure that the belts are well aligned, especially on the idler pulley.

If necessary, you can add or remove a flat washer for final adjustment on the idler pulley (item 2).

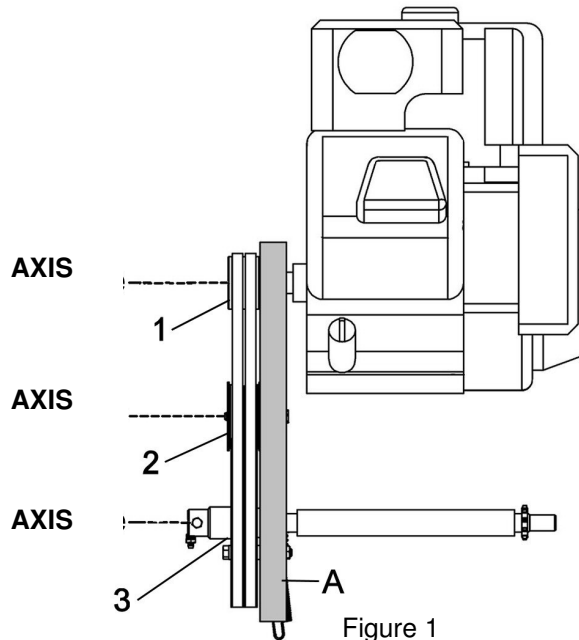

Figure 1
Back view of snowblower



DANGER



Never let the snowblower motor run without the belt guard & belt guide stopper in place.



WARNING



TO PREVENT INJURIES:

Start the engine, engage and disengage the clutch to be sure it functions normally.

Make sure the emergency switch is working perfectly. Make sure all the controls are working well.

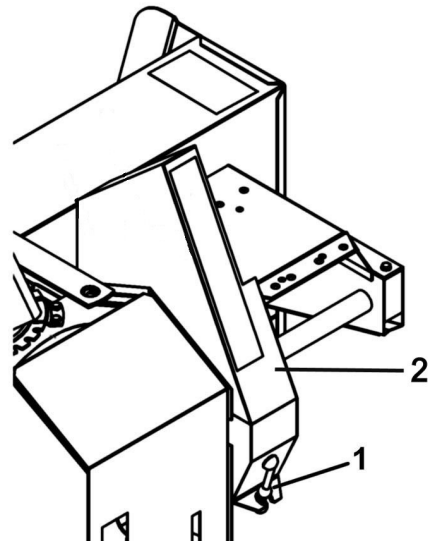

Install the belt guard (item 2) and secure in place with the rubber latch (item 1).

Install belt guard

ASSEMBLY

VERIFY SKID SHOE ADJUSTMENT:

LEVEL PAVED SURFACE: Adjust skid shoes to allow 3/16" to 1/4" clearance (A) between cutting edge and surface.

UNEVEN OR GRAVEL SURFACE: Adjust skid shoes to allow 1/2" to 5/8" clearance (A) between cutting edge and surface.

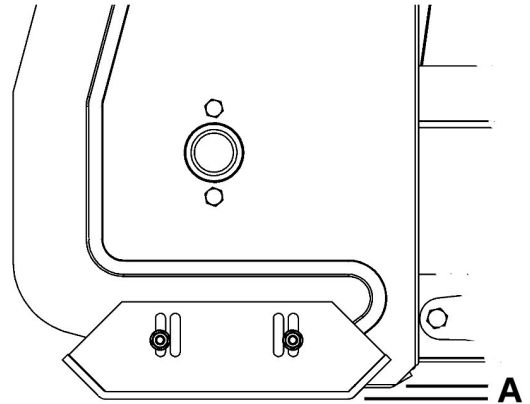

Adjust skid shoes

Install the engine protector (item 1) on the snowblower (item 2) as shown.

Hold in place with vice grips. Using the engine protector as a template, drill five 9/32" holes in the snowblower frame.

Secure in place with five 1/4 x 1/2" hex bolts (item 3) and flange nuts. Tighten firmly.

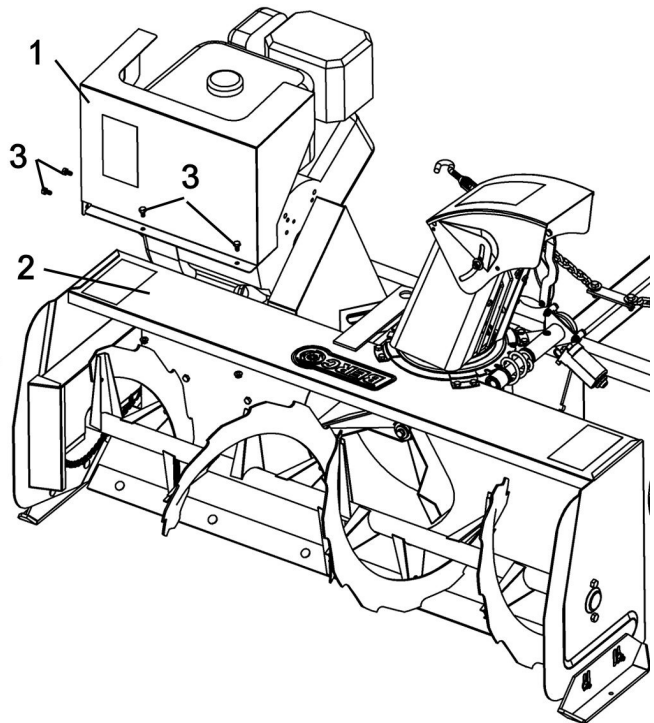

OPERATION



WARNING



Read the vehicle's owner's manual carefully. Be thoroughly familiar with the controls & proper use of the attachment. Know how to stop the unit & disengage the controls quickly.



WARNING



- Do not attempt to clear plugged chute, auger or fan of snow while the snowblower's engine is running.
- Disengage snowblower.
- Lower snowblower onto ground.
- Set the parking brake.
- Stop engine, remove the ignition key, disconnect the wire from spark plug(s) and keep away from spark plug(s) to prevent accidental starting.
- Make sure all moving parts have stopped.
- Do not use hand to unplug chute.
- Use a 36" (924 mm.) minimum length stick or board.



WARNING



TO PREVENT INJURIES AND FOR MORE TRACTION WHEN USING SNOWBLOWER:

- Do not drive faster than 3 km/hr (2 m/hr) with snowblower on the ground.
- Do not drive faster than 10 km/hr (6 m/hr) with the snowblower in raised position.
- Do not operate on a slope greater than 10°.
- Vehicle manufacturer approved tire chains are required.

REMOVING SNOW

When removing snow, do not use the snowblower as a dozer blade to push snow. Allow snowblower to ingest snow at its own speed. If the speed of your A.T.V. is too fast, the snowblower may become overloaded and plug. For best results, raise the snowblower and remove a top layer of snow. A second pass with the snowblower will remove the remaining snow.

OPERATING THE SNOWBLOWER

- a) Make sure the snowblower is clear of snow before engaging the clutch.
- b) Make sure that the auger and impeller operate freely.
- c) Start the snowblower engine.
- d) Before engaging the snowblower drive, always have the engine running at max R.P.M.
- e) Operate the snowblower at maximum engine R.P.M.

IMPORTANT: USE FULL ENGINE R.P.M. WHEN REMOVING WET, STICKY SNOW. LOW R.P.M. POWER WILL TEND TO PLUG THE CHUTE.

ELECTRICAL CONTROLS

See installation of the control box in order to identify the controls.

RAISING AND LOWERING THE SNOWBLOWER:

Use the winch switch control to raise and lower the snowblower.

IMPORTANT: There is no lift stopper. Make sure there is no interference between the snowblower engine and the vehicle when lifting the snow blower.

EMERGENCY SWITCH:

Push down on the emergency button to stop the engine.

IMPORTANT: The emergency button has to be pulled out in order to start the snowblower engine.

MAINTENANCE & DISMOUNTING



WARNING



TO PREVENT INJURIES:

Stop the snowblower motor.
Apply parking brakes.
Remove the ignition key.
Disconnect the wire from the spark plug(s) and keep away from spark plug(s) to prevent accidental starting.

MAINTENANCE

- Check mounting bolts at frequent intervals for proper tightness in order to prevent costly repairs. Make sure your snowblower is in safe working condition.
- Provide adequate blocking before working under the snowblower when in raised position.

ADJUSTMENTS

SKID SHOE ADJUSTMENT:

Level Paved Surface: Adjust skid shoes to allow 3/16" to 1/4" clearance between cutting edge and surface.

Uneven or Gravel Surface: Adjust skid shoes to allow 1/2" to 5/8" clearance between cutting edge and surface.

LUBRICATION

Grease the wheel axles, the fork pivots and the hub on the double pulleys after every 4 hours of use.

Apply oil at all pivot points.

Drive Chains: Lubricate with chain saw chain lubricant every four hours of operation and at the end of each operation.

Chute Rotation System: Oil chute base, rotation worm every eight hours of operation.

CUTTING EDGE MAINTENANCE

Verify from time to time the wearing on the cutting edge to make sure you do not wear out the base of the snowblower's chassis. This cutting edge is reversible. All you have to do is unscrew the bolts and turn the cutting edge, reinstall and tighten the bolts securely.

CLEARING A CLOGGED DISCHARGE CHUTE:

Hand contact with the rotating impeller inside the discharge chute is the most common cause of injury associated with snowblowers. Never use your hand to clean out the discharge chute.

To clear the chute:

- Lower snowblower to the ground and set parking brake.
- SHUT THE ENGINE OFF & REMOVE KEY!
- Wait 10 seconds to be sure the **all moving parts** such as the impeller blades have stopped moving.
- Disconnect wire from the spark plug(s) and keep wire away to prevent accidental starting.
- Always use a clean-out tool of at least 36" in length, NOT YOUR HANDS.

SHEAR BOLT REPLACEMENT

The shear bolt is to be considered a preventive measure and not an assured protection. Operator vigilance is required. Thoroughly inspect the areas where the snowblower is to be used and remove all foreign objects.

Auger Shear Bolt Replacement:

The auger is protected by a shear bolt with two grooves. If you hit a foreign object or ice, the shear bolt is designed to break upon absorbing impact. The auger will stop turning. This is to avoid damage to the auger or the snowblower. Replace only with original parts. The use of any other bolt may void the warranty.

DISMOUNTING

- Select a level surface, set parking brake, stop the engine, and remove the ignition key to prevent accidental starting.
- Lower the accessory to the ground
- Unhook the turnbuckles from the front of the vehicle, (Tip: slacken one of the turnbuckles in order to keep the adjustment), the hook from the winch and the hitch from the rear of the vehicle.
- Remove the control box (item 1) from the support (item 2). Disconnect the wires (item 3) and place the box on the accessory.
- Remove the vehicle.

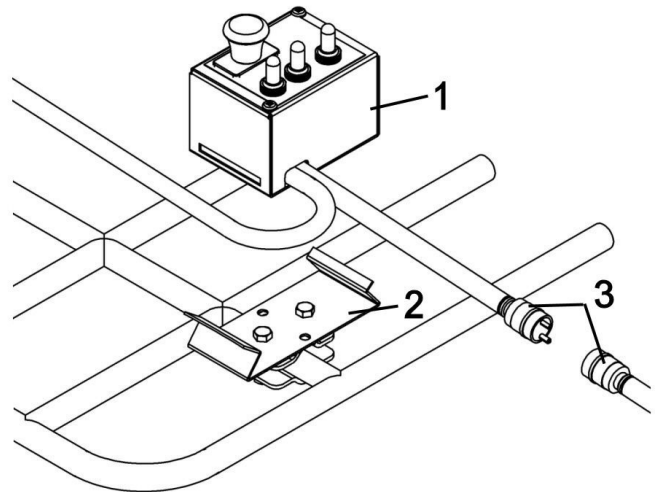

STORAGE

- Clean snowblower and subframe thoroughly and repaint all parts from which paint has worn.
- List the replacement parts that will be needed to be replaced before the next season.
- Follow the instructions in the Lubrication section.
- Concerning the snowblower engine, follow the instructions in the engine owner's manual.
- Store the snowblower and the subframe in a dry place.

BELT REPLACEMENT



CAUTION



Never use the snowblower without the belt guard.

BELT REPLACEMENT:

For belt part numbers, refer to parts breakdown section for parts identification.

- a) Remove the belt guard.
- b) Remove the auger shear bolt.
- c) Remove the chain guard.
- d) Unlink the chain by removing the connecting link and take off the chain.
- e) Remove the auger drive shaft assembly.
- f) Remove the old V-belts and install the new V-belts.
- g) Reinstall the auger shear bolt.
- h) Reinstall the drive shaft and secure in place.

IMPORTANT: Install the drive shaft and shear bolt in first, to make sure that the parts are in their proper locations.

- i) Reinstall the roller chain with the connecting link.
- j) Reinstall the chain guard.
- k) After installing the belts, make sure the belts are inside the pins (item 4). You may run the engine without the belt guard but only to verify the belt alignment. Do not leave the snowblower without supervision. Neither you or anyone else must approach the moving parts. Engage and disengage the snowblower to verify if the belts are well aligned, especially on the idler pulley. **Make sure to hold the switch long enough so that the pulley sits well on the belts.** If necessary, you can add or remove a flat washer on the idler pulley for final adjustments.
- l) Reinstall the belt guard.

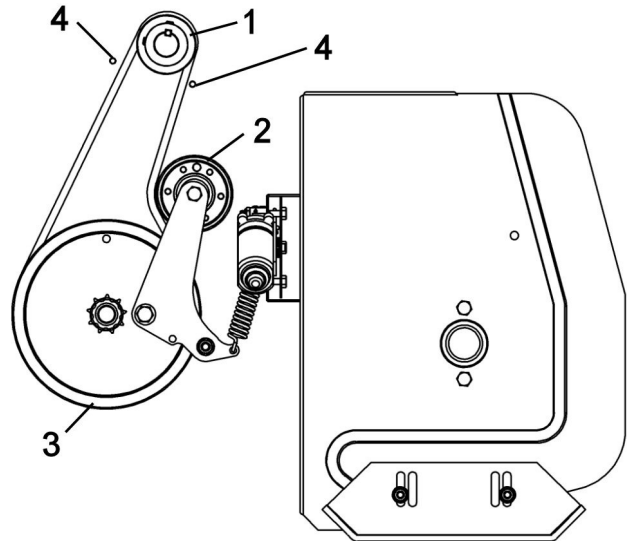

Belt replacement

TROUBLESHOOTING

(For identification, see the parts breakdown)

PROBLEM	POSSIBLE CAUSES	CORRECTIVE ACTION
Snowblower is noisy. NOTE: Please note this snowblower may appear to be noisy.	New chain and new sprocket.	Lubricate the roller chain. NOTE: When snowblower is new it is louder, the noise will decrease over time.
Snowblower vibrates or is abnormally noisy.	Damaged pulley.	Replace pulley.
	Damaged bearing.	Replace bearing.
	Damaged fan.	Dismount & repair or replace fan.
	Auger bent.	Replace auger.
Auger stopped turning.	Shear bolt broken.	Replace shear bolt. Also see "Maintenance" section.
	Chain broken or connecting link unlocked.	Remove chain guard. Inspect and repair if needed.
Snowblower stopped turning.	The belts are damaged or snapped.	Check & replace damaged belts.
Belt is worn at a specific point.	Snowblower was engaged when already plugged.	Make sure auger & fan are not plugged or frozen before engaging snowblower.
	Lack of tension on the belt.	Replace the tension spring if it has lost its efficiency.
Belt showing premature wear.	Spring stretched.	Check spring. Replace if stretched.
	Engine is misaligned	Realign the engine.
Chute rotation is difficult.	Dirt or ice may be underneath chute.	Clean the base of chute & the rotation ring. Lubricate chute inside & out and the rotation worm.
	The base of the chute may be damaged or bent.	Clean parts, lubricate & reinstall. Make sure the retaining plates are not too tight on the chute base, it may be a reason why the chute is not turning freely.

TROUBLESHOOTING

(For identification, see the parts breakdown)

PROBLEM	POSSIBLE CAUSES	CORRECTIVE ACTION
The chute plugs easily.	Snowblower engine is turning too slowly.	Always have engine at full R.P.M. when using the snowblower.
	Advancing too quickly with vehicle.	Reduce speed. Allow snowblower to ingest snow at its own speed.
Snowblower digs into ground.	Ground is not frozen or too soft.	Adjust skid shoes lower so they may better support the snowblower.
Snowblower does not raise evenly.	Tire pressure uneven from one side to another.	Verify and adjust tire pressure: 50 p.s.i.
The engine does not start	The emergency button is pushed down.	The emergency button must be pulled up to start the engine of the snowblower.
	Other reasons	See the engine's owner's manual.
Electric motor does not work	Overheating of the motor	These motors are equipped with an internal protector. Wait 10 minutes before using.

TORQUE SPECIFICATION TABLE

GENERAL TORQUE SPECIFICATION TABLE USE THE FOLLOWING TORQUES WHEN SPECIAL TORQUES ARE NOT GIVEN

NOTE: These values apply to fasteners as received from supplier, dry or when lubricated with normal oil. They do not apply if special graphited or moly disulphide greases or other extreme pressure lubricants are used. This applies to both UNF and UNC threads.

SEE Grade No.		2				5				8 *			
BOLT HEAD IDENTIFICATION MARKS AS PER GRADE NOTE MANUFACTURING MARKS WILL VARY		TORQUE				TORQUE				TORQUE			
BOLT SIZE		POUNDS FEET		NEWTON-METERS		POUNDS FEET		NEWTON-METERS		POUNDS FEET		NEWTON-METERS	
Inches	Millimetre	Min.	Max.	Min.	Max.	Min.	Max.	Min.	Max.	Min.	Max.	Min.	Max.
1/4"	6.35	5	6	6.8	8.13	9	11	12.2	14.9	12	15	16.3	30.3
5/16"	7.94	10	12	13.6	16.3	17	20.5	23.1	27.8	24	29	32.5	39.3
3/8"	9.53	20	23	27.1	31.2	35	42	47.5	57	45	54	61	73.2
7/16"	11.11	30	35	40.7	47.4	54	64	73.2	86.8	70	84	94.9	113.9
1/2"	12.7	45	52	61	70.5	80	96	108.5	130.2	110	132	149.2	179
9/16"	14.29	65	75	88.1	101.6	110	132	149.2	179	160	192	217	260.4
5/8"	15.88	95	105	128.7	142.3	150	180	203.4	244.1	220	264	298.3	358
3/4"	19.05	150	185	203.3	250.7	270	324	366.1	439.3	380	456	515.3	618.3
7/8"	22.23	160	200	216.8	271	400	480	542.4	650.9	600	720	813.6	976.3
1"	25.4	250	300	338.8	406.5	580	696	786.5	943.8	900	1080	1220.4	1464.5

*Thick nuts must be used with grade 8 bolts

METRIC BOLT TORQUE SPECIFICATIONS							
Size Screw	Grade No.	COARSE THREAD			FINE THREAD		
		Pitch (mm)	Pounds Feet	Newton-Meters	Pitch (mm)	Pounds Feet	Newton-Meters
M6	4T	1.00	3.6 - 5.8	4.9 - 7.9	-	-	-
	7T		5.8 - 9.4	7.9 - 12.7		-	-
	8T		7.2 - 10	9.8 - 13.6		-	-
M8	4T	1.25	7.2 - 14	9.8 - 19	1.00	12 - 17	16.3 - 23
	7T		17 - 22	23 - 29.8		19 - 27	25.7 - 36.6
	8T		20 - 26	27.1 - 35.2		22 - 31	29.8 - 42
M10	4T	1.50	20 - 25	27.1 - 33.9	1.25	20 - 29	27.1 - 39.3
	7T		34 - 40	46.1 - 54.2		35 - 47	47.4 - 63.7
	8T		38 - 46	51.5 - 62.3		40 - 52	54.2 - 70.5
M12	4T	1.75	28 - 34	37.9 - 46.1	1.25	31 - 41	42 - 55.6
	7T		51 - 59	69.1 - 79.9		56 - 68	75.9 - 92.1
	8T		57 - 66	77.2 - 89.4		62 - 75	84 - 101.6
M14	4T	2.00	49 - 56	66.4 - 75.9	1.50	52 - 64	70.5 - 86.7
	7T		81 - 93	109.8 - 126		90 - 106	122 - 143.6
	8T		96 - 109	130.1 - 147.7		107 - 124	145 - 168
M16	4T	2.00	67 - 77	90.8 - 104.3	1.50	69 - 83	93.5 - 112.5
	7T		116 - 130	157.2 - 176.2		120 - 138	162.6 - 187
	8T		129 - 145	174.8 - 196.5		140 - 158	189.7 - 214.1
M18	4T	2.00	88 - 100	119.2 - 136	1.50	100 - 117	136 - 158.5
	7T		150 - 168	203.3 - 227.6		177 - 199	239.8 - 269.6
	8T		175 - 194	237.1 - 262.9		202 - 231	273.7 - 313
M20	4T	2.50	108 - 130	146.3 - 176.2	1.50	132 - 150	178.9 - 203.3
	7T		186 - 205	252 - 277.8		206 - 242	279.1 - 327.9
	8T		213 - 249	288.6 - 337.4		246 - 289	333.3 - 391.6

PARTS BREAKDOWN / NOMENCLATURE DES PIÈCES
ROTATION SYSTEM WITH CHUTE
SYSTÈME DE ROTATION AVEC GOULOTTE

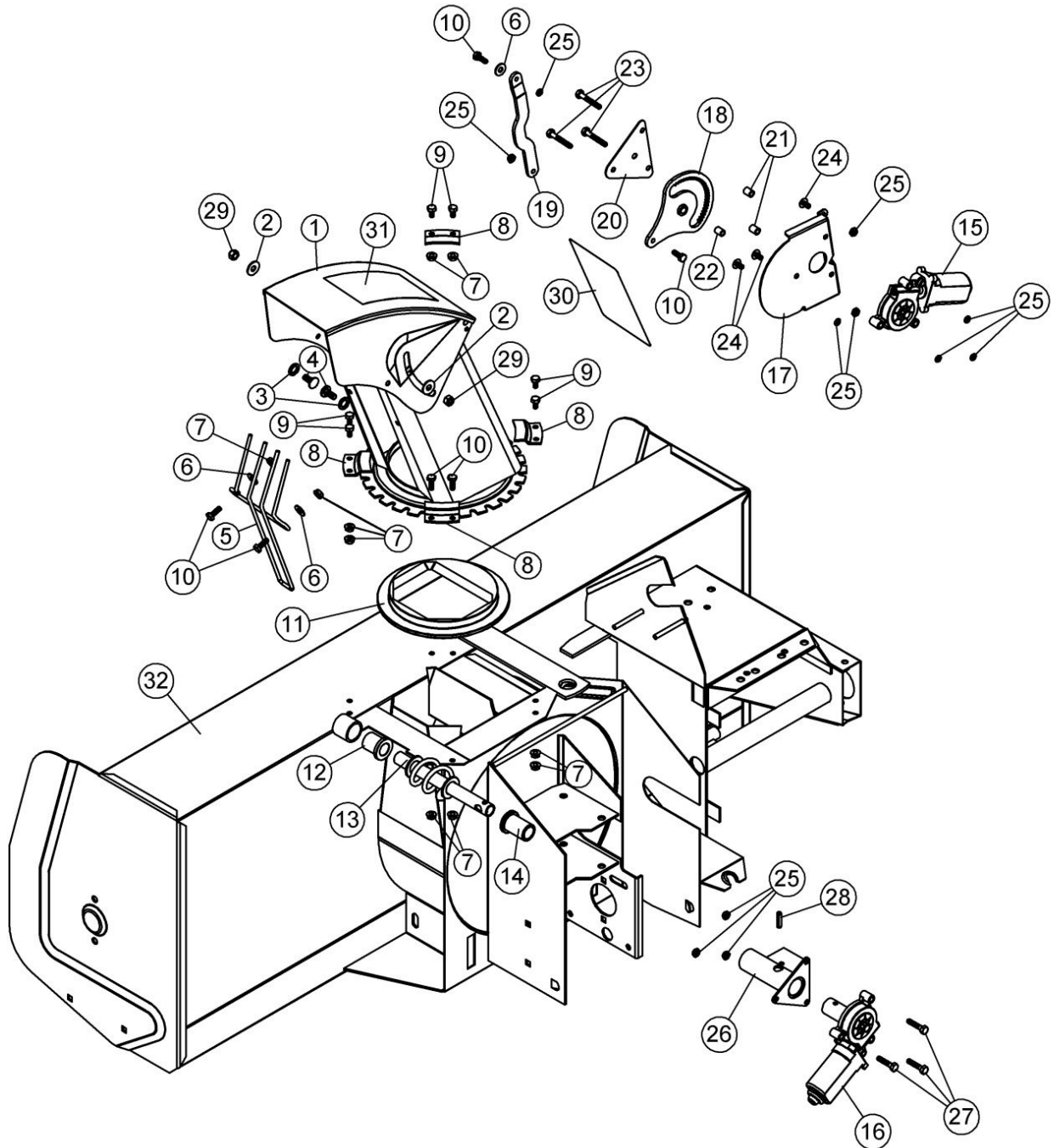

PARTS LIST / LISTE DES PIÈCES

Ref. Réf.	English description	Description française	Qty. Qté.	Part # Pièce #
1	Chute	Goulotte	1	102058
2	Nylon flat washer 11/32"	Rondelle plate de nylon 11/32"	2	102009
3	Nylon flat washer 7/16"	Rondelle plate de nylon 7/16"	2	102011
4	Carriage bolt 5/16" n.c. x 3/4"	Boulon à carrosserie 5/16" n.c. x 3/4"	2	O/L
5	Hand guard	Fourche protectrice	1	102012
6	Flat washer 5/16" hole	Rondelle plate 5/16" trou	3	O/L
7	Flange nut 1/4" n.c.	Écrou à bride 1/4" n.c.	10	O/L
8	Retaining plate	Plaque de retenue	4	102007
9	Hex. bolt 1/4" n.c. x 1/2"	Boulon hex. 1/4" n.c. x 1/2"	6	O/L
10	Hex. bolt 1/4" n.c. x 3/4"	Boulon hex. 1/4" n.c. x 3/4"	6	O/L
11	Rotation ring	Anneau de rotation	1	102016
12	Rotation bushing	Coussinet de rotation	1	102060
13	Rotation worm	Spirale de rotation	1	102005
14	Rotation bushing	Coussinet de rotation	1	102059
15	Electric motor	Moteur électrique	1	103378
16	Elect. motor ass'y with sleeve 103373	Mot. élect. ass'é avec douille 103373	1	103380
17	Bracket	Support	1	103375
18	Lever	Levier	1	103365
19	Arm	Bras	1	103364
20	Plate	Plaque	1	103363
21	Spacer	Espaceur	2	103361
22	Oil lite bushing	Coussinet imprégné d'huile	1	103362
23	Hex. bolt 1/4" n.c. x 1 3/4"	Boulon hex. 1/4" n.c. x 1 3/4"	3	O/L
24	Machine screw T.H. 1/4" n.c. x 1/2"	Vis mécanique T.H. 1/4" n.c. x 1/2"	3	O/L
25	Nylon insert lock nut 1/4" n.c. (thin)	Écrou à garniture de nylon 1/4" n.c.(mince)	11	O/L
26	Adaptor	Adapteur	1	103371
27	Hex. bolt 1/4" n.c. x 1 1/4"	Boulon hex. 1/4" n.c. x 1 1/4"	3	O/L
28	Roll pin 1/4" x 1"	Goupille roulée 1/4" x 1"	1	O/L
29	Nylon insert lock nut 5/16" n.c.	Écrou à garniture de nylon 5/16" n.c.	2	O/L
30	Warning decal	Décalque attention	1	102125
31	Danger decal	Décalque danger	1	102127
32	Frame 48"	Châssis 48"	1	104771

O/L= Obtain locally / Obtenir localement

PARTS BREAKDOWN / NOMENCLATURE DES PIÈCES SUBFRAME ASSEMBLY / SOUS-CHÂSSIS ASSEMBLÉ

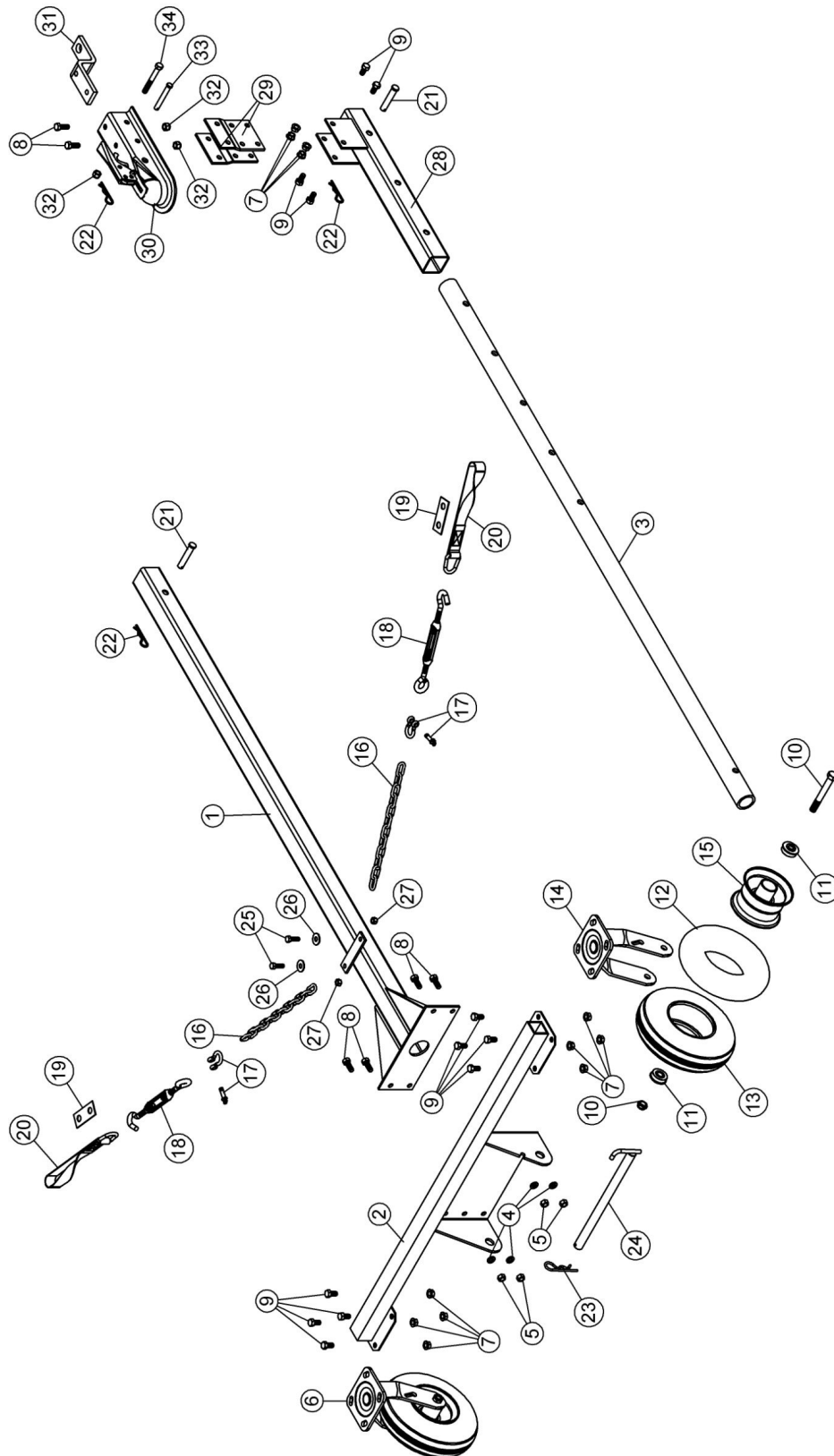

PARTS LIST / LISTE DES PIÈCES

Ref. Réf.	English description	Description française	Qty. Qté.	Part # Pièce #
1	Subframe	Sous-châssis	1	104769
2	Wheel support	Support de roue	1	104770
3	Subframe extension	Extension du sous-châssis	1	104637
4	Lock washer 3/8"	Rondelle de blocage 3/8"	4	O/L
5	Hex. nut 3/8" n.c.	Écrou hex. 3/8" n.c.	4	O/L
6	Caster wheel assembly	Roue pivotante assemblée	2	104779
7	Flange nut 3/8" n.c.	Écrou à bride 3/8" n.c.	12	O/L
8	Hex. bolt 3/8" n.c. x 1"	Boulon hex. 3/8" n.c. x 1"	6	O/L
9	Hex. bolt 3/8" n.c. x 3/4"	Boulon hex. 3/8" n.c. x 3/4"	12	O/L
10	Axle bolt & nut	Boulon essieu & écrou	1	104778
11	Ball bearing	Roulement à billes	2	102688
12	Inner tube 250-4	Chambre à air 250-4	1	102675
13	Tire 280/250-4	Pneu 280/250-4	1	102674
14	Fork assembly	Fourche assemblée	1	104777
15	Rim & bearing	Jante & roulement	1	104793
16	Chain	Chaîne	2	104633
17	Shackle Ptd Z	Clevis Pqé Z	2	102343
18	Turnbuckle	Tendeur	2	104634
19	Bracket	Fixation	2	104632
20	Lift strap	Sangle de relevage	2	103613
21	Pin	Goupille	2	102189
22	Hair pin 3mm	Goupille à ressort 3mm	3	102617
23	Hair pin 4mm	Goupille à ressort 4mm	1	102054
24	Pin	Goupille	1	104759
25	Hex. bolt 5/16" n.c. x 1"	Boulon hex. 5/16" n.c. x 1"	2	O/L
26	Flat washer 3/8" hole	Rondelle plate 3/8" trou	2	O/L
27	Nylon insert lock nut 5/16" n.c.	Écrou à garniture de nylon 5/16" n.c.	2	O/L
28	Hitch support	Support d'attache	1	104638
29	Hitch support	Support d'attache	2	104641
30	Hitch	Attache	1	104639
31	Hitch ball support	Support de boule d'attelage	1	104640
32	Nylon insert lock nut 3/8" n.c.	Écrou à garniture de nylon 3/8" n.c.	3	O/L
33	Pin	Goupille	1	104642
34	Hex. bolt 3/8" n.c. x 3"	Boulon hex. 3/8" n.c. x 3"	1	O/L

O/L= Obtain locally / Obtenir localement

PARTS BREAKDOWN / NOMENCLATURE DES PIÈCES SNOWBLOWER / SOUFFLEUSE

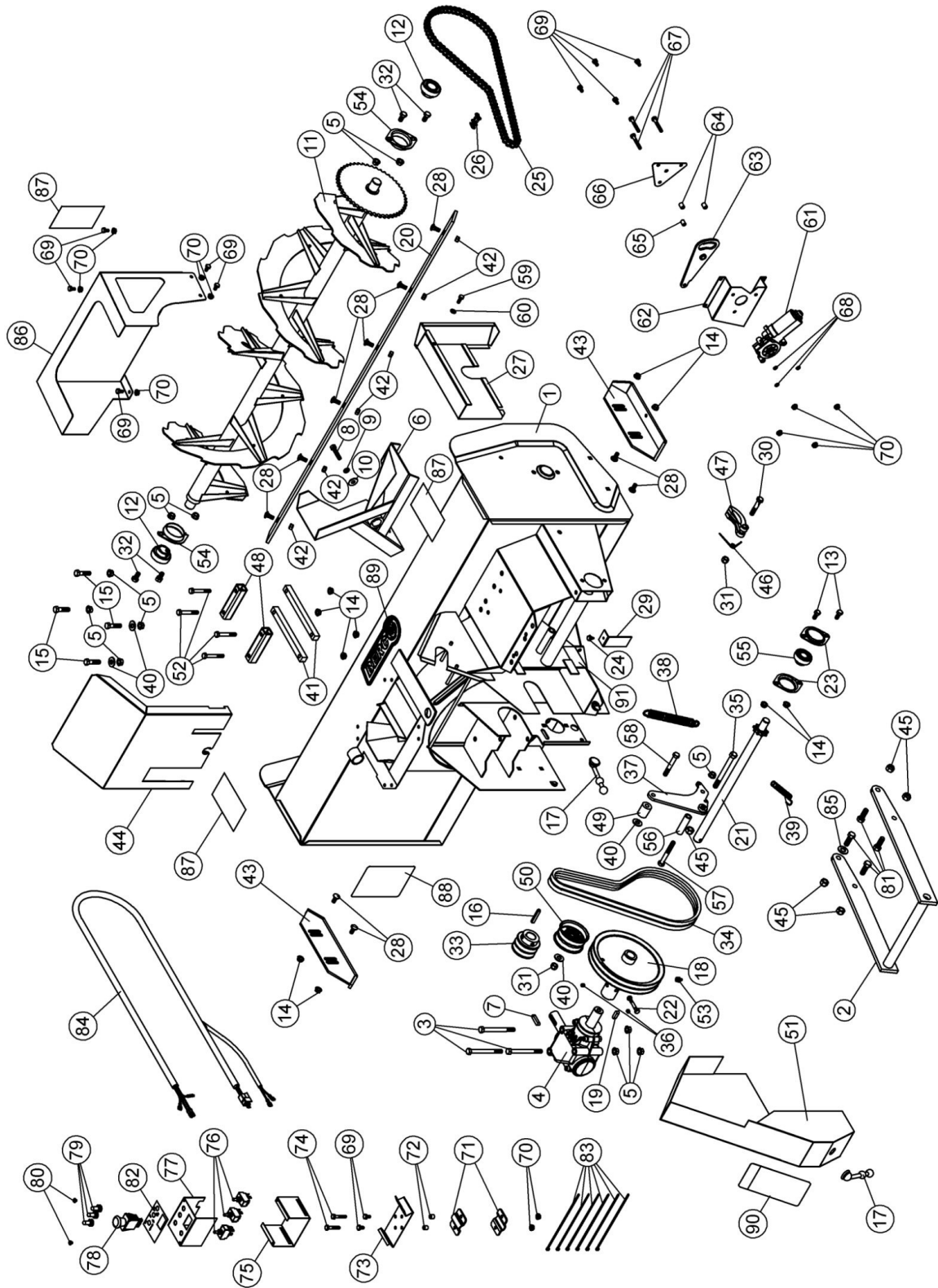

PARTS LIST / LISTE DES PIÈCES

Ref. Réf.	English description	Description française	Qty. Qté.	Part # Pièce #
1	Frame 48"	Châssis 48"	1	104771
2	Hitch	Attache	1	104768
3	Hex. bolt 3/8" n.c. x 4"	Boulon hex. 3/8" n.c. x 4"	3	O/L
4	Gear box	Boîte d'engrenage	1	102029
5	Flange nut 3/8" n.c.	Écrou à bride 3/8" n.c.	12	O/L
6	Fan	Éventail	1	102001
7	Key 8 x 7 x 35mm	Clé 8 x 7 x 35mm	1	102035
8	Hex. bolt 8mm x 1.25 x 25mm	Boulon hex. 8mm x 1.25 x 25mm	1	O/L
9	Lock washer 5/16"	Rondelle de blocage 5/16"	1	O/L
10	Flat washer 3/8" hole	Rondelle plate 3/8" trou	1	O/L
11	Auger 48"	Vis 48"	1	103200
12	Bearing with set screw	Roulement à billes avec vis à pression	2	102755
13	Hex. bolt 5/16" n.c. x 3/4"	Boulon hex. 5/16" n.c. x 3/4"	2	O/L
14	Flange nut 5/16" n.c.	Écrou à bride 5/16" n.c.	10	O/L
15	Hex. bolt 3/8" n.c. x 1 1/2"	Boulon hex. 3/8" n.c. 1 1/2"	4	O/L
16	Key 1/4" x 1/4" x 1 3/4"	Clé 1/4" x 1/4" x 1 3/4"	1	102327
17	Rubber Latch	Attache en caoutchouc	2	102547
18	Double pulley	Poulie double	1	103313
19	Key 8 x 7 x 25mm	Clé 8 x 7 x 25mm	1	102030
20	Cutting edge 48"	Racloir 48"	1	103187
21	Drive shaft 48"	Arbre de commande 48"	1	103335
22	Shear bolt /N.I.L.N.T. (auger) pkg-10	Boulon de séc. /É.G.N.M. (vis) pqt-10	1	103088
23	Flangette	Flangette	2	102212
24	Tapping screw 1/4"-14 x 1/2"	Vis taraudeuse 1/4"-14 x 1/2"	1	O/L
25	Chain roller #40 x 92 links / connecting link	Chaîne #40 x 92 mailles/avec maille d'acc.	1	102022
26	Connecting Link #40	Maille d'accouplement #40	1	102040
27	Chain guard	Garde-chaîne	1	102698
28	Carriage bolt 5/16" n.c. x 3/4"	Boulon à carrosserie 5/16" n.c. x 3/4"	10	O/L
29	Chain guard	Garde-chaîne	1	102041
30	Hex. bolt 3/8" n.c. x 2"	Boulon hex. 3/8" n.c. x 2"	1	O/L

PARTS LIST / LISTE DES PIÈCES

Ref. Réf.	English description	Description française	Qty. Qté.	Part # Pièce #
31	Nylon insert lock nut 3/8" n.c.	Écrou à garniture de nylon 3/8" n.c.	2	O/L
32	Hex. bolt 3/8" n.c. x 3/4"	Boulon hex. 3/8" n.c. x 3/4"	4	O/L
33	Pulley 2.5ø with set screw	Poulie 2.5ø a/vis à pression	1	102330
34	Pair of V-Belts, Raw Edge	Paire de courroies en V, Raw Edge	1	103745
35	Hex. bolt 7/16" n.c. x 4 1/2"	Boulon hex. 7/16" n.c. x 4 1/2"	1	O/L
36	Hex. socket set screw 5/16" n.c. x 5/16"	Vis à pression hex. 5/16" n.c. x 5/16"	2	O/L
37	Idler arm	Bras de poulie	1	103334
38	Spring	Ressort	1	102592
39	Spring 1/2"	Ressort 1/2"	1	102003
40	Flat washer 7/16" hole	Rondelle plate 7/16" trou	4	O/L
41	Shim	Cale	2	102886
42	Stover lock nut 5/16" n.c.	Écrou de blocage 5/16" n.c.	6	O/L
43	Heavy duty skid shoe	Patin extra robuste	2	102591
44	Belt guard	Garde-courroie	1	102556
45	Nylon insert lock nut 7/16" n.c.	Écrou à garniture de nylon 7/16" n.c.	5	O/L
46	Spring	Ressort	1	103291
47	Tensioner	Tensionneur	1	103289
48	Shim	Cale	2	102485
49	Sleeve	Douille	1	103338
50	Idler pulley	Poulie tendeur	1	102548
51	Belt guard	Garde-courroie	1	104484
52	Hex. bolt 5/16" n.c. x 2 1/4"	Boulon hex. 5/16" n.c. x 2 1/4"	4	O/L
53	Grease fitting 1/8"	Graisseur 1/8"	1	O/L
54	Flangette	Flangette	2	102680
55	Bearing with set screw	Roulement à billes avec vis à pression	1	102864
56	Sleeve	Douille	1	103332
57	Hex. bolt 3/8" n.c. x 3"	Boulon hex. 3/8" n.c. x 3"	1	O/L
58	Hex. bolt 3/8" n.c. x 2 3/4"	Boulon hex. 3/8" n.c. x 2 3/4"	1	O/L
59	Hex. bolt 1/4" n.c. x 3/4"	Boulon hex. 1/4" n.c. x 3/4"	1	O/L
60	Spring Washer	Rondelle à ressort	1	104352
61	Electric motor	Moteur électrique	1	103378

PARTS LIST / LISTE DES PIÈCES

Ref. Réf.	English description	Description française	Qty. Qté.	Part # Pièce #
62	Bracket	Support	1	104754
63	Lever	Levier	1	104755
64	Spacer	Espaceur	2	103361
65	Oil lite bushing	Coussinet imprégné d'huile	1	103362
66	Plate	Plaque	1	103363
67	Hex. bolt 1/4" n.c. x 1 3/4"	Boulon hex. 1/4" n.c. x 1 3/4"	3	O/L
68	Nylon insert lock nut 1/4" n.c. (thin)	Écrou à garniture de nylon 1/4" n.c.(mince)	3	O/L
69	Hex. bolt 1/4" n.c. x 1/2"	Boulon hex. 1/4" n.c. x 1/2"	11	O/L
70	Flange nut 1/4" n.c.	Écrou à bride 1/4" n.c.	11	O/L
71	Support bracket	Fixation du support	2	103068
72	Spacer	Espaceur	2	103368
73	Box support	Support de la boîte	1	104756
74	Hex. bolt 1/4" n.c. x 1 1/2"	Boulon hex. 1/4" n.c. x 1 1/2"	2	O/L
75	Box	Boîte	1	104757
76	Switch	Commutateur	3	103381
77	Box cover	Couvercle de la boîte	1	104758
78	P.T.O. switch	Commutateur de p.d.f.	1	104807
79	Rubber boot	Capuchon de caoutchouc	3	103379
80	Metal screw pan head #8 x 1/4"	Vis à métal tête pan #8 x 1/4"	2	O/L
81	Hex. bolt 7/16" n.c. x 1 1/4"	Boulon hex. 7/16" n.c. x 1 1/4"	4	O/L
82	Control decal	Décalque de contrôle	1	104762
83	Tie wrap 8"	Attache de nylon 8"	6	O/L
84	Wire assembly	Fil assemblé	1	104764
85	Flat washer 1/2" hole	Rondelle plate 1/2" trou	1	O/L
86	Protection plate	Plaque de protection	1	104192
87	Danger decal	Décalque danger	3	102126
88	Warning decal	Décalque attention	1	102553
89	Berco decal	Décalque Berco	1	102471
90	Danger decal	Décalque danger	1	102128
91	Serial number	Numéro de série	1	REF

O/L= Obtain locally / Obtenir localement

OPTIONS

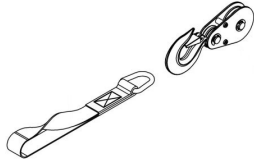

#700269
LIFT CONNECTION KIT
Reduces the effort required by the winch to lift the accessory.

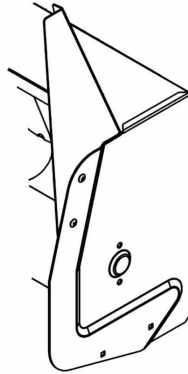

#700261
SNOW DRIFT CUTTER
Slices through high snow drifts to facilitate and increase snow intake. Package of 2.

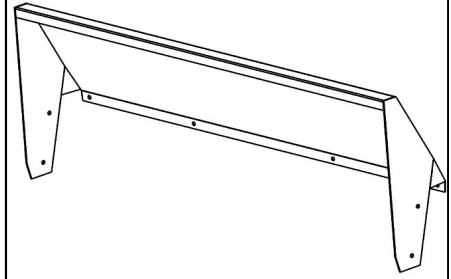

#700301
DRIFT EXTENSION KIT FOR 48"
Increase snow intake.
Prevents snow from getting in the engine.

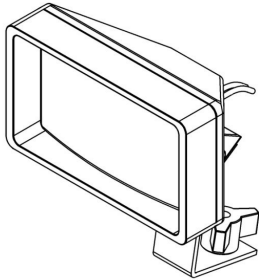

#700456
LIGHT KIT
Better visibility for night time use

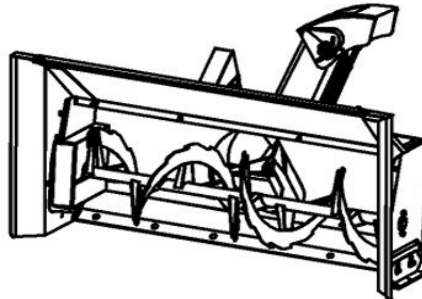

#700411
EXTENSION AND SIDE WIDENING ANGLES KIT
Widens the snowblower to 54"