



OWNER'S MANUAL
MODEL NUMBER

700714-1 (with Briggs Power Built 17.5 HP engine)

700818 (with commercial 20 HP engine)



BERCO
FINISHING MOWER 60"

- * ASSEMBLY
- * OPERATION

- * REPAIR PARTS
- * MAINTENANCE

CAUTION:

**READ & FOLLOW ALL SAFETY RULES & INSTRUCTIONS BEFORE
OPERATING YOUR EQUIPMENT**



LIMITED WARRANTY

Conditions and Products Covered:

BERCOMAC guarantees any part of the product or accessory manufactured by BERCOMAC and found in the reasonable judgment of BERCOMAC to be defective in material and or workmanship will be repaired or replaced by an authorized dealer without charge up to our maximum labor rates and pre-established times. For replacement parts only standard ground freight services are covered. This warranty extends to the original retail purchaser only and is not transferable to any subsequent purchasers. This warranty applies to the products bought and used in North America.

Warranty Period

(from date of the original retail purchase)

- Residential use: 1 year
- Semi-commercial, professional or rental use: 90 days

Exceptions Noted Below; the following items are guaranteed by the original manufacturer and have their own warranty, conditions and limited time:

- Tire Chains: 90 days
- Engines: Will vary as per the manufacturer
Please refer to the engine manufacturer's warranty statement included with the unit. BERCOMAC is not authorized to handle warranty adjustments on engines.

Items and Conditions NOT Covered:

This warranty does not cover the following:

- Pick-up or delivery charges or in-home services fees.
- Any damage or deterioration of the unit, parts and or finish of these due to normal use, wear and tear, or exposure.
- Cost of regular use or maintenance service or parts, such as gas, oil, lubricants, tune-up parts, and adjustments.
- Any part or accessory which has been altered, modified, misused, neglected, accidentally damaged or not properly installed, maintained, stored or repaired not in accordance with the instructions in the owner's manual.
- Repair due to normal wear and or any wear items such as shear pins, bolts, belts, etc.
- Expedited freight fee services for replacement parts.
- Shear bolts and shear pins are to be considered as a preventive measure not as an assured protection, any damages resulting from the lack of shear bolts breakage are not covered.
- Damages due to product being installed on a vehicle other than stipulated in owner's manual.

NOTE: All warranty work must be performed by an authorized dealer using original (manufacturer) replacement parts.

NOTE: Bercomac reserves the right to change or improve the design of any part or accessory without assuming any obligation to modify any product previously manufactured.

Instructions for Obtaining Warranty Services:

Contact dealer where equipment was purchased or any other BERCO service dealer to arrange service at their dealership. Requests for warranty claims must be carried out through the same distribution network used to purchase the product.. Don't forget to bring your proof of purchase (sales receipt) to the BERCOMAC dealer.

Owner's Responsibilities:

BERCOMAC's defective equipment or part must be returned to an authorized dealer within the warranty period for repairs. In the event that defective merchandise must be returned to manufacturer for repairs, freight fees are prepaid and a written authorization from BERCOMAC must be obtained by dealer prior to the shipment. This warranty extends only to equipment operated under normal conditions. To validate a warranty claim, it is the user's responsibility to maintain and service the unit as specified in the owner's manual or to have the unit serviced at their dealer at their expense.

General Conditions:

The sole liability of BERCOMAC with respect to this warranty shall be strictly and exclusively repair and replacement as mentioned herein. BERCOMAC shall not have any liability for any other costs, loss or damage, including but not limited to, any incidental or consequential loss or damage. Taking advantage of the warranty does not in any way extend the length or renewal of the warranty.

In particular, without being limited to, BERCOMAC shall have no liability or responsibility for:

- Travel time, overtime, after hours time or other extraordinary repair charges or relating to repairs and or replacements outside of normal business hours.
- Rental of like or similar replacement equipment during the period of any, repair or replacement work.
- Any communicating or travel charges.
- Loss or damage to person or property other than that covered by the terms of this warranty.
- Any claims for lost revenue, lost profit or any similar costs as a result of damage or repair.
- Attorney's fees.

BERCOMAC's responsibility in respect to claims is limited to making the required repairs or replacement without charge up to our maximum labor rates and pre-established times and no claim of breach of warranty shall be cause for cancellation or rescission of the contract of sale of any product or accessory. In no event recovery of any kind be greater than the amount of the purchase price of the product sold.

This warranty gives you specific legal rights. You may also have other rights, which vary from state to state.

TABLE OF CONTENTS

| | PAGE |
|---|------|
| INTRODUCTION | 1 |
| SAFETY PRECAUTIONS | 2 |
| SAFETY DECALS | 4 |
| ASSEMBLY | |
| Assembly instructions | 5 |
| Step 1 Engine and battery preparation | 6 |
| Step 2 Caster wheel assembly | 7 |
| Step 3 Tow bar assembly | 8 |
| Step 4 Cable holder assembly | 9 |
| Step 5 Deflector assembly | 9 |
| Step 6 Installation on vehicle | 9 |
| Step 6 Control box support installation | 10 |
| OPERATION | 12 |
| ADJUSTMENTS | 17 |
| MAINTENANCE | 19 |
| GENERAL TROUBLESHOOTING | 24 |
| TORQUE SPECIFICATION TABLE | 27 |
| PARTS BREAKDOWN AND PARTS LIST | |
| Finishing mower 700714-1 | 28 |
| Finishing mower 700818 | 30 |

INTRODUCTION

TO THE PURCHASER

This new accessory was carefully designed to give years of dependable service. This manual has been provided to assist in the safe operation and servicing of your attachment.

NOTE: All photographs and illustrations in the manual may not necessarily depict the actual models or attachment, but are intended for reference only and are based on the latest product information available at the time of publication.

Familiarize yourself fully with the safety recommendations and operating procedures before putting the machine to use. Carefully read, understand and follow these recommendations and insist that they be followed by those who will use this attachment.



THIS SAFETY ALERT SYMBOL IDENTIFIES AN IMPORTANT SAFETY MESSAGE IN THIS MANUAL THAT HELPS YOU AND OTHERS AVOID PERSONAL INJURY OR EVEN DEATH. DANGER, WARNING, AND CAUTION ARE SIGNAL WORDS USED TO IDENTIFY THE LEVEL OF HAZARD. HOWEVER, REGARDLESS OF THE HAZARD, BE EXTREMELY CAREFUL.

DANGER: Signals an extreme hazard that will cause serious injury or death if recommended precautions are not followed.

WARNING: Signals a hazard that may cause serious injury or death if the recommended precautions are not followed.

CAUTION: Signals a hazard that may cause minor or moderate injury if the recommended precautions are not followed.

Record your attachment serial number and purchase date in the section reserved below (there is no serial number on the subframe). Your dealer requires this information to give you prompt, efficient service when ordering replacement parts. Use only genuine parts when replacements are required.

If warranty repairs are required please present this registration booklet and original sales invoice to your selling dealer for warranty service.

This manual should be kept for future reference.

Please check if you have received all the parts for your kit with the list of the bag and the list of the box.

SERIAL NUMBER : _____
(IF APPLICABLE)

MODEL NUMBER: _____

PURCHASE DATE : _____



SAFETY PRECAUTIONS



Careful operation is your best insurance against an accident. Read this section carefully before operating the vehicle and accessory. This accessory is capable of amputating hands and feet and throwing objects. Failure to observe the following safety instructions could result in serious injury. All operators, no matter how experienced they may be, should read this and other manuals related to the vehicle and accessory before operating. It is the owner's legal obligation to instruct all operators in safe operation of the accessory to prevent accidents or injuries.

These are common practices that may or may not be applicable to the product described in this manual.

GLOSSARY:

In this manual, right and left sides are determined by sitting on the seat of the vehicle facing forward.

In this manual, "accessories" means attachments (snowblower, rotary broom, blade, etc.) that you install on the vehicle (lawn tractors, A.T.V. s etc).

TRAINING:



This symbol, "Safety Alert Symbol", is used throughout this manual and on the accessory's safety labels to warn of the possibility of serious injury. Please take special care in reading and understanding the safety precautions before operating the vehicle and accessory.

1. Read this owner's manual carefully. Be thoroughly familiar with the controls and proper use of the vehicle and accessory. Know how to stop the unit and disengage the controls quickly.
2. Never allow children to operate the vehicle nor the accessory. Never allow adults to operate the vehicle nor the accessory without proper instructions. Local regulations restrict the age of the operator. Children are often attracted to accessories. Never assume children will stay in place where you have last seen them. Keep children under surveillance of a responsible adult at all times.
3. No one should operate the vehicle nor the accessory while intoxicated or while taking medication that impairs the senses or reactions. The operator should, if taking over the counter drugs, seek medical advice on whether he/she can safely operate the equipment.
4. Keep the area of operation clear of all people, particularly small children and pets.
5. Never start or operate the accessories except from the operator's station on the power unit except if this is impossible.

PREPARATION:

1. Thoroughly inspect the area where the accessory is to be used and remove door mats, all foreign objects and the like which could be pick up and projected by accessory.
2. For motorized accessories, disengage all clutches and shift into neutral before starting engine.
3. Prepare for emergencies. Be prepared if a fire starts. Keep first aid kit and fire extinguisher handy. Keep emergency phone numbers (doctor, ambulance, ect) near a phone

4. Do not operate the accessory without wearing adequate clothing and safety equipment. Long hair, loose clothing or jewelry can get caught in moving parts. Wear footwear that will improve footing on slippery surfaces.
5. Handle fuel with care, it is highly flammable and vapors are explosive.
 - a) Extinguish all cigarettes, cigars, pipes and other sources of ignition.
 - b) Use approved fuel container.
 - c) Never add fuel to a running engine or hot engine.
 - d) Fill fuel tank outdoors with extreme care. Never fill fuel tank indoors.
 - e) Never fill containers inside a vehicle, or on a truck or a trailer bed with a plastic liner. Always place containers on the ground, away from your vehicle, before filling.
 - f) When practical, remove gas-powered equipment from the truck or trailer and refuel it on the ground. If this is not possible, then refuel such equipment on a trailer with a portable container, rather than directly from a gasoline dispenser nozzle.
 - g) Keep the nozzle in contact with the rim of the fuel tank or container opening at all times, until refueling is complete. Do not use a nozzle lock-open device.
 - h) Never overfill fuel tank. Replace fuel cap securely and wipe up spilled fuel.
 - i) If fuel is spilled on clothing, change clothing immediately.
6. Never attempt to make any adjustments while the engine (motor) is running (except when specifically recommended by manufacturer).
7. Let the vehicle and accessory adjust to outdoor temperatures before using.
8. Never use an accessory without proper guards, plates, or other safety protective devices in place
9. Always make sure to wear the appropriate safety equipment required (glasses, muffs, mask...) for each type of product. See operation section.
10. Always make sure of having safe traction on the vehicle by using the recommended accessories (chains, A.T.V. tracks, counterweights...). See operation section.
11. Always make sure all components are correctly installed. (driveline securely attached and locked at both ends, belts properly installed...)
12. If applicable, always handle the winch cable with thick leather gloves.
13. **Never modify the accessory or any part without the written consent from the manufacturer.**



SAFETY PRECAUTIONS



OPERATION:

1. Do not put hands or feet near, under or inside rotating parts.
2. Exercise extreme caution when operating on or crossing gravel drives, walks or roads. Stay alert for hidden hazards or traffic. Do not carry passengers.
3. After striking a foreign object, stop the engine (motor), disconnect the wire from the spark plug(s) and keep wire away to prevent accidental starting. Thoroughly inspect the accessory for any damage and repair damage before restarting and using the accessory.
4. If the unit should start to vibrate abnormally, stop the engine (motor) and check immediately for the cause. Vibration is generally a warning of trouble. Do not use equipment until properly repaired.
5. Take all possible precautions when leaving the vehicle unattended. Disengage the power take-off, lower the attachment, place the transmission into neutral, set the parking brake, stop the engine and remove the ignition key.
6. Do not run the engine indoors, except when starting the engine and for transporting in or out of the building. Do not operate or let motor run in a storage area without ventilation because gas contains carbon monoxide which is odorless, colorless and can cause death.
7. Never use the accessories across the face of slopes, go from top to bottom. Exercise extreme caution when using equipment on slopes, on wet ground or near drop-off. Do not attempt to use accessory on a steep slope.
8. Never tolerate bystanders in the working zone. Never use an accessory in the direction of bystanders, it might throw gravel or debris that can hurt people or damage property.
9. Never operate the accessory at high transport speeds on slippery surfaces. Use care when backing up.
10. Do not carry passengers.
11. Disengage power to the accessory when it is transported or not in use.
12. Never operate the accessory without good visibility or light.
13. Keep the accessory away from heat sources or flames.
14. If applicable, never handle the winch cable or hook while under tension.
15. Never use accessory if it has been dropped or damaged. Repair if necessary before re-using.

MAINTENANCE AND STORAGE

1. When cleaning, repairing or inspecting the vehicle and accessory: park on a solid level ground, disengage drives, lower implement, set parking brake, stop the engine, remove ignition key, and wait that all moving parts have stopped. For gasoline engine, disconnect wire from the spark plug(s) and keep wire away to prevent accidental starting.
2. Check all the bolts and components at frequent intervals to make sure that they are properly tightened and in safe working condition.
3. Never store a motorized accessory with fuel in the fuel tank inside a building where ignition sources are present such as hot water and space heaters, clothes dryers, and the like. Allow the engine to cool before storing in any enclosure.
4. Always refer to the owner's manual when you store the accessory and vehicle for a prolonged or an unspecified length of time.
5. Maintain or replace safety and instruction labels, as necessary.
6. For winter accessories, (if applicable), let the engine run for a few minutes after clearing snow in order to prevent the rotary parts from freezing.
7. Inspect the vehicle's and accessory's air filter (if applicable) every day. Clean it or replace it as necessary. Change the oil more often when working in dusty conditions. See the vehicle's and accessory's owner's manual.

TRANSPORT

1. Review Transport Safety instructions in vehicle manual before moving or hauling.
2. Check with local authorities regarding transport on public roads and off road. Obey all applicable laws and regulations.
3. Make sure all lights and reflectors that are required by the local highway and transport authorities (example : SMV (Slow Moving Vehicle)) are in place, are clean, and can be seen clearly by all overtaking and oncoming traffic.
4. Never have the equipment in operation during transport.
5. Always travel at a safe speed.

SAFETY LABELS

REPLACE IF DECALS ARE DAMAGED
SEE PARTS BREAKDOWN FOR DECAL LOCATION



Decal #107584



Decal #105128



Decal #107585



Decal #108261

Recommendations about the gas to prevent damages to engine.

ASSEMBLY

ASSEMBLY INSTRUCTIONS

IMPORTANT: UNLESS OTHERWISE SPECIFIED TORQUE ALL BOLTS ACCORDING TO TORQUE SPECIFICATION TABLE. REFER TO PARTS BREAKDOWN SECTION FOR PART IDENTIFICATION.

NOTE: In this manual, the right and left side is determined being seated on the driver's seat facing forward.

INTENDED USE

This Finishing mower is designed to produce a quality finish cut on lawns, golf courses, etc. It is not designed to clear brush or cut saplings. Your Finishing mower should be towed behind an ATV, a golf cart, tractor, or similar approved vehicle. It is not meant for speeds exceeding 5 mph (8 km/h).

Remove the mower and all the other components from the crate.

Tools required:

Ratchet

Wrench : 7/16", 1/2", 9/16", 3/4", 15/16"

Sockets : 7/16", 1/2", 9/16", 3/4", 15/16", 3/8"

Pliers



Always make sure to wear the appropriate safety equipment required (glasses, muffs, mask...).



WARNING



THIS ACCESSORY IS HEAVY!

To avoid risk of strain injury, **NEVER** lift the accessory by hand alone when handling the components or assembly. Use proper lifting device and seek assistance.

When accessory is off the ground, **NEVER** be underneath the accessory. Serious injury including possibility of death could occur if accessory were to drop suddenly.

Always wear protective shoes and appropriate gloves when manipulating or using this equipment.

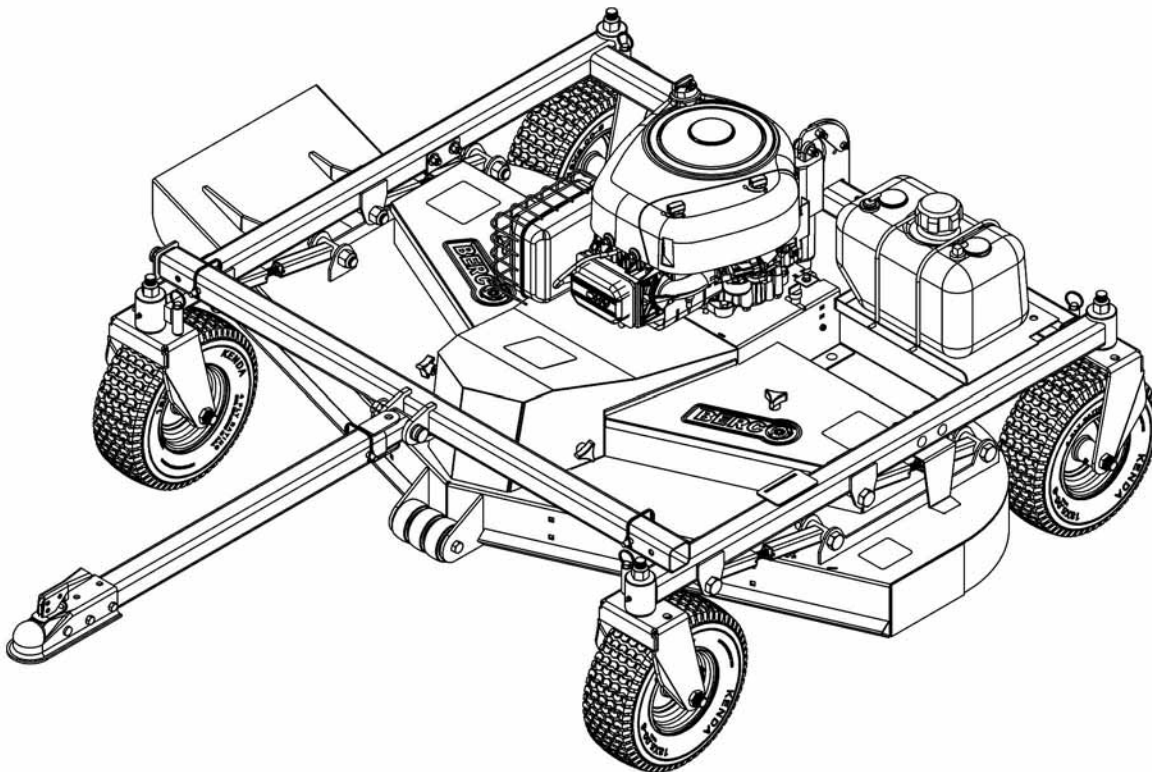

Overall view

ASSEMBLY

STEP 1 ENGINE AND BATTERY PREPARATION

Disengage spark plug wire and place it where it cannot make a connection.

Add oil in the engine. Verify oil level and add if necessary before starting engine. (See engine owner's manual).

U1 battery must be purchased locally:

Check the battery. If the battery is put into service after the "month and year" of the date on the battery, it may need to be recharged with a 12 volt battery charger. Follow the manufacturer's instructions for the battery or for the battery charger.

Remove the guard (item 1) by removing the knobs (item 2).

Attach battery cables to the battery, make sure to attach the red wire on the positive terminal first and then the black wire on the negative terminal.

Secure in place with the rubber ties. Reinstall the the guard (item 1)

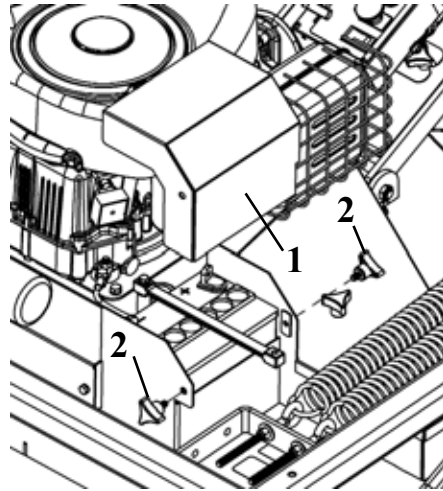

WARNING



TO PREVENT INJURIES OR DAMAGES:
It is important to put the protection cap on the battery's red post .

ASSEMBLY

STEP 2 CASTER WHEEL ASSEMBLY

Install the two rear wheels forks (item 1) with two spacers (item 2), two hex bolts 3/8" n.c. x 3 1/4" (item 3) and two nylon insert lock nuts (item 4).

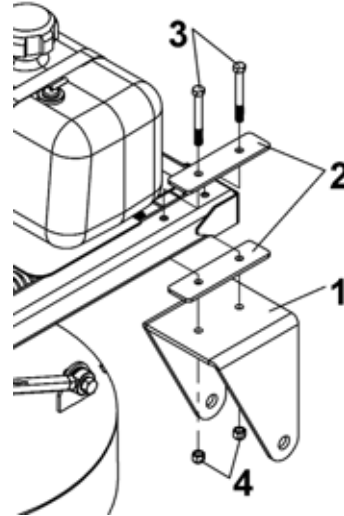

Install the two front wheels forks (item 5) with the bolts (item 6), nylon insert lock nuts (item 7) and the washer (item 9) already in place. Insert the lock pins (item 8) into place to lock the wheels.

Lock the **two front wheels** when:

- Transporting between mowing zones.
- Mowing at high speed.
- Mowing in a sector that does not require tight turns.

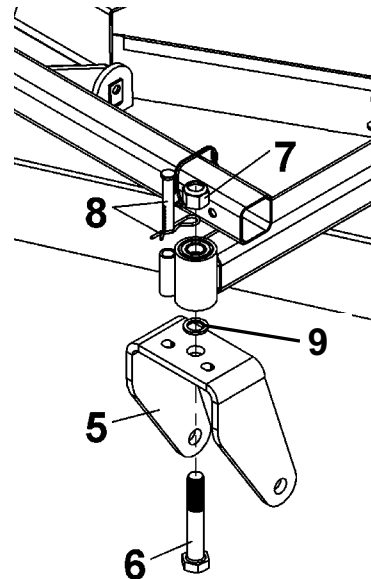

Install the four wheels (item 1) in the wheel forks (item 2) with the hex bolts 3/4" n.c. x 6 1/2" (item 3) and the thin nylon insert lock nuts (item 4).

Make sure there is a slight play between the wheel fork and the bearings, this will guarantee the wheel bearings are not too tight. Make sure the wheel turns freely after completing the assembly.

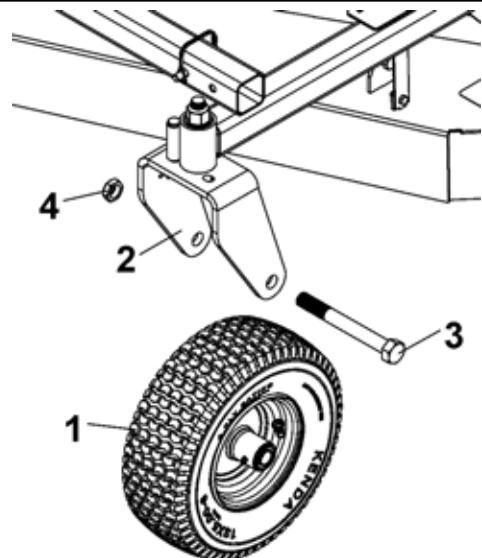

ASSEMBLY

STEP 3 TOW BAR ASSEMBLY



WARNING



**RISK OF GETTING PINCHED
TO PREVENT INJURIES:**
Handle with care and never leave the tow bar
(item B) in the raised position.

Central position:

Put the tow bar in place (item 1) with the help of a pin (item 2) and the lynch pin (item 3).

NOTE: the length of the tow bar (item B) is adjustable. Remove the pin (item 7) and adjust the length then reinstall the pin.

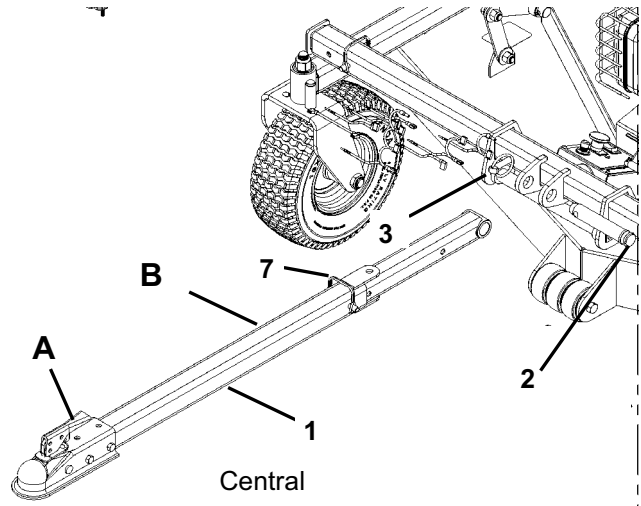

Left or right partial offset position:

Remove the lock pin (item 4) from the frame (item 8), insert the pin (item 5) in the tow bar (item 1) then secure in place with the lock pin (item 4).

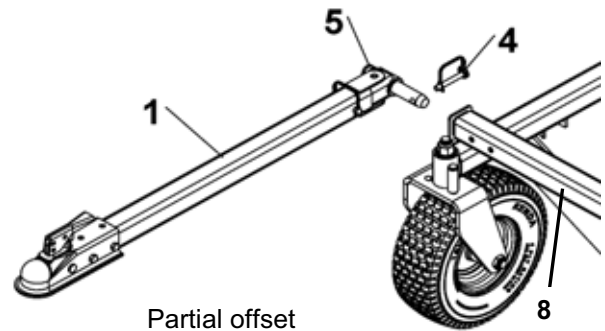

Left or right offset position:

Remove the lock pin (item 4) and remove the pin (item 5). Pull out the extension arm (item 2). Secure the extension arm in place with the lock pin (item 6) that is found on the other side of the frame (original location not shown). Install the tow bar (item 1) to the extension arm with the pin (item 5) and the lock pin (item 4).

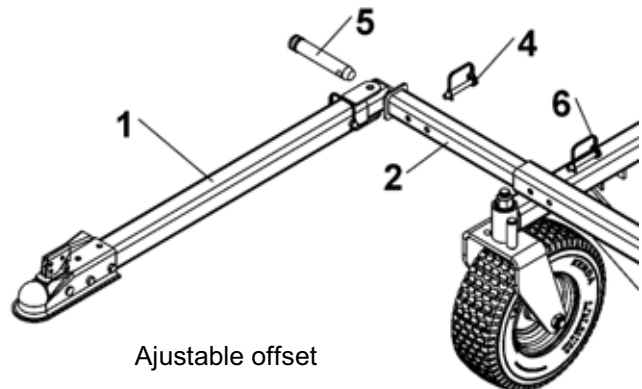

ASSEMBLY

STEP 4 **CABLE HOLDER ASSEMBLY**

Install the cable holder (item 1) on the tow bar (item A) with the U bolt plate (item 2), flat washers (item 3) and two 1/2" n.c. nylon insert lock nuts (item 4).

NOTE: Install the cable holder in about the same place as shown.
It will be possible to adjust the location of the cable holder to avoid possible interferences with the control cables when moving with the towing vehicle.

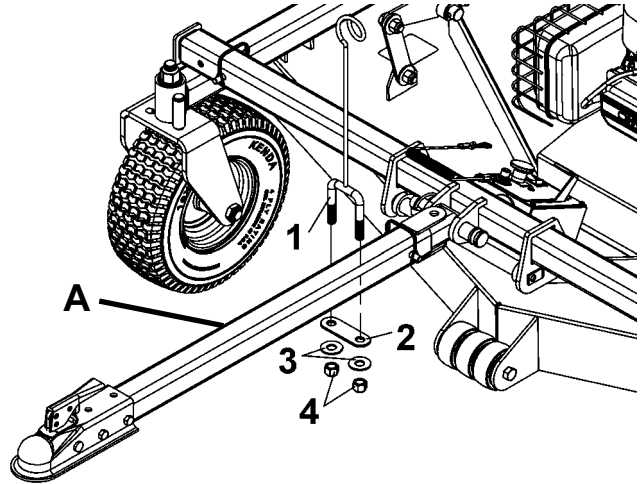

STEP 5 **DEFLECTOR ASSEMBLY**

Install the deflector (item 1) with two hex bolts 3/8" n.c. x 1 1/4" (item 2) and two nylon insert lock nuts (item 3).

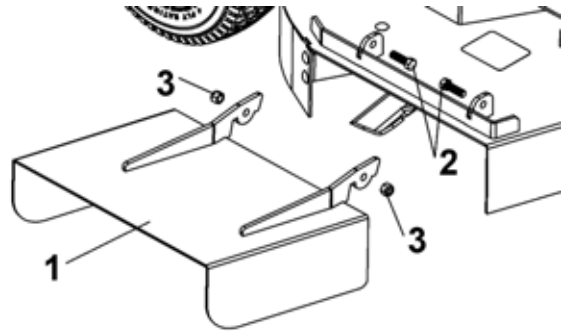

STEP 6 **INSTALLATION ON THE VEHICLE**

A 2" (50 mm) BALL HITCH IS REQUIRED ON THE TOW VEHICLE.

Back the vehicle up to desired towing position.

Place the accessory's hitch (item 1) on the tow hitch ball of the vehicle and secure in place with and a hair pin.

NOTE: A correct adjustment will allow the handle to be released with moderate pressure applied to the handle.
To open, pull up on hitch coupler handle (item 1) and rotate forward.
Place hitch coupler on ball.
When ball is completely nested in socket, rotate hitch coupler handle backward until handle is in locked into position.
Always check tightness before using the tow hitch.
Make sure the the handle is in locked position.
Lock the handle into position over the ball in the hitch coupler. Tighten the lock nut (item 2) against the the tension spring so that the hitch coupler is tight on the ball.

| | | |
|--|----------------|--|
| | WARNING | |
| TO PREVENT INJURIES: Always check that ball is completely inserted into hitch coupler socket and that under jaw is securely closed around the bottom of ball. Always check that hitch coupler handle is properly locked before its use. Always examine hitch coupler and ball for damage before using, replace if damaged. | | |

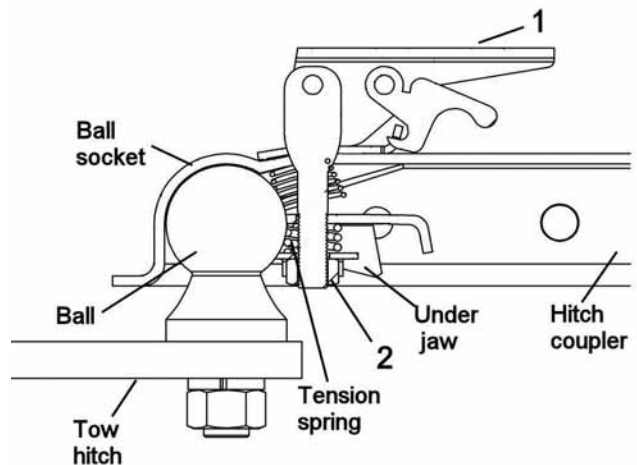

ASSEMBLY

STEP 7 CONTROL BOX INSTALLATION

1) Remove the control box (item 1) from the guard (item 2) by removing the knob (item 3).

TIP: The knob can stay on the guard. Once the control box has been removed, make sure to retighten the knob to avoid losing it because of the vibrations when the accessory is in operation.

2) Install the seal (item 1) on the support (item 2) with the hex bolt $5/16''$ n.c. x $3/4''$ (item 3), a flat washer $3/8''$ hole (item 4) and a nylon insert lock nut $5/16''$ n.c. (item 5). Do not tighten the seal. Use the groove (item A) on the control box to make sure the seal is not too tight and that it slips in easily.

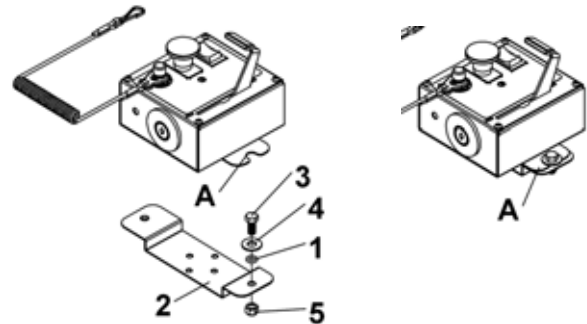
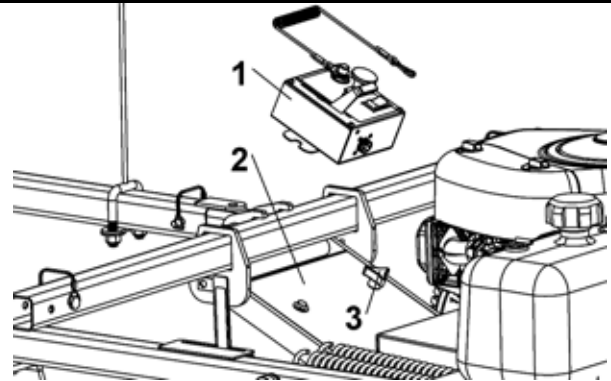

Choose option A or B to install the control box support (item 1).

NOTE: In order to prevent damage due to water accumulation, make sure to place the control box horizontally.

Option A

Use two hex bolts $1/4''$ x $1\ 1/2''$ (item 2), two spacers (item 3) and two flange nuts $1/4''$ (item 4) to attach the control box support to the support brackets (item 5).

NOTE: Choose the right hole combination on the control box support in order to direct the front of the control box towards the driving controls of the vehicle. (see operation section to see how control box is oriented), Furthermore, make sure to have free access at all times to the equipment's controls in order to safely control the equipment.

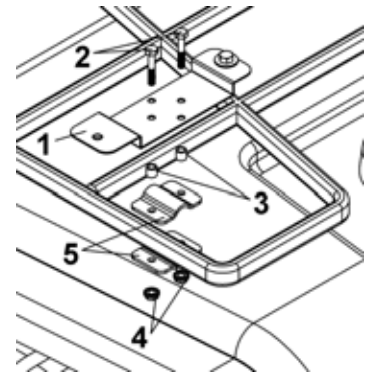

Option B

Drill two holes of $1\ 9/16''$ apart on the vehicle. Secure the control box support with two bolts $1/4''$ x $1/2''$ (item 6) and two flange nuts $1/4''$.

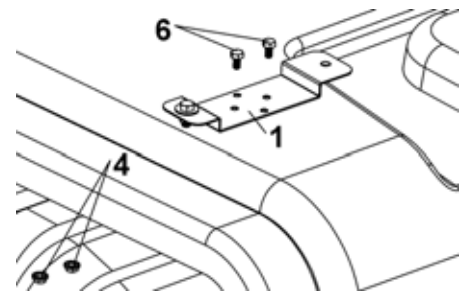

ASSEMBLY

INSTALL THE CONTROL BOX IN IT'S SUPPORT.

Insert the control box (item 1) in it's support (item 2).
Secure in place by tightening the knob (item 3).

Secure the cables:

Slide the cables (item 1) through the opening of the cable support (item 2).

IMPORTANT: Make sure to secure the cables in order to avoid any damage due to a contact with the vehicle, the accessory itself (especially, the muffler) or any other object that can be near and around these cables.

Tie the electric cable and the engine's control cable on the accessory and on the vehicle. If necessary use cable ties. **Do not forget:** the control box must be easily removable from the vehicle.

If needed, change the location of cable support (item 2) to avoid the any possible interference with the control cables during transportation with the towing vehicle.

IMPORTANT: Before operating this accessory, do the required adjustments indicated in the "Adjustments" section.

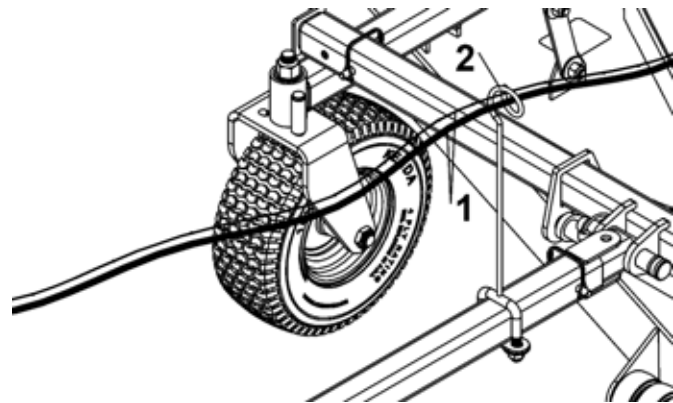
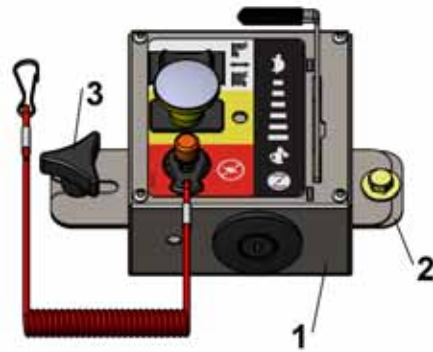

OPERATION

OPERATOR'S RESPONSIBILITY

Hazard control and accident prevention are dependent upon the awareness, concern, prudence and proper training involved in the operation, transport, storage and maintenance of the accessory. Therefore, it is absolutely essential that no one operates the accessory without first having read, fully understood and become totally familiar with the operator's manual.

SAFETY INFORMATION

WEAR YOUR SAFETY GLASSES



FORESIGHT IS BETTER THAN NO SIGHT



Always make sure to wear the appropriate safety equipment required (glasses, muffs, mask...).

The operation of any mower can produce foreign objects to be thrown into the eyes, resulting in severe eye damage.

Always wear certified safety glasses or wide-vision safety goggles over spectacles before starting any cutting machine and while operating such a machine.

The operation of any mower produces sound waves that are damaging to the human ear. Ear protection is recommended.

| |
|---|
| DANGER |
| Tragic accidents can occur if the operator is not alerted to the presence of children. Children are often attracted to the machine and the mowing activity. <i>Never assume that children will remain where you last saw them.</i> |
| DANGER |
| Before starting to operate: sit on the driver's seat and make sure to always attach on your wrist the emergency switch lanyard that is linked to the control box. <u>Never operate without this lanyard in place.</u> |
| DANGER |
| TO PREVENT INJURIES: Never place hands or feet under the deck or attempt to make adjustments to the cutter with ELECTRIC CLUTCH engaged . The blades rotating at high speeds cannot be seen and are located close to the deck housing. Body extremities can be cut off instantly. |
| DANGER |
| TO PREVENT INJURIES: Do not use the accessory as a fan. The blades are not designed for this use. Using this accessory as a fan can result in injuries or death. |
| WARNING |
| Always disengage electric clutch, engage parking brake, shut off vehicle, remove ignition key, and wait for all moving parts to come to a complete stop before dismounting from vehicle. |

| |
|---|
| DANGER |
| TO PREVENT INJURIES: Keep others away while the accessory is operating. It can discharge objects at high speeds. Therefore, the use of front and rear safety guards is strongly recommended when cutting along highways and in areas where people may be present. Stop blade rotation if a bystander is within at least 300 feet . |
| WARNING |
| TO PREVENT INJURIES: Never allow riders including children on the vehicle or accessory. They can fall and be ran over causing serious injury or death. |
| DANGER |
| TO PREVENT INJURIES: Do not operate and/or travel across steep inclines where a vehicle can rollover resulting in serious injury or death. Consult your vehicle's manual for acceptable inclines the vehicle is capable of traveling across. Never operate on slopes of more than 15 degrees MAX . |
| DANGER |
| TO PREVENT INJURIES: All guards and shields must be installed and in good working condition at all times during cutting operation. |

OPERATION

BEFORE FIELD OPERATION:

INSPECT THE VEHICLE

The vehicle's safety equipment is installed and in good working condition.

Vehicle is in good working condition and must respect the maintenance specifications as per the owner's manual of the vehicle.

ENGINE PREPARATION

See engine manufacturer's recommendations for the type and amount of oil and fuel used.

Make sure the tow vehicle's parking brake is set, mower is level, and blades are disengaged. Engine must be level to accurately check and fill oil. Do not overfill.

⇒ Check spark plug wire(s), oil and fuel.

⇒ Check all electrical connections for debris buildup .

Operate the engine according to the instructions in the engine manual.

ADJUST CUTTER

Before operating, refer to section « Adjustment » and proceed with the required adjustments according to the desired use.

ADJUST TIRE PRESSURE

Verify and adjust tire pressure as indicated directly on tire of the accessory. Air pressure must be even on both sides.

INSPECT THE ACCESSORY

Make the following inspections with the accessory attached to the vehicle. Make sure the electric clutch is disengaged the engine is shut off, the spark plug wire is disconnect and all moving components are completely stopped:

Park vehicle and the accessory on a level surface is resting on solid supports..

- Make sure there is nothing under the accessory that should not be there.
 - ⇒ (tools, block, feet, hands, etc.)
- Check for and remove foreign objects wrapped around blade spindles.
- Check for nicked, bent, broken, and worn cutting blades.
 - ⇒ Replace or sharpen blades as required. Refer to "Cutter Blade Maintenance".
- Remove solid supports from under the deck before operating.

INSPECT WORK AREA

Make sure the work area corresponds to the intended use of this equipment and it is safe to work within.

Do not cut in wet conditions. Allow wet grass to dry. Wet grass will clump and collect under the mowing deck creating poor discharge and premature wear. It will also require additional horsepower.



WARNING



TO PREVENT INJURIES:

Clear area to be cut of debris and other unforeseen removable objects before cutting. Mark any potential hazards that cannot be removed such as tree stumps, post, rocks, holes, and drop-offs with a visible flag.



WARNING



TO PREVENT INJURIES:

Do not operate accessory with loose hardware. Loose hardware can result in a breakdown causing serious injury or death.



WARNING



Loose blades can easily pierce a 1/4" steel plate. Loose blades can also be thrown up to 300 feet.

TO PREVENT SERIOUS INJURIES, DEATH AND MATERIAL DAMAGE:

Periodically (and after a full day) disengage ELECTRIC CLUTCH, shut down engine, remove key, and :

- Check for foreign objects wrapped around the rotor shaft.
- Lift and block the accessory before removing objects.
- Frequently inspect accessory for any sign of wear or loose bolts and nuts (especially the the bolts for the stump jumper and the blade).
- Tighten as indicated in the Torque specification table.
- Make sure all guards are in place at all times.



CAUTION



TO PREVENT INJURIES:

Do not exceed rated cutting capacity indicated (see « **INTENDED USE** » section) .



WARNING



TO PREVENT INJURIES:

Do not use accessory to lift or carry objects; to pull fence posts, stumps or other objects; or to tow other equipment. Doing so can damage the accessory, causing serious injury or death.

OPERATION

FAMILIARIZATION WITH THE CONTROL BOX



WARNING



Read the vehicle's owner's manual carefully. Be thoroughly familiar with the controls & proper use of the attachment. Know how to stop the unit & disengage the controls quickly.



WARNING



TO PREVENT INJURIES:

Always disengage electric clutch, engage parking brake, shut off vehicle, remove ignition key, and wait for all moving parts to come to a complete stop before dismounting from vehicle.

Item 1: Ignition switch.

Using the key: Allows to start the engine or you may turn the key to "accessory" setting to activate the controls without starting the engine. The light (item 7) is on when the key is turned to "accessory" or "start" setting.

Always remove the key when the equipment is left without surveillance.

Item 2: Throttle lever

Push towards the front to increase engine speed, push completely to the end to "start"

Item 3: Emergency switch

Push to stop equipment quickly.

Item 4: Safety lanyard:

Links the operator to the control box. If the operator leaves the driver's seat without stopping the equipment, the equipment will stop (the cable will disconnect itself from the emergency switch).



WARNING



There may be a possibility that in certain cases, the safety lanyard may be too long according to the position of the control box on the vehicle and how the lanyard is attached to the operator . IT IS THE OPERATOR'S RESPONSIBILITY to make sure the lanyard is installed safely so the lanyard disconnects itself as soon as the operator leaves the driving seat in one direction or the other. **IF REQUIRED:** shorten the lanyard making sure it retains its original resistance.

Item 5: Engagement switch

Pull to engage, push to disengage. The light (item 8) is on when equipment is engaged.

Item 6: Height adjustment switch.

Allows to adjust the cutting height.

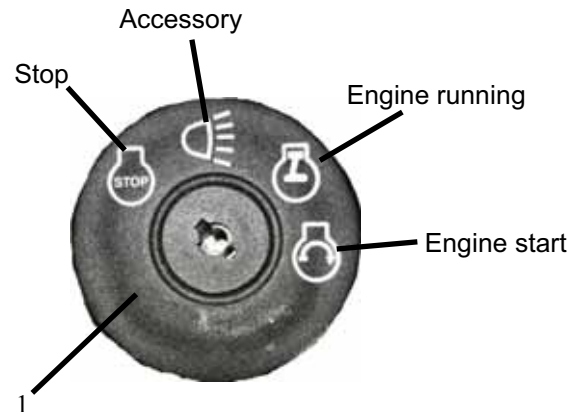
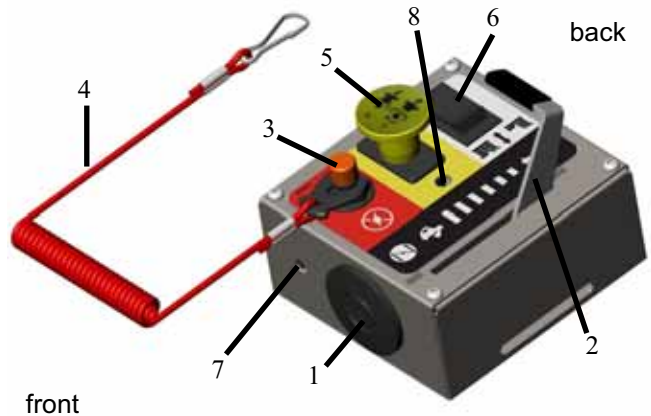

OPERATION

STARTING THE ENGINE, INSPECTIONS AND BURNISHING THE CLUTCH



WARNING



TO PREVENT INJURIES:

Start **the engine**, engage and disengage the **electric clutch** to be sure it works normally. Make sure the **emergency switch** is working perfectly. Make sure **all the controls** are working well before using the accessory.



WARNING



TO PREVENT INJURIES:

Stop **ELECTRIC CLUTCH** immediately if vibrations continues after a few evolutions during start-up and anytime thereafter. Wait for all moving parts to come to a complete stop before dismounting from vehicle to check for probable causes. Make necessary repairs and adjustments before continuing.

STARTING THE ENGINE

Before starting to work, sit on the driver's seat and always **attach to yourself the emergency switch lanyard** that is linked to the control box .

NOTE: Do not attempt to start the unit with the engagement knob pulled up in the "ENGAGED" position.

Using the control box, follow these steps:

- Set the throttle lever on the control box to "START" position.
- Turn key to the "ACCESSORY" setting, then to the "START" setting.
- Set throttle lever to minimum RPM.
- Allow engine to idle a few moments before engaging the blades.

BLADE ENGAGEMENT & DISENGAGEMENT

The remaining inspections are made by engaging the blades to check for vibrations.

Cutter blades can lock-up against each other during start-up and shut-down.

Following Blade Engagement and Blade Disengagement instructions below.

ENGAGING THE BLADES

A) Place the engine lever at **minimum throttle**.

B) While engine is running at idle, engage the blades by pulling up the **engagement switch**.

IMPORTANT: While engine is running full throttle, make sure the accessory is not vibrating excessively for at least 3 seconds.

DISENGAGING THE BLADES

A) Slowly decrease throttle speed until engine idle speed is reached.

B) Then, push down the engagement switch to disengage the blades.

C) Engage vehicle's parking brake, shut off vehicle's engine and remove ignition key from the switch.. Stay on vehicle until blades are completely stopped.

IMPORTANT:

If excessive vibrations continue after 3 seconds at full engine speed, **immediately disengage**, shut down engine, and remove the key from the switch.

BURNISHING PROCEDURE

The burnishing procedure must be performed before the first time use of the accessory and after each prolonged period of inactivity. Burnishing the engaging system will ensure proper performance and will help avoid damages.

1. Make there is nothing that blocks the rotation and start the engine.
2. Engage electric clutch.
3. Disengage electric clutch and wait for all moving parts to stop.
4. Repeat procedure (steps 2 & 3) 10 times within 30 seconds intervals to avoid overheating the clutch which may result in damage.

OPERATION

BREAKING IN THE BELT AND OPERATING IN THE FIELD

BREAKING IN THE BELT

Set the vehicle parking brake and chock the wheels.

While the engine is running, slowly engage blade control.

In a safe environment, (i.e. no children or pets) allow blades to rotate and engine to idle for 5 minutes, breaking in the belt for a longer life.

Stop the accessory.

STOPPING THE ENGINE

Make sure the tow vehicle parking brake is set.

Disengage the cutting blades.

Reduce engine to idle speed and allow engine to run momentarily for cooling.

Turn the key to the "OFF" position.

STARTING TO CUT

Adjust the cutting height using the height adjustment knob on the control box.

Double check secure coupling of accessory to the vehicle vehicle.

Always follow the starting the engine instructions on the previous page, start the mower engine.

Engage the blades following the instructions on the previous pages.

Start mowing at a slow traveling speed.

STOPPING THE CUTTING SESSION

Bring tow vehicle to a complete stop, set the parking brake and disengage blades.

Turn key switch to the "OFF" position.

Always remember to remove keys to avoid accidental start ups and irresponsible use.

TRANSPORTING THE ACCESSORY

Stop the accessory.

Lift the mower deck to its highest position.

See "Transportation" section to move the accessory in a secure way.

SUGGESTED MOWING PRACTICES

Maintain correct engine speed.

After the first 50 feet of cutting:

- Stop working and disengage the electric clutch.
- Check cutting height and if the accessory is level to make sure it is properly adjusted.

Optimum ground speed:

- It depends on the density of the materials being cut and the terrain.
- Mowing should be started with tow vehicle in low gear and increased only as safe mowing conditions permit. **This speed should not exceed 5 mi/h (8km/h).**

The average lawn should be cut to approximately 2.5" during the cool season and to over 3" during the hot months.

For a healthier lawn and better aesthetics, your lawn should be mowed often and after moderate growth.

When cutting high or dense grass areas, go slowly. Some areas may need to be mowed twice. The second cut should be at 90 degrees to the first, if possible.

Do not attempt to cut areas that the tow vehicle cannot maneuver through and/or slopes that you do not feel comfortable riding.

ADJUSTMENTS



WARNING



STOP THE ENGINE AND DISCONNECT THE SPARK PLUG CABLE BEFORE DOING ANY ADJUSTMENTS ON THE MOWER

FRONT TO BACK ADJUSTMENT

For best cutting results, the cutter deck should be parallel to the ground. To check parallel adjustment, measure the distance from the bottom edge of the deck in both the front and rear of the deck. This adjustment is best done while the tow vehicle and mower are attached together.

Adjust as needed by turning the rod end assembly (item 1).

Make sure to have the same adjustment on both sides of the mower.

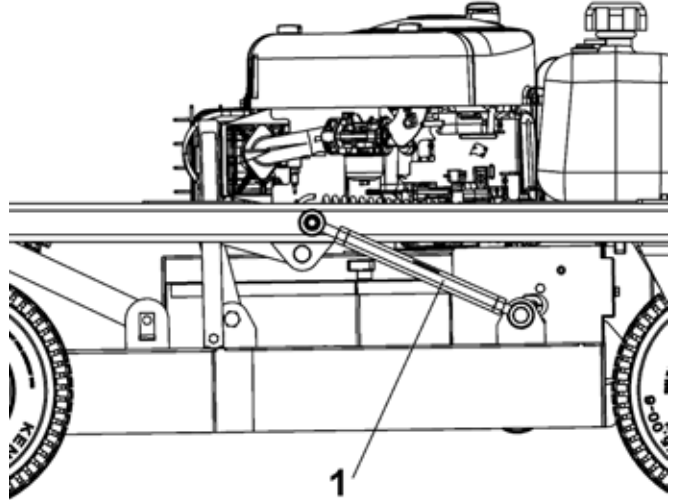

LATERAL ADJUSTMENT

The mower must cut evenly on the right and left side. If this is not the case, adjust the position of the actuator to adjust this.

If the mower is lower on the right side than on the left side, adjust the arm support (item 1) with the top and bottom nut..

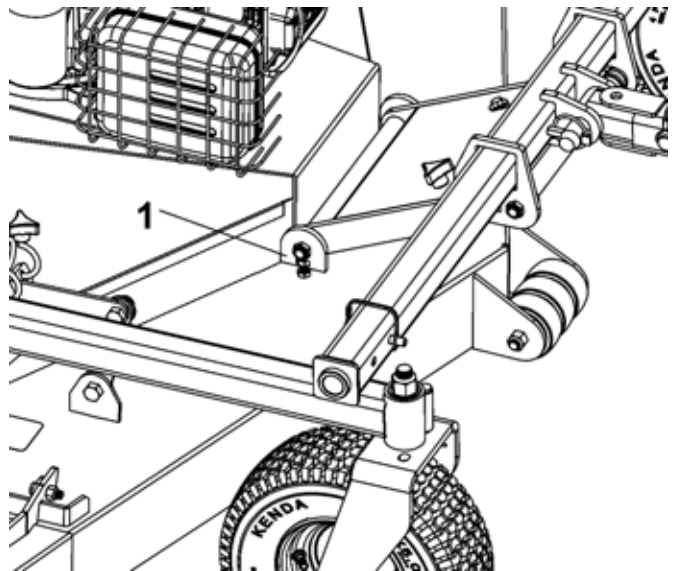

ADJUSTMENTS

CUTTING HEIGHT ADJUSTMENT

There is approximately 4" of height adjustment. It is not required to disconnect the spark plug for this step, since it is done from the driver's seat.

Adjust the height with the knob for the height control on the control box.

Dense areas should be cut in two passes.

MAXIMUM AND MINIMUM CUTTING HEIGHT ADJUSTMENT

Use the other adjustment holes (item 1) on the actuator support.

Make sure the mower does not come into contact with the wheels of the mower or any other component after doing this adjustment.

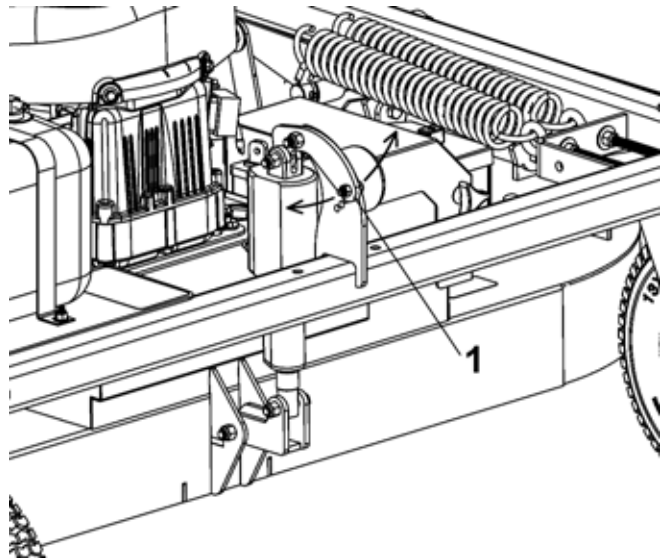

TOW HITCH OFFSET

Offset the mower to the opposite side of the discharge chute of the tow vehicle.

It is recommended if the tow vehicle is equipped with a mid-mount mower to overlap the cut by approximately 6". This may vary depending on terrain to be mowed, obstacles, and/or tow vehicle.

Always keep safety as the first priority.

See **Step 3** in the assembly section for more details.

Make sure the accessory's **tow bar never comes into contact with the wheels** on the vehicle.

MAINTENANCE

ALWAYS PRACTICE SAFE MAINTENANCE

Proper servicing and adjustment is the key to the long life of any attachment. Careful and systematic inspection can avoid costly downtime, maintenance, and repairs.

Never allow untrained personnel to service machine.

Always understand the procedures before doing any work.

Use the proper tools and equipment.

Use a jack to support equipment when required.

Check all bolts after using the unit for several hours to be sure they are tight.

Check for damage of the protective structures such as the guards and replace damaged parts as necessary.

Replace any worn, damaged, or illegible safety labels.

Do not modify the accessory in a way which will adversely affect its performance.

Refer to the engine's manual & vehicle's manual for additional information.



Always make sure to wear the appropriate safety equipment required (glasses, muffs, mask...).

ENGINE MAINTENANCE

Maintain the engine according to the instructions in the engine's owner's manual.

ATTACHMENT MAINTENANCE

Check mounting bolts at frequently in order to prevent costly repairs.

Make sure your attachment is in safe working condition.

BEFORE EACH SEASON

A new spark plug and clean air filter assures proper air fuel mixture and helps your engine to run better and last longer.

- Replace the spark plug.
- Clean or replace the air filter.
- Check blades and belts for wear. Replace as necessary.

BEFORE EACH USE

- Check engine's oil level. Do this twice to ensure an accurate reading.
- Check condition of air filter and clean or replace if necessary.
- Check blade operation.
- Check for loose fasteners, if so, please tighten.
- **Verify and adjust the pressure** of the tires of the accessory. The tire pressure must be even on both sides. Do not exceed the maximum inflation pressure shown on the tire sidewall.

DAILY MAINTENANCE

- Make sure all nuts and bolts are tight and cotter pins and retainer springs are secure.
- Keep blades sharp.
- Observe all safety precautions.



DANGER



Before proceeding with any maintenance, assembling or dismantling of the accessory:

- Disengage accessory.
- Stop the accessory's engine and remove the ignition key from the switch.
- Place the accessory on a level and safe surface.
- Set the vehicle's parking brake.
- Make sure all moving parts have stopped before dismantling.
- Disconnect the wire from the spark plug(s) and keep away from spark plug(s) to prevent accidental starting.



WARNING



TO PREVENT INJURIES:

Do not use **the deck** as a working platform. The deck **is not** designed or protected for this use. Using deck as a **working platform** could cause serious injury or death.



DANGER



TO PREVENT INJURIES:

Always secure mower deck in the raised position with solid supports before servicing the underside of accessory.

GENERAL RECOMMENDATIONS

The warranty on this accessory does not cover items that have been subjected to operator abuse or negligence. To receive full value of the warranty, operator must maintain the unit as instructed in this manual.

Some adjustments will need to be made periodically to properly maintain your unit.

MAINTENANCE

MOWER BLADE MAINTENANCE

BLADE INSPECTION

1. Check blades for wear. Blade performance will be reduced as blades wear out and are re-sharpened.
2. Check blades to see if they are bent, deformed, damaged or split. Do not attempt to straighten or weld the blades for reuse. They should be removed and discarded.

BLADE SHARPENING OR REPLACEMENT

IMPORTANT: Replace the 3 mower blades at same time with genuine manufacture's blades only. Not replacing the 3 blades at the same time will cause an unbalanced condition.

1. If the blade's cutting edge is dull or nicked, it should be replaced or sharpened. Remove the blade by removing the bolt 5/8 x 7" Gr8 (item 2), the spacer (item 4), nylon insert flange lock nut (item 3) and the washer (item 5) (see parts breakdown for reference). It is not necessary to remove the pulley or any other component.



DANGER



Make sure the blade is not able to turn when removing or installing so that it does not come in contact with tools, components or any parts of the body that can cause bodily injury or death. Or, make sure if the blade rotates there will be no contact with any tools, components or any parts of the body.

- NOTE:** Care should be taken in order not to remove any more material than necessary when sharpening the blade.
2. Clean the blade and mounting surface of all debris before replacing or sharpening. Grind cutting edge at the same level as the original. Sharpen only the top of the cutting edge to maintain sharpness. Sharpen at a 30 degree angle.



DANGER



TO PREVENT INJURIES:

Bent, deformed or split blades should be removed from unit and discarded. Never weld a broken or cracked blade. **DO NOT** attempt to straighten to reuse such blades. Always replace with a new blade to assure safety.



WARNING



TO PREVENT INJURIES:

DO NOT attempt to modify a blade, such as hard surfacing, hot or cold treatment or by any other method.



CAUTION



TO PREVENT INJURIES:

ALWAYS wear eye protection and gloves while inspecting, removing, sharpening and replacing the mower blades.

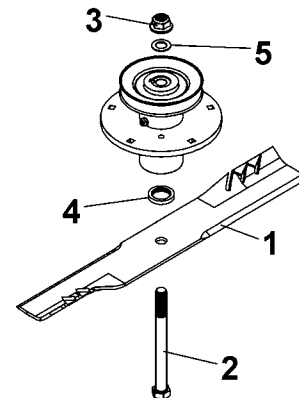

DANGER



When installing the blade make sure to tighten at the specified torque. Always use thread locking sealant and change the lock nut every time a nut is loosened. Always install all the parts in the same order as shown. Not following these instruction can cause the blade to fall from the spindle causing damage, injuries or death.

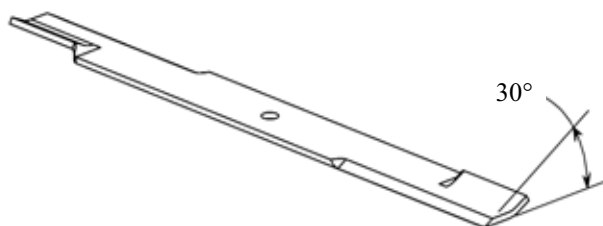

MAINTENANCE



3. Check blade balance by positioning the blade horizontally on a nail or on shaft in the central hole. If either end of the blade points downward, grind (remove) some material off that end until the blade balances. The blade is properly balanced when neither ends drop. Blade balance is generally maintained by removing an equal amount of material from each end of the blade when sharpening.

IMPORTANT:The blade must not be sharpened beyond 3/8" (B dimension) and the blade's most worn out point must not be thinner than 5/32" (A dimension).

IMPORTANT: Always install blade with the cutting edge facing the direction of rotation and the wing tips pointing up.

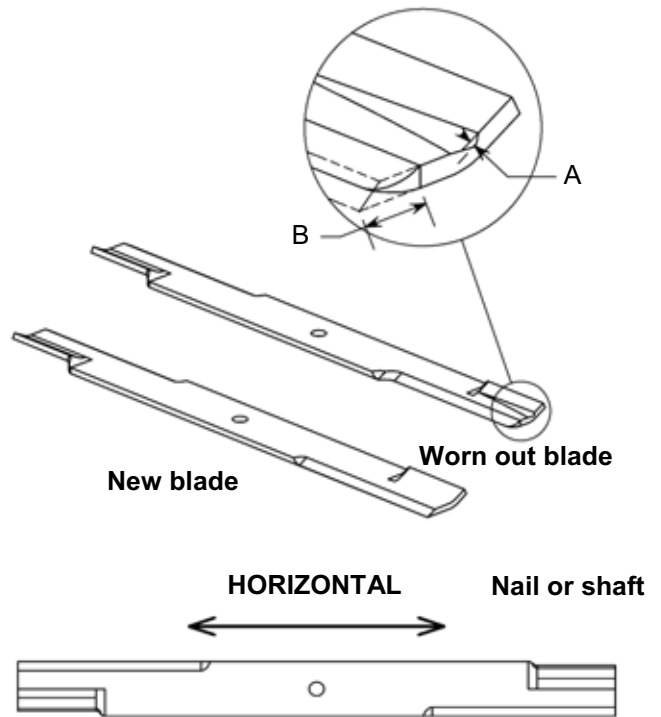
4. Install the blade with the wing tips pointing towards the bottom of the deck. Reinstall the blade reversing the installation steps. Make sure to use the appropriate torque for the bolt (see torque specification table). Put thread locking sealant on the nylon flange lock nuts, 5/8" once installed. Furthermore, use a brand new nylon insert flange nut each time.



| | | |
|---|---------------|--|
|  | DANGER |  |
| <p>When installing the blade make sure to tighten at the specified torque. Always use thread locking sealant and change the lock nut every time a nut is loosened. Always install all the parts in the same order as shown. Not following these instruction can cause the blade to fall from the spindle causing damage, injuries or death.</p> | | |

V-BELT INSTALLATION

Illustration (figure A) is also on the labels located on the top of the mower deck.

- Remove right hand and left hand belt covers.
- (Figure B) Disengage belt tension by loosening eyebolt (item 1) and removing the spring (item 2).
- Install the belt as shown in figure A.
- Reinstall the belt tensioner and apply appropriate tension.
- Reinstall all belt covers and secure in place with hardware.

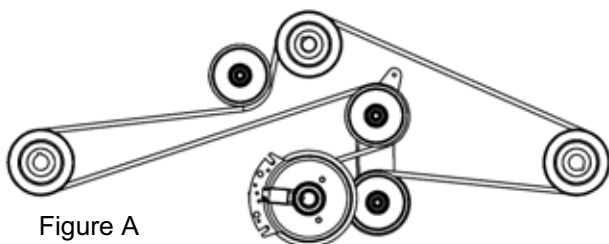

Figure A

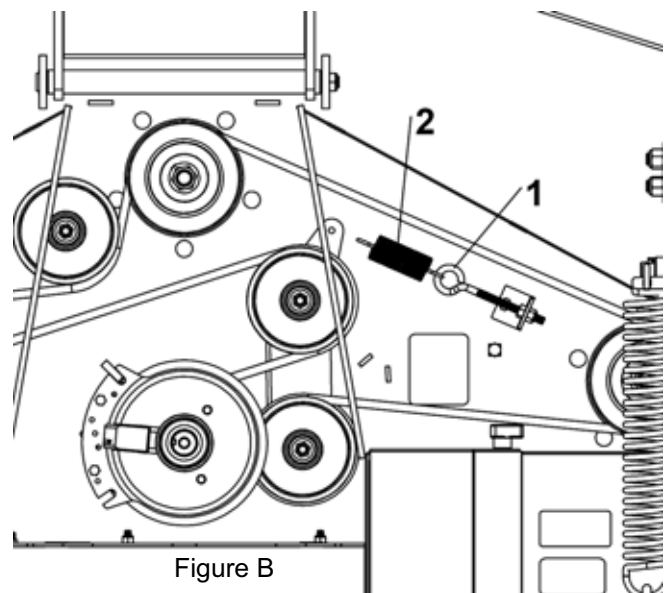

Figure B

LUBRICATION

Caster wheel assembly

Wheel Hub (every 24 hours and before first use)
Grease until it comes out of the hole.

Type of Lubrication: Multi-purpose Grease

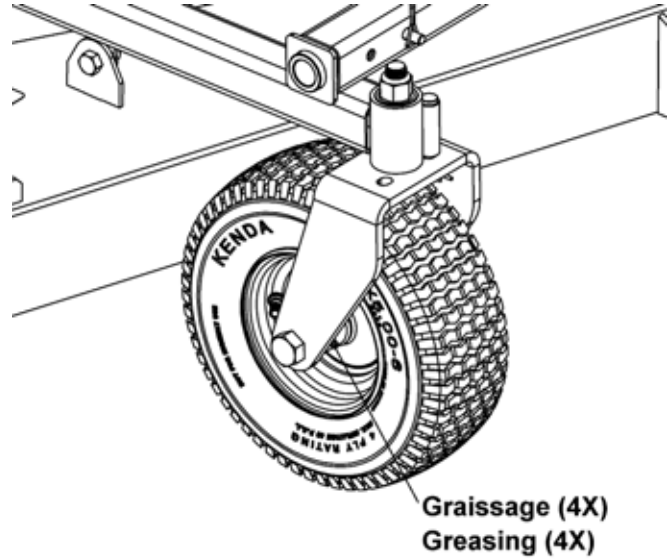

Belt tensionner

(every 24 hours and before first use)
Grease until it comes out from up and down.

Type of Lubrication: Multi-purpose Grease

TRANSPORTATION

TRANSPORTING THE MOWER

- Always **disengage ELECTRIC CLUTCH** before the raising the deck to transport position.
- Raise the deck to its maximum.

When transporting the equipment without towing it behind a vehicle, disconnect the wire from the spark plug(s) and keep away from spark plug(s) to prevent accidental starting.

IMPORTANT:

- Reduce vehicle's ground speed when turning and leave enough clearance so the accessory does not come into contact with obstacles such as buildings, trees, or fences.
- When traveling on roadways, transport in such a way that faster moving vehicles may pass you safely.
- Reduce speed when traveling over rough or hilly terrain.
- Always look down and behind, before and while driving backwards with the accessory.
 - ⇒ Make sure that the accessories rear hitch bar equipment does not come into contact with the vehicle's wheels.



DANGER



TO PREVENT INJURIES:

Do not operate and/or travel across **steep inclines** where a vehicle can rollover resulting in serious injury or death.

Consult your vehicle's manual for acceptable inclines the vehicle is capable of traveling across.

Never operate on slopes of more than **15 degrees Max.**



WARNING



TO PREVENT INJURIES:

When traveling on public roads, use accessory lights, SMV sign, clean reflectors, and other adequate devices to warn operators in other vehicles of your presence. Always comply with all federal, state, and local laws.

DISMOUNTING AND STORAGE

DISMOUNTING:

1. Shut off the accessory's engine.
2. Select a level surface, set the parking brake, stop the vehicle's engine and remove the ignition key to prevent accidental starting.
3. Remove the control box from the vehicle and install it on the accessory's battery guard.
4. Detach the accessory from the vehicle by removing it from the rear ball hitch.



WARNING



TO PREVENT INJURIES:

Always keep the tow bar on the ground when the mower is not in use. A tow bar left in the raised position can fall and cause injuries.

LONG TERM STORAGE

1. Clean off any dirt and grease that may have accumulated on the accessory and moving parts. Scrape off compacted dirt from the bottom of the deck and then wash surface thoroughly with a garden hose. A coating of oil may also be applied to the lower deck area to minimize oxidation.
2. Check blades and blade bolts for wear and replace if necessary. See "Blade Maintenance" section.
3. Inspect accessory for loose, damaged, or worn parts and adjust or replace as needed.
4. Repaint parts where paint is worn or scratched to prevent rust.
5. Replace all damaged or missing decals.
6. Follow the instructions in the engine owner's manual.
7. Store accessory on a level surface and in a clean, dry place. Inside storage will reduce maintenance and assure a longer life.

TROUBLESHOOTING

* Please refer to parts breakdown section for parts identification.



CAUTION



IF PROBLEMS PERSIST, REFER TO A QUALIFIED MECHANIC TO INSPECT EQUIPMENT. NEVER ATTEMPT ANY ADJUSTMENT WHICH YOU ARE NOT SURE OF GETTING THE PROPER RESULTS, THIS COULD RESULT IN FURTHER DAMAGES OR PROBLEMS.

| PROBLEM | POSSIBLE CAUSE | SOLUTION |
|---|---|--|
| Rear discharge area is clogged up | The belt is not installed the right way | Check belt installation |
| | Grass is too wet | Wait until grass dries |
| | Grass is too tall | Raise cutting height and cut grass twice |
| | Blades are turning too slowly | Increase engine speed |
| | Tractor speed is too fast | Reduce tractor speed |
| Belt slips | Mower is clogged up | Unclogg and clean mower deck |
| | Pulleys are dirty | Remove guards and clean the pulleys |
| | Not enough tension on belt | Increase belt tension |
| | The belt is stretched and damaged | Change the belt |
| Patches of uncut grass | Blades are turning too slowly | Increase engine speed |
| | Tractor speed too fast | Reduce tractor speed |
| | Not enough tension on the belt | Increase belt tension |
| | Blades are worn down | Sharpen and balance or replace the blade |
| Excessive vibration | One or more blades are damaged | Replace blades |
| | The belt is damaged | Change the belt |
| | Pulleys are misaligned or damaged | Replace pulleys or align them |
| | Debris in the belt area | Remove belt guards & clean debris from the belt area and clean the pulleys |
| Blades are scalping the grass instead of cutting it | The grass is too tall | Raise cutting height and cut grass twice |
| | The mowing pattern is not the right | Change mowing pattern |
| | Tractor speed too fast | Reduce tractor speed |
| | Blades are worn out | Sharpen and balance or replace the blade |
| Uneven cut | Tractor speed too fast | Reduce tractor speed |
| | The mower is not level | Level the mower |
| | Blades are damaged or worn out | Replace the blades or sharpen |
| Only the blades are not turning | Not enough torque on the blade's bolt | Torque bolt according the torque specification table |

TROUBLESHOOTING

* Please refer to parts breakdown section for parts identification.

| PROBLEM | POSSIBLE CAUSES | CORRECTIVE ACTION |
|---|---|---|
| Accessory stops working. | Belt is probably damaged or broken | Check and replace damaged belt |
| Belt is snapping, shredding, burning or worn in a specific place | Accessory was engaged when clogged | Make sure the auger and the fan are not frozen or clogged before engaging |
| | Lack of tension on the belt | Adjust the tensioner spring or replace spring if stretched. |
| Belt shows premature wear | Not the original belts | Always use the original belts |
| | Worn belt, causing a slack. | Inspect the belt. Replace if required. |
| | Imperfections in the pulleys | Verify if the pulleys are damaged. Pulleys must be smooth without rust spots. Sand down the pulleys or replace them. |
| | Interference | Make sure the belt does not come into contact with any other part, bolts, guides etc... when engaged. |
| Accessory digs into ground. | Ground is too soft. | Do not operate on soft or wet ground. |
| The engine does not start | The emergency button is pushed down. | The emergency button must be pulled up to start the accessory's engine. |
| | Insufficient electrical current (A). | Turn key to the "OFF" position, check the battery and all other electrical connections and inspect spark plug and wire. |
| | The electromagnetic clutch is activated | Deactivate the electromagnetic clutch. |
| | Other reasons. | See engine's manual Contact engine manufacturer or an authorized and qualified mechanic. |
| Engine is not running well | Joystick and /or the gas cable is not well adjusted | Check the adjustment of the throttle lever |
| | Gas is stale | Replace the gas, clean the gas filter and the gas line. Use an appropriate gas stabilizer. |
| | Insufficient electrical current (A). | Check the spark plug and the hole. |
| Electric clutch slips | Insufficient electrical current. | Recharge vehicle's battery or replace it. |
| | Electrical current is cut off. | Certain wires are damaged must be replaced. |
| | The clutch plates are contaminated. | Clean the plates with brake cleaner. |
| Electric clutch is noisy or vibrates abnormally. | Mounting bolt that holds the clutch is loose. | Tighten or replace bolts. |
| | Certain clutch components may be damaged. | Repair or replace damaged components. |

TROUBLESHOOTING

* Please refer to parts breakdown section for parts identification.

| PROBLEM | POSSIBLE CAUSES | CORRECTIVE ACTION |
|--|---|---|
| Actuator doesn't hold its electric charge. | New actuators. | Due to the lubrication in the actuator, it may take about 100-200 lifts before the actuator holds its charge. |
| Actuator runs backwards | Switch wires reversed. | Recheck wire connections |
| | Battery wires reversed. | Recheck wire connections |
| Actuator will not operate | Vehicle's ignition switch is at the OFF position. | Turn vehicle's ignition switch to ACCESSORY position. |
| | Broken wires or disconnection. | Check wire connections. |
| | Control switch is inoperative. | Replace control switch. |
| | Relay or breaker is damaged. | Replace the damaged part. |
| | Actuator is damaged. | Replace or repair actuator. |
| Actuator works but with insufficient power or too slowly. | Weak battery. | Recharge or replace battery. |
| | Poor battery connection. | Check battery terminals for corrosion. Clean when required. |
| | Actuator is damaged. | Replace or repair actuator. |

| HOW TO KNOW | POINTS TO CHECK |
|--------------------------------|---|
| Actuator is damaged. | The best way to check the actuator is to connect it directly to the battery and to test its in both directions. If the actuator doesn't work, it is |
| The breaker is damaged. | With a multimeter, check the electrical flow to the two posts on the breaker. If the circuit is open, the breaker is damaged. (Sometimes, it could take a few minutes for the breaker to automatically reset itself). |

TORQUE SPECIFICATION TABLE

GENERAL TORQUE SPECIFICATION TABLE USE THE FOLLOWING TORQUES WHEN SPECIAL TORQUES ARE NOT GIVEN

NOTE: These values apply to fasteners as received from supplier, dry or when lubricated with normal oil. They do not apply if special graphited or moly disulphide greases or other extreme pressure lubricants are used. This applies to both UNF and UNC threads.

* Thick nuts must be used with grade 8 bolts

| SEE Grade No. | | 2 | | | | 5 | | | | 8 * | | | |
|--|------------|-------------|------|----------------|-------|-------------|------|----------------|-------|-------------|------|----------------|--------|
| BOLT HEAD IDENTIFICATION MARKS AS PER GRADE NOTE MANUFACTURING MARKS WILL VARY | | TORQUE | | | | TORQUE | | | | TORQUE | | | |
| BOLT SIZE | | FOOT POUNDS | | NEW TON-METERS | | FOOT POUNDS | | NEW TON-METERS | | FOOT POUNDS | | NEW TON-METERS | |
| Inches | Millimetre | Min. | Max. | Min. | Max. | Min. | Max. | Min. | Max. | Min. | Max. | Min. | Max. |
| 1/4" | 6.35 | 5 | 6 | 6.8 | 8.13 | 9 | 11 | 12.2 | 14.9 | 12 | 15 | 16.3 | 30.3 |
| 5/16" | 7.94 | 10 | 12 | 13.6 | 16.3 | 17 | 20.5 | 23.1 | 27.8 | 24 | 29 | 32.5 | 39.3 |
| 3/8" | 9.53 | 20 | 23 | 27.1 | 31.2 | 35 | 42 | 47.5 | 57 | 45 | 54 | 61 | 73.2 |
| 7/16" | 11.11 | 30 | 35 | 40.7 | 47.4 | 54 | 64 | 73.2 | 86.8 | 70 | 84 | 94.9 | 113.9 |
| 1/2" | 12.7 | 45 | 52 | 61 | 70.5 | 80 | 96 | 108.5 | 130.2 | 110 | 132 | 149.2 | 179 |
| 9/16" | 14.29 | 65 | 75 | 88.1 | 101.6 | 110 | 132 | 149.2 | 179 | 160 | 192 | 217 | 260.4 |
| 5/8" | 15.88 | 95 | 105 | 128.7 | 142.3 | 150 | 180 | 203.4 | 244.1 | 220 | 264 | 298.3 | 358 |
| 3/4" | 19.05 | 150 | 185 | 203.3 | 250.7 | 270 | 324 | 366.1 | 439.3 | 380 | 456 | 515.3 | 618.3 |
| 7/8" | 22.23 | 160 | 200 | 216.8 | 271 | 400 | 480 | 542.4 | 650.9 | 600 | 720 | 813.6 | 976.3 |
| 1" | 25.4 | 250 | 300 | 338.8 | 406.5 | 580 | 696 | 786.5 | 943.8 | 900 | 1080 | 1220.4 | 1464.5 |

| METRIC BOLT TORQUE SPECIFICATIONS | | | | | | | |
|-----------------------------------|-----------|---------------|-------------|---------------|-------------|-------------|---------------|
| | | COARSE THREAD | | | FINE THREAD | | |
| Size Screw | Grade No. | Pitch (mm) | Foot Pounds | Newton-Meters | Pitch (mm) | Foot Pounds | Newton-Meters |
| M6 | 4T | 1.00 | 3.6 - 5.8 | 4.9 - 7.9 | - | - | - |
| | 7T | | 5.8 - 9.4 | 7.9 - 12.7 | | - | - |
| | 8T | | 7.2 - 10 | 9.8 - 13.6 | | - | - |
| M8 | 4T | 1.25 | 7.2 - 14 | 9.8 - 19 | 1.00 | 12 - 17 | 16.3 - 23 |
| | 7T | | 17 - 22 | 23 - 29.8 | | 19 - 27 | 25.7 - 36.6 |
| | 8T | | 20 - 26 | 27.1 - 35.2 | | 22 - 31 | 29.8 - 42 |
| M10 | 4T | 1.50 | 20 - 25 | 27.1 - 33.9 | 1.25 | 20 - 29 | 27.1 - 39.3 |
| | 7T | | 34 - 40 | 46.1 - 54.2 | | 35 - 47 | 47.4 - 63.7 |
| | 8T | | 38 - 46 | 51.5 - 62.3 | | 40 - 52 | 54.2 - 70.5 |
| M12 | 4T | 1.75 | 28 - 34 | 37.9 - 46.1 | 1.25 | 31 - 41 | 42 - 55.6 |
| | 7T | | 51 - 59 | 69.1 - 79.9 | | 56 - 68 | 75.9 - 92.1 |
| | 8T | | 57 - 66 | 77.2 - 89.4 | | 62 - 75 | 84 - 101.6 |
| M14 | 4T | 2.00 | 49 - 56 | 66.4 - 75.9 | 1.50 | 52 - 64 | 70.5 - 86.7 |
| | 7T | | 81 - 93 | 109.8 - 126 | | 90 - 106 | 122 - 143.6 |
| | 8T | | 96 - 109 | 130.1 - 147.7 | | 107 - 124 | 145 - 168 |
| M16 | 4T | 2.00 | 67 - 77 | 90.8 - 104.3 | 1.50 | 69 - 83 | 93.5 - 112.5 |
| | 7T | | 116 - 130 | 157.2 - 176.2 | | 120 - 138 | 162.6 - 187 |
| | 8T | | 129 - 145 | 174.8 - 196.5 | | 140 - 158 | 189.7 - 214.1 |
| M18 | 4T | 2.00 | 88 - 100 | 119.2 - 136 | 1.50 | 100 - 117 | 136 - 158.5 |
| | 7T | | 150 - 168 | 203.3 - 227.6 | | 177 - 199 | 239.8 - 269.6 |
| | 8T | | 175 - 194 | 237.1 - 262.9 | | 202 - 231 | 273.7 - 313 |
| M20 | 4T | 2.50 | 108 - 130 | 146.3 - 176.2 | 1.50 | 132 - 150 | 178.9 - 203.3 |
| | 7T | | 186 - 205 | 252 - 277.8 | | 206 - 242 | 279.1 - 327.9 |
| | 8T | | 213 - 249 | 288.6 - 337.4 | | 246 - 289 | 333.3 - 391.6 |

NOMENCLATURE ET LISTE DES PIÈCES / PARTS BREAKDOWN & PART LIST
Tondeuse de finition 60" avec moteur Briggs Power Built 17.5CV # 700714-1
Finishing mower 60" with Briggs Power Built engine 17.5HP # 700714-1

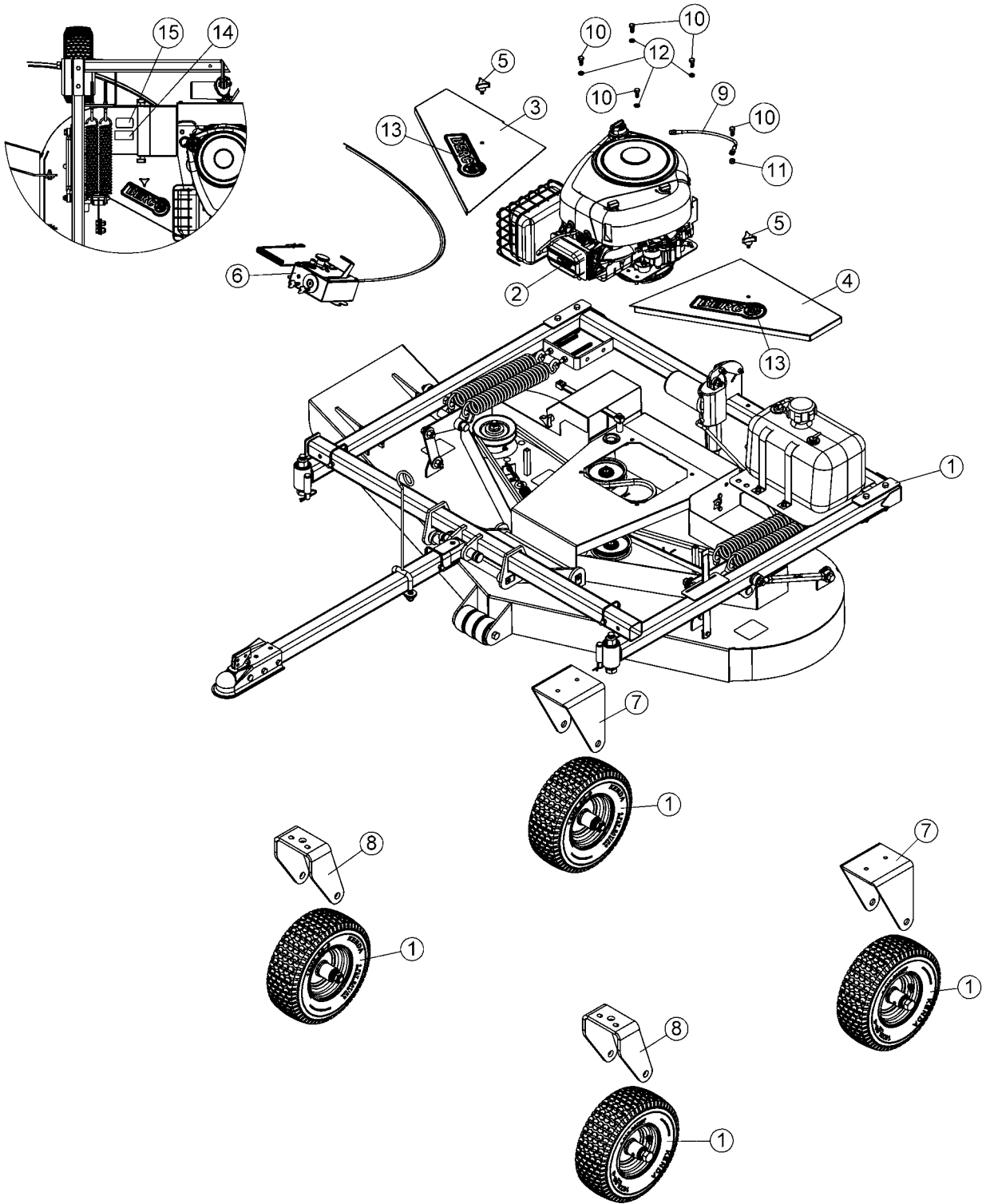

NOMENCLATURE ET LISTE DES PIÈCES / PARTS BREAKDOWN & PART LIST
Tondeuse de finition 60" avec moteur Briggs Power Built 17.5CV # 700714-1
Finishing mower 60" with Briggs Power Built engine 17.5HP # 700714-1

| REF. | ENGLISH DESCRIPTION | DESCRIPTION FRANÇAISE | QTY. | PART# |
|------|---|--|------|-------------------------|
| 1 | Finishing mower 60" | Tondeuse de finition 60" | 1 | 501335 |
| 2 | Briggs Power Built engine 17.5 HP with clutch | Moteur Briggs Power Built 17.5 CV avec embrayage | 1 | 501327 |
| 3 | Right lid | Couvercle droit | 1 | 108273-Y02 |
| 4 | Left lid | Couvercle gauche | 1 | 108274-Y02 |
| 5 | Knob | Bouton | 2 | 106861 |
| 6 | Control box assembly with cable | Boîte de contrôle assemblée avec câble | 1 | 501336 |
| 7 | Wheel fork | Fourche de roue | 2 | 108280-Y02 |
| 8 | Wheel fork | Fourche de roue | 2 | 108303-Y02 |
| 9 | Wire assembly | Fil assemblé | 1 | 107491 |
| 10 | Hex. bolt 5/16" n.c. x 3/4" GR5 | Boulon hex. 5/16" n.c. x 3/4" GR5 | 5 | O/L (300NC.5P_5-16x3-4) |
| 11 | Nylon Insert lock Nut 5/16" n.c. GR5 | Écrou à garniture de nylon 5/16" n.c. GR5 | 1 | O/L (335NC.P_5-16) |
| 12 | Lock washer 5/16" | Rondelle de blocage 5/16" | 4 | O/L (362.P_5-16) |
| 13 | Berco decal | Décalque Berco | 2 | 102471 |
| 14 | Serial number | Numéro de série | 1 | REF. |
| 15 | Made in Canada decal | Décalque Fabriqué au Canada | 1 | REF. |

O/L = Obtain Locally / Obtenir localement

Part numbers starting with **500XXX** are not available for sale, however, separate parts are available for sale individually.

Les numéros **500xxx** ne sont pas disponibles pour la vente. Au besoin, veuillez commander les numéros de pièces séparément.

NOMENCLATURE ET LISTE DES PIÈCES / PARTS BREAKDOWN & PART LIST

Tondeuse de finition 60" avec moteur commercial 20CV #700818

Finishing mower 60" with 20HP commercial engine #700818

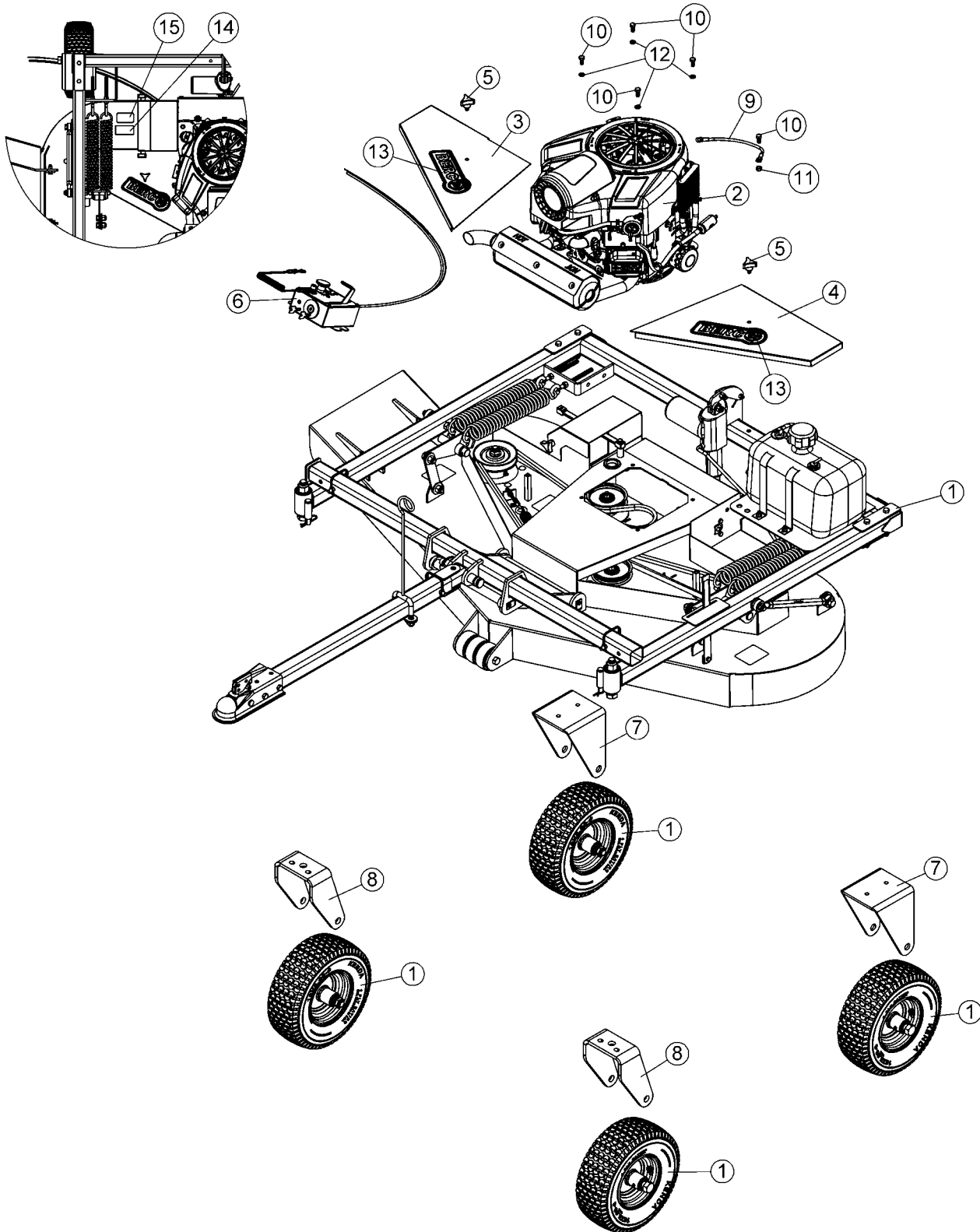

NOMENCLATURE ET LISTE DES PIÈCES / PARTS BREAKDOWN & PART LIST

Tondeuse de finition 60" avec moteur commercial 20CV #700818

Finishing mower 60" with 20HP commercial engine #700818

| REF. | ENGLISH DESCRIPTION | DESCRIPTION FRANÇAISE | QTY. | PART# |
|------|--------------------------------------|---|------|-------------------------|
| 1 | Finishing mower 60" | Tondeuse de finition 60" | 1 | 501335 |
| 2 | Briggs M40 20 HP engine with clutch | Moteur Briggs M40 20 CV avec embrayage | 1 | 501326 |
| 3 | Right lid | Couvercle droit | 1 | 108273-Y02 |
| 4 | Left lid | Couvercle gauche | 1 | 108274-Y02 |
| 5 | Knob | Bouton | 2 | 106861 |
| 6 | Control box assembly with cable | Boîte de contrôle assemblée avec câble | 1 | 501337 |
| 7 | Wheel fork | Fourche de roue | 2 | 108280-Y02 |
| 8 | Wheel fork | Fourche de roue | 2 | 108303-Y02 |
| 9 | Wire assembly | Fil assemblé | 1 | 107491 |
| 10 | Hex. bolt 5/16" n.c. x 3/4" GR5 | Boulon hex. 5/16" n.c. x 3/4" GR5 | 5 | O/L (300NC.5P_5-16x3-4) |
| 11 | Nylon Insert lock Nut 5/16" n.c. GR5 | Écrou à garniture de nylon 5/16" n.c. GR5 | 1 | O/L (335NC.P_5-16) |
| 12 | Lock washer 5/16" | Rondelle de blocage 5/16" | 4 | O/L (362.P_5-16) |
| 13 | Berco decal | Décalque Berco | 2 | 102471 |
| 14 | Serial number | Numéro de série | 1 | REF. |
| 15 | Made in Canada decal | Décalque Fabriqué au Canada | 1 | REF. |

O/L = Obtain Locally / Obtenir localement

Part numbers starting with **500XXX** are not available for sale, however, separate parts are available for sale individually.

Les numéros **500xxx** ne sont pas disponibles pour la vente. Au besoin, veuillez commander les numéros de pièces séparément.

NOMENCLATURE ET LISTE DES PIÈCES / PARTS BREAKDOWN & PART LIST

Tondeuse de finition 60" #501335

Finishing mower 60" #501335

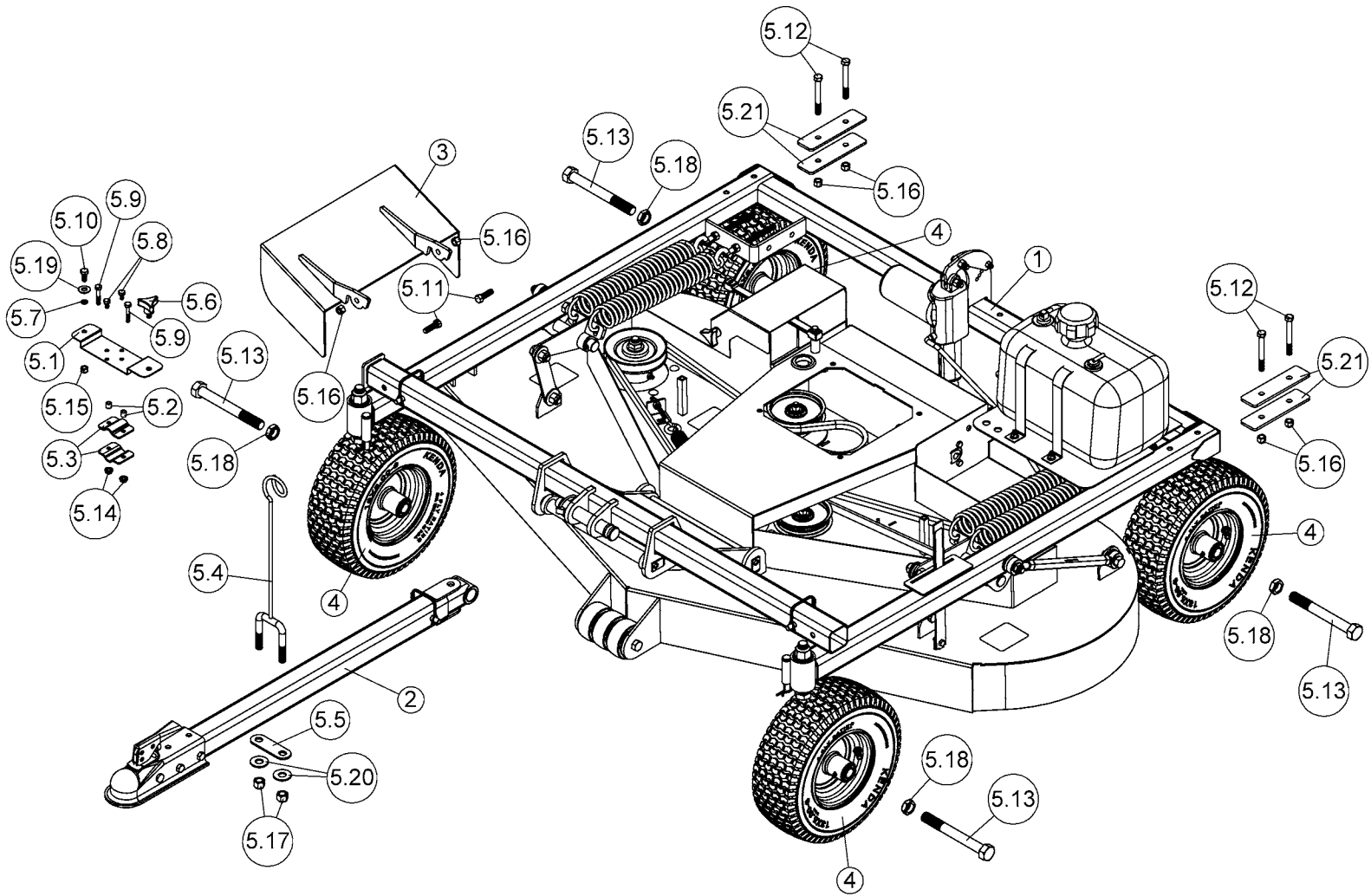

NOMENCLATURE ET LISTE DES PIÈCES / PARTS BREAKDOWN & PART LIST
Tondeuse de finition 60" #501335
Finishing mower 60" #501335

| REF. | ENGLISH DESCRIPTION | DESCRIPTION FRANÇAISE | QTY. | PART# |
|------|--|--|------|--------------------------|
| 1 | Mower assembly | Tondeuse assemblée | 1 | 501321 |
| 2 | Hitch bar assembly | Barre d'attache assemblée | 1 | 501023 |
| 3 | Mower deflector | Défecteur de tondeuse | 1 | 108311 |
| 4 | Wheel assembly | Roue assemblée | 4 | 107202 |
| 5 | Hardware bag | Sac de quincaillerie | 1 | 108305 |
| 5.1 | Box support | Support de la boîte | 1 | 108256 |
| 5.2 | Spacer | Espaceur | 2 | 103368 |
| 5.3 | Support bracket | Fixation du support | 2 | 103068 |
| 5.4 | Cable holder | Support de câble | 1 | 108285 |
| 5.5 | U-bolt plate | Plaque pour boulon en U | 1 | 108286 |
| 5.6 | Knob | Bouton | 1 | 106861 |
| 5.7 | O-Ring | Anneau d'étanchéité | 1 | 108313 |
| 5.8 | Hex. bolt 1/4" n.c. x 1/2" GR5 | Boulon hex. 1/4" n.c. x 1/2" GR5 | 2 | O/L (300NC.5P_1-4x1-2) |
| 5.9 | Hex. bolt 1/4" n.c. x 1 1/2" GR5 | Boulon hex. 1/4" n.c. x 1 1/2" GR5 | 2 | O/L (300NC.5P_1-4x1-1-2) |
| 5.10 | Hex. bolt 5/16" n.c. x 3/4" GR5 | Boulon hex. 5/16" n.c. x 3/4" GR5 | 1 | O/L (300NC.5P_5-16x3-4) |
| 5.11 | Hex. bolt 3/8" n.c. x 1 1/4" GR5 | Boulon hex. 3/8" n.c. x 1 1/4" GR5 | 2 | O/L (300NC.5P_3-8x1-1-4) |
| 5.12 | Hex. bolt 3/8" n.c. x 3 1/4" GR5 | Boulon hex. 3/8" n.c. x 3 1/4" GR5 | 4 | O/L (300NC.5P_3-8x3-1-4) |
| 5.13 | Hex. bolt 3/4" n.c. x 6 1/2" GR5 | Boulon hex. 3/4" n.c. x 6 1/2" GR5 | 4 | O/L (300NC.5P_3-4x6-1-2) |
| 5.14 | Flange nut 1/4" n.c. | Écrou à bride 1/4" n.c. | 2 | O/L (334NC.P_1-4) |
| 5.15 | Nylon Insert lock Nut 5/16" n.c. GR5 | Écrou à garniture de nylon 5/16" n.c. GR5 | 1 | O/L (335NC.P_5-16) |
| 5.16 | Nylon Insert lock Nut 3/8" n.c. | Écrou à garniture de nylon 3/8" n.c. | 6 | O/L (335NC.P_3-8) |
| 5.17 | Nylon Insert lock Nut 1/2" n.c. | Écrou à garniture de nylon 1/2" n.c. | 2 | O/L (335NC.P_1-2) |
| 5.18 | Nylon insert lock nut 3/4" n.c. (thin) GR5 | Écrou à garniture de nylon 3/4" n.c. (mince) GR5 | 4 | O/L (336NC.P_3-4) |
| 5.19 | Flat washer 3/8" hole | Rondelle plate 3/8" trou | 1 | O/L (360.P_3-8T) |
| 5.20 | Flat washer 9/16" hole | Rondelle plate 9/16" trou | 2 | O/L (360.P_9-16T) |
| 5.21 | Shim | Espaceur | 4 | 108310 |

O/L = Obtain Locally / Obtenir localement

Part numbers starting with **500XXX** are not available for sale, however, separate parts are available for sale individually.

Les numéros **500xxx** ne sont pas disponibles pour la vente. Au besoin, veuillez commander les numéros de pièces séparément.

NOMENCLATURE ET LISTE DES PIÈCES / PARTS BREAKDOWN & PART LIST
Moteur Briggs Power Built 17.5 CV avec embrayage #501327
Briggs Power Built engine 17.5 HP with clutch #501327

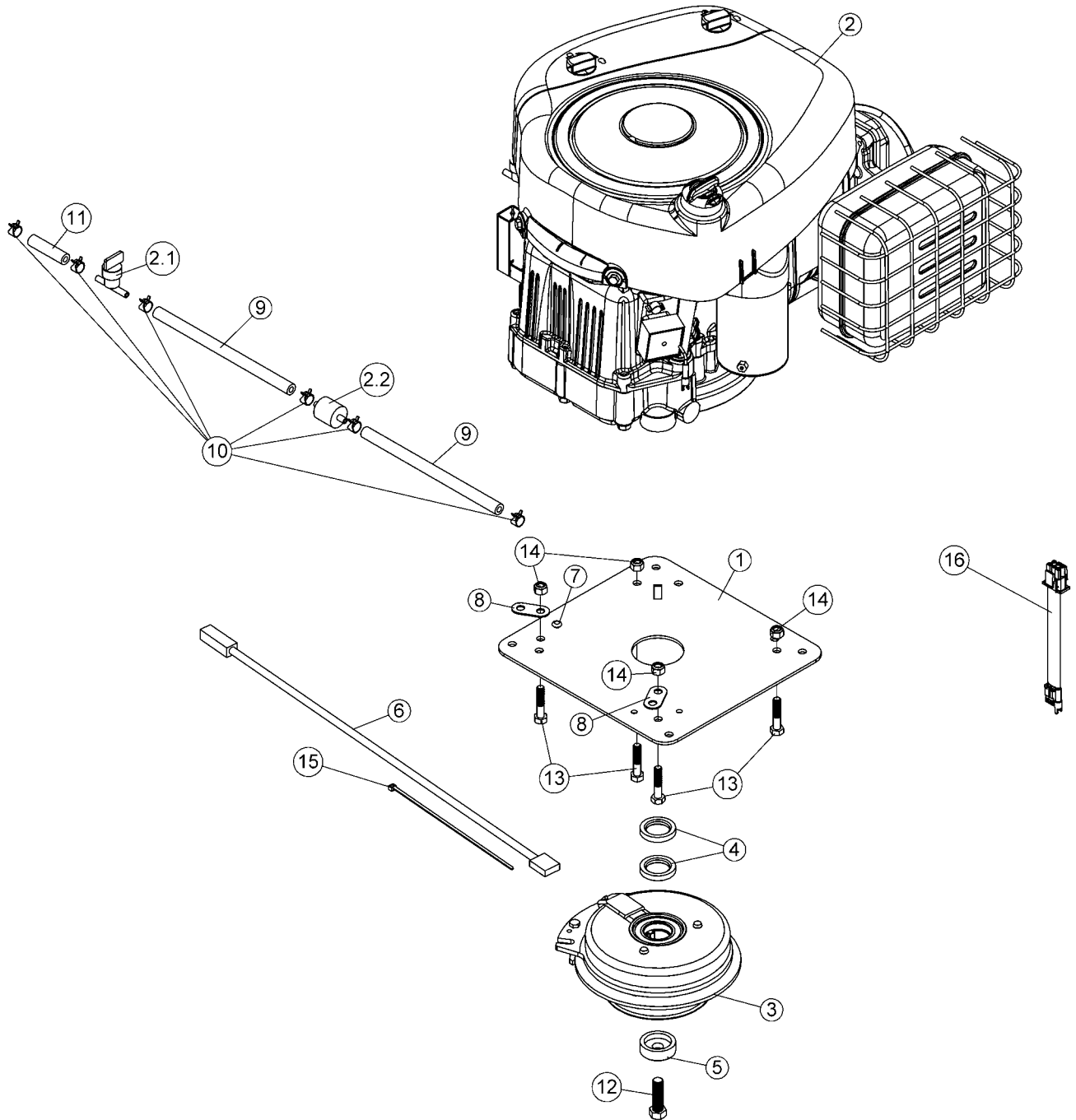

NOMENCLATURE ET LISTE DES PIÈCES / PARTS BREAKDOWN & PART LIST
Moteur Briggs Power Built 17.5 CV avec embrayage #501327
Briggs Power Built engine 17.5 HP with clutch #501327

| REF. | ENGLISH DESCRIPTION | DESCRIPTION FRANÇAISE | QTY. | PART# |
|------|--|--|------|---------------------------|
| 1 | Engine support | Support de moteur | 1 | 108262 |
| 2 | Briggs Power Built vertical engine 17.5 HP | Moteur vertical Briggs Power Built 17.5 CV | 1 | 107201 |
| 2.1 | Fuel valve from engine | Valve d'essence du moteur | 1 | - |
| 2.2 | Fuel filter from engine | Filtre à essence du moteur | 1 | - |
| 3 | Electric Clutch | Embrayage Électrique | 1 | 107459 |
| 4 | Clutch spacer | Espaceur d'embrayage | 2 | 106616 |
| 5 | Flange washer | Rondelle à bride | 1 | 103976 |
| 6 | Wire Assembly | Fil Assemblé | 1 | 106548 |
| 7 | Cable Tie Mount 0.19" | Support d'attache de nylon 0.19" | 1 | 108281 |
| 8 | Ground plate | Plaque de mise à terre | 2 | 108289 |
| 9 | Fuel hose EPA 1/4" | Tuyau à essence EPA 1/4" | 2 | 107572 |
| 10 | Spring action hose clamp for 1/2" hose | Collier de serrage à ressort pour tuyau 1/2" | 6 | 107269 |
| 11 | Fuel hose EPA 1/4" | Tuyau à essence EPA 1/4" | 1 | 107714 |
| 12 | Hex. bolt 7/16" n.f. x 1 1/2" GR5 | Boulon hex. 7/16" n.f. x 1 1/2" GR5 | 1 | O/L (300NF.5P_7-16x11-2) |
| 13 | Hex. bolt 5/16" n.c. x 1 1/2" | Boulon hex. 5/16" n.c. x 1 1/2" | 4 | O/L (300NC.5P_5-16x1-1-2) |
| 14 | Nylon Insert lock Nut 5/16" n.c. GR5 | Écrou à garniture de nylon 5/16" n.c. GR5 | 4 | O/L (335NC.P_5-16) |
| 15 | Tie wrap 8" | Attache de nylon 8" | 1 | O/L (426-8) |
| 16 | Wire assembly | Fil assemblé | 1 | 108291 |

O/L = Obtain Locally / Obtenir localement

Part numbers starting with **500XXX** are not available for sale, however, separate parts are available for sale individually.

Les numéros **500xxx** ne sont pas disponibles pour la vente. Au besoin, veuillez commander les numéros de pièces séparément.

NOMENCLATURE ET LISTE DES PIÈCES / PARTS BREAKDOWN & PART LIST

Moteur Briggs M40 20 CV avec embrayage #501326

Briggs M40 20 HP engine with clutch #501326

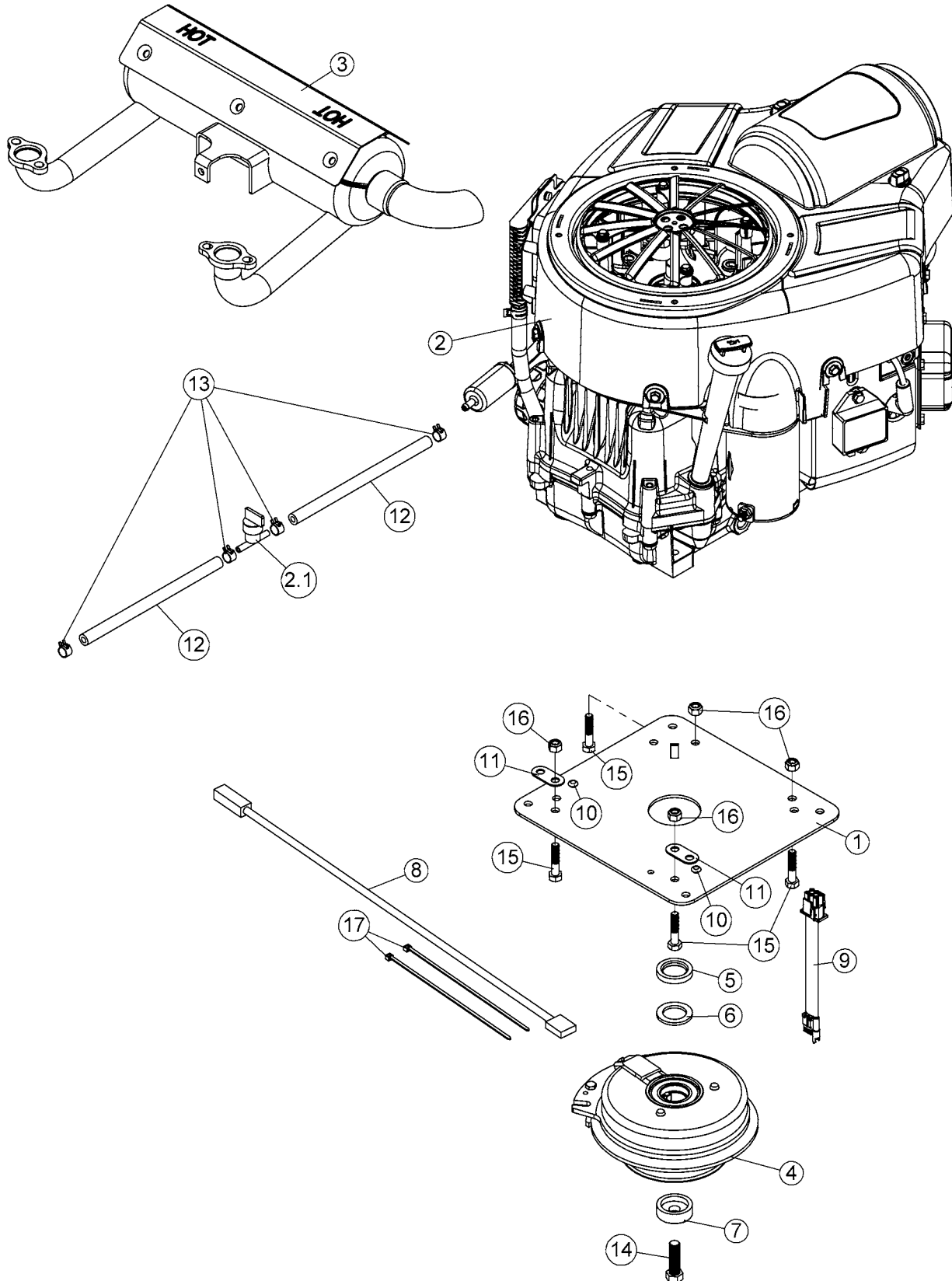

NOMENCLATURE ET LISTE DES PIÈCES / PARTS BREAKDOWN & PART LIST

Moteur Briggs M40 20 CV avec embrayage #501326

Briggs M40 20 HP engine with clutch #501326

| REF. | ENGLISH DESCRIPTION | DESCRIPTION FRANÇAISE | QTY. | PART# |
|------|--|--|------|---------------------------|
| 1 | Engine support | Support de moteur | 1 | 108262 |
| 2 | Briggs M40 vertical engine 20 HP | Moteur vertical Briggs M40 20 CV | 1 | 108221 |
| 2.1 | Fuel valve from engine | Valve d'essence du moteur | 1 | - |
| 3 | Muffler assembly | Silencieux assemblé | 1 | 108264 |
| 4 | Electric Clutch | Embrayage Électrique | 1 | 107459 |
| 5 | Clutch spacer | Espaceur d'embrayage | 1 | 106616 |
| 6 | Special flat washer | Rondelle plate spéciale | 1 | 106338 |
| 7 | Flange washer | Rondelle à bride | 1 | 103976 |
| 8 | Wire Assembly | Fil Assemblé | 1 | 106548 |
| 9 | Wire assembly | Fil assemblé | 1 | 108291 |
| 10 | Cable Tie Mount 0.19" | Support d'attache de nylon 0.19" | 2 | 108281 |
| 11 | Ground plate | Plaque de mise à terre | 2 | 108289 |
| 12 | Fuel hose EPA 1/4" | Tuyau à essence EPA 1/4" | 2 | 107572 |
| 13 | Spring action hose clamp for 1/2" hose | Collier de serrage à ressort pour tuyau 1/2" | 4 | 107269 |
| 14 | Hex. bolt 7/16" n.f. x 1 1/2" GR5 | Boulon hex. 7/16" n.f. x 1 1/2" GR5 | 1 | O/L (300NF.5P_7-16x11-2) |
| 15 | Hex. bolt 5/16" n.c. x 1 1/2" | Boulon hex. 5/16" n.c. x 1 1/2" | 4 | O/L (300NC.5P_5-16x1-1-2) |
| 16 | Nylon Insert lock Nut 5/16" n.c. GR5 | Écrou à garniture de nylon 5/16" n.c. GR5 | 4 | O/L (335NC.P_5-16) |
| 17 | Tie wrap 8" | Attache de nylon 8" | 2 | O/L (426-8) |

O/L = Obtain Locally / Obtenir localement

Part numbers starting with **500XXX** are not available for sale, however, separate parts are available for sale individually.

Les numéros **500xxx** ne sont pas disponibles pour la vente. Au besoin, veuillez commander les numéros de pièces séparément.

NOMENCLATURE ET LISTE DES PIÈCES / PARTS BREAKDOWN & PART LIST

Boîte de contrôle assemblée avec câble #501336

Control box assembly with cable #501336

| REF. | ENGLISH DESCRIPTION | DESCRIPTION FRANÇAISE | QTY. | PART# |
|------|---------------------------------|-----------------------------------|------|-------------------------|
| 1 | Control box assembly | Boîte de contrôle assemblée | 1 | 501325 |
| 2 | Spring bracket | Fixation du ressort | 1 | 102210 |
| 3 | Throttle arm | Bras d'accélérateur | 1 | 102541 |
| 4 | Handle grip | Poignée de plastique | 1 | 102546 |
| 5 | Cable shield | Gaine de câble | 1 | 107582 |
| 6 | Inner wire | Broche intérieure | 1 | 107583 |
| 7 | Hex. bolt 5/16" n.c. x 3/4" GR5 | Boulon hex. 5/16" n.c. x 3/4" GR5 | 2 | O/L (300NC.5P_5-16x3-4) |
| 8 | Flange nut 5/16" n.c. | Écrou à bride 5/16" n.c. | 1 | O/L (334NC.P_5-16) |
| 9 | Stover lock nut 5/16" n.c. | Écrou de blocage 5/16" n.c. | 1 | O/L (338NC.P_5-16) |
| 10 | Flat washer 3/8" hole | Rondelle plate 3/8" trou | 1 | O/L (360.P_3-8T) |
| 11 | Belleville washer 3/8" | Rondelle Belleville 3/8" | 1 | 102144 |
| 12 | Box | Boîte | 1 | 108255 |
| 13 | Metal screw P.H. #8 x 1/4" | Vis à métal P.H. #8 x 1/4" | 4 | O/L (400.P_8x1-4) |

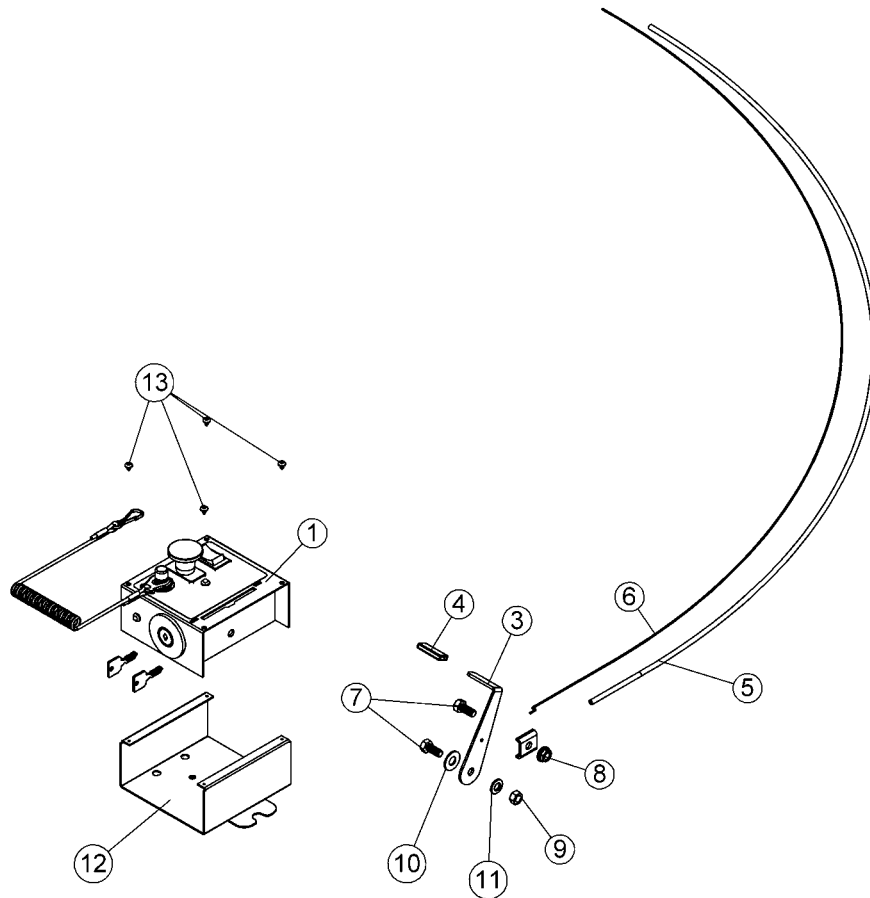

O/L = Obtain Locally / Obtenir localement

Part numbers starting with **500XXX** are not available for sale, however, separate parts are available for sale individually.

Les numéros **500xxx** ne sont pas disponibles pour la vente. Au besoin, veuillez commander les numéros de pièces séparément.

NOMENCLATURE ET LISTE DES PIÈCES / PARTS BREAKDOWN & PART LIST

Boîte de contrôle assemblée avec câble #501337

Control box assembly with cable #501337

| REF. | ENGLISH DESCRIPTION | DESCRIPTION FRANÇAISE | QTY. | PART# |
|------|---------------------------------|-----------------------------------|------|-------------------------|
| 1 | Control box assembly | Boîte de contrôle assemblée | 1 | 501325 |
| 2 | Spring bracket | Fixation du ressort | 1 | 102210 |
| 3 | Throttle arm | Bras d'accélérateur | 1 | 102541 |
| 4 | Handle grip | Poignée de plastique | 1 | 102546 |
| 5 | Cable shield | Gaine de câble | 1 | 108294 |
| 6 | Inner wire | Broche intérieure | 1 | 108295 |
| 7 | Hex. bolt 5/16" n.c. x 3/4" GR5 | Boulon hex. 5/16" n.c. x 3/4" GR5 | 2 | O/L (300NC.5P_5-16x3-4) |
| 8 | Flange nut 5/16" n.c. | Écrou à bride 5/16" n.c. | 1 | O/L (334NC.P_5-16) |
| 9 | Stover lock nut 5/16" n.c. | Écrou de blocage 5/16" n.c. | 1 | O/L (338NC.P_5-16) |
| 10 | Flat washer 3/8" hole | Rondelle plate 3/8" trou | 1 | O/L (360.P_3-8T) |
| 11 | Belleville washer 3/8" | Rondelle Belleville 3/8" | 1 | 102144 |
| 12 | Box | Boîte | 1 | 108255 |
| 13 | Metal screw P.H. #8 x 1/4" | Vis à métal P.H. #8 x 1/4" | 4 | O/L (400.P_8x1-4) |

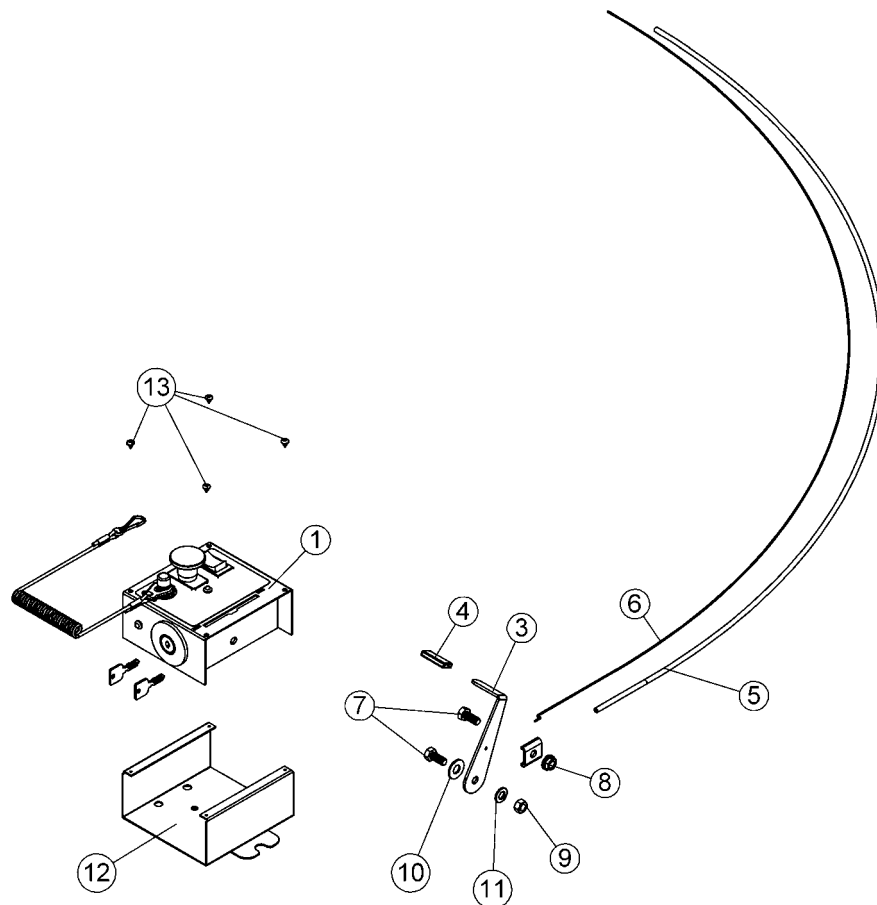

O/L = Obtain Locally / Obtenir localement

Part numbers starting with **500XXX** are not available for sale, however, separate parts are available for sale individually.

Les numéros **500xxx** ne sont pas disponibles pour la vente. Au besoin, veuillez commander les numéros de pièces séparément.

NOMENCLATURE ET LISTE DES PIÈCES / PARTS BREAKDOWN & PART LIST

Boîte de contrôle assemblée #501325

Control box assembly #501325

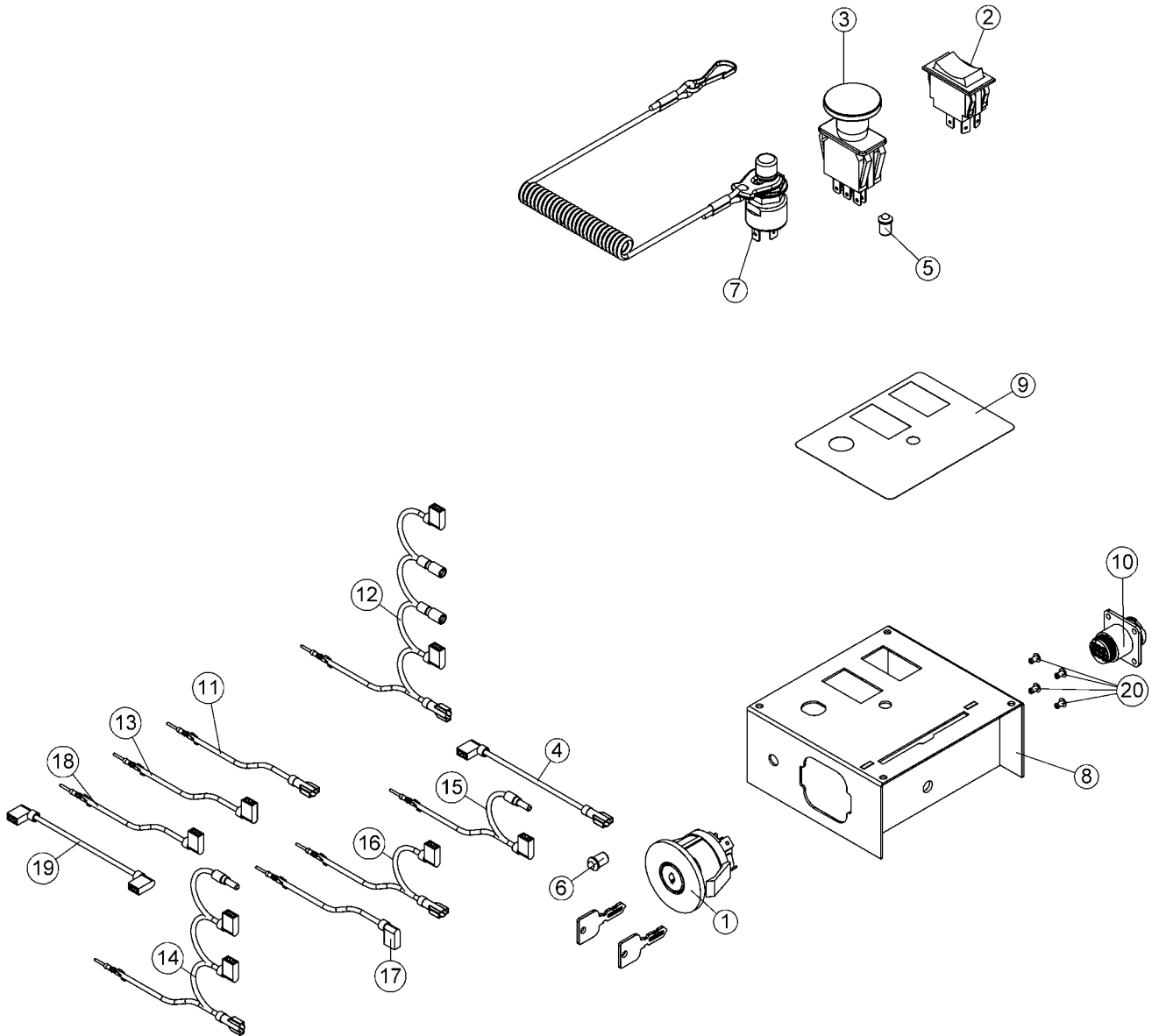

NOMENCLATURE ET LISTE DES PIÈCES / PARTS BREAKDOWN & PART LIST
Boîte de contrôle assemblée #501325
Control box assembly #501325

| REF. | ENGLISH DESCRIPTION | DESCRIPTION FRANÇAISE | QTY. | PART# |
|------|--------------------------------------|--|------|--------------------|
| 1 | Ignition switch | Commutateur d'ignition | 1 | 104015 |
| 2 | Switch | Commutateur | 1 | 107446 |
| 3 | Emergency switch | Interrupteur d'urgence | 1 | 107447 |
| 4 | Wire assembly | Fil assemblé | 1 | 107448 |
| 5 | Warning light | Avertisseur lumineux | 1 | 107456 |
| 6 | Warning light | Avertisseur lumineux | 1 | 107457 |
| 7 | Emergency switch with lanyard | Interrupteur d'urgence avec cordon | 1 | 107472 |
| 8 | Box cover | Couvercle de la boîte | 1 | 107579 |
| 9 | Control box decal | Décalque de la boîte de contrôle | 1 | 107628 |
| 10 | Circular connector flange receptacle | Connecteur circulaire réceptacle à bride | 1 | 107700 |
| 11 | Wire assembly | Fil assemblé | 1 | 107703 |
| 12 | Wire assembly | Fil assemblé | 1 | 107704 |
| 13 | Wire assembly | Fil assemblé | 1 | 107705 |
| 14 | Wire assembly | Fil assemblé | 1 | 107706 |
| 15 | Wire assembly | Fil assemblé | 1 | 107707 |
| 16 | Wire assembly | Fil assemblé | 1 | 107708 |
| 17 | Wire assembly | Fil assemblé | 1 | 107709 |
| 18 | Wire assembly | Fil assemblé | 1 | 107710 |
| 19 | Wire assembly | Fil assemblé | 1 | 107713 |
| 20 | Pop-rivet 1/8" x 3/16" no.AD-43BS | Rivet pop 1/8" x 3/16" no.AD-43BS | 4 | O/L (415_1-8x3-16) |

O/L = Obtain Locally / Obtenir localement

Part numbers starting with **500XXX** are not available for sale, however, separate parts are available for sale individually.

Les numéros **500xxx** ne sont pas disponibles pour la vente. Au besoin, veuillez commander les numéros de pièces séparément.

NOMENCLATURE ET LISTE DES PIÈCES / PARTS BREAKDOWN & PART LIST
Tondeuse assemblée #501321
Mower assembly #501321

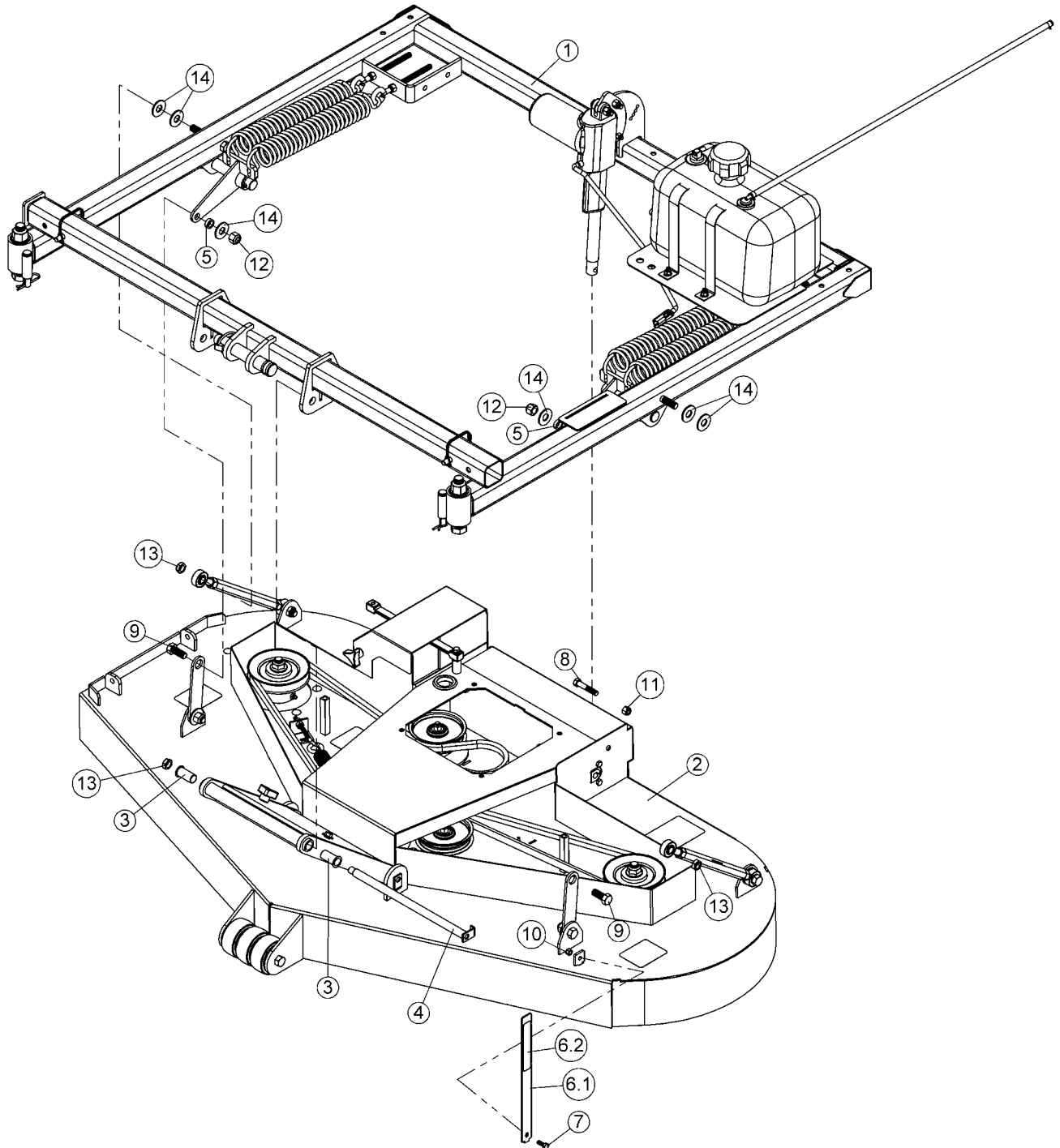

NOMENCLATURE ET LISTE DES PIÈCES / PARTS BREAKDOWN & PART LIST
Tondeuse assemblée #501321
Mower assembly #501321

| REF. | ENGLISH DESCRIPTION | DESCRIPTION FRANÇAISE | QTY. | PART# |
|------|--|--|------|--------------------------|
| 1 | Support assembly | Support assemblé | 1 | 501322 |
| 2 | Deck assembly | Plate-forme assemblée | 1 | 501332 |
| 3 | Bushing | Coussinet | 2 | 104376 |
| 4 | Pivot pin | Goupille de pivot | 1 | 105857 |
| 5 | Sleeve | Douille | 2 | 102909 |
| 6 | Height scale #107555 with decals | Échelle de hauteur #107555 avec décalques | 1 | 107633 |
| 6.1 | Height scale | Échelle de hauteur | 1 | 107555 |
| 6.2 | Scaled decal | Décalque gradué | 2 | 107629 |
| 7 | Hex. bolt 1/4" n.c. x 3/4" GR5 | Boulon hex. 1/4" n.c. x 3/4" GR5 | 1 | O/L (300NC.5P_1-4x3-4) |
| 8 | Hex. bolt 3/8" n.c. x 2" GR5 | Boulon hex. 3/8" n.c. x 2" GR5 | 1 | O/L (300NC.5P_3-8x2) |
| 9 | Hex. bolt 1/2" n.c. x 1 1/4" GR5 | Boulon hex. 1/2" n.c. x 1 1/4" GR5 | 2 | O/L (300NC.5P_1-2x1-1-4) |
| 10 | Nylon Insert lock Nut 1/4" n.c. | Écrou à garniture de nylon 1/4" n.c. | 1 | O/L (335NC.P_1-4) |
| 11 | Nylon Insert lock Nut 3/8" n.c. | Écrou à garniture de nylon 3/8" n.c. | 1 | O/L (335NC.P_3-8) |
| 12 | Nylon Insert lock Nut 1/2" n.c. | Écrou à garniture de nylon 1/2" n.c. | 2 | O/L (335NC.P_1-2) |
| 13 | Nylon insert lock nut 1/2" n.c. (thin) | Écrou à garniture de nylon 1/2" n.c. (mince) | 3 | O/L (336NC.P_1-2) |
| 14 | Flat washer 9/16" hole | Rondelle plate 9/16" trou | 6 | O/L (360.P_9-16T) |

O/L = Obtain Locally / Obtenir localement

Part numbers starting with **500xxx** are not available for sale, however, separate parts are available for sale individually.

Les numéros **500xxx** ne sont pas disponibles pour la vente. Au besoin, veuillez commander les numéros de pièces séparément.

NOMENCLATURE ET LISTE DES PIÈCES / PARTS BREAKDOWN & PART LIST
Barre d'attache assemblée #501023
Hitch bar assembly #501023

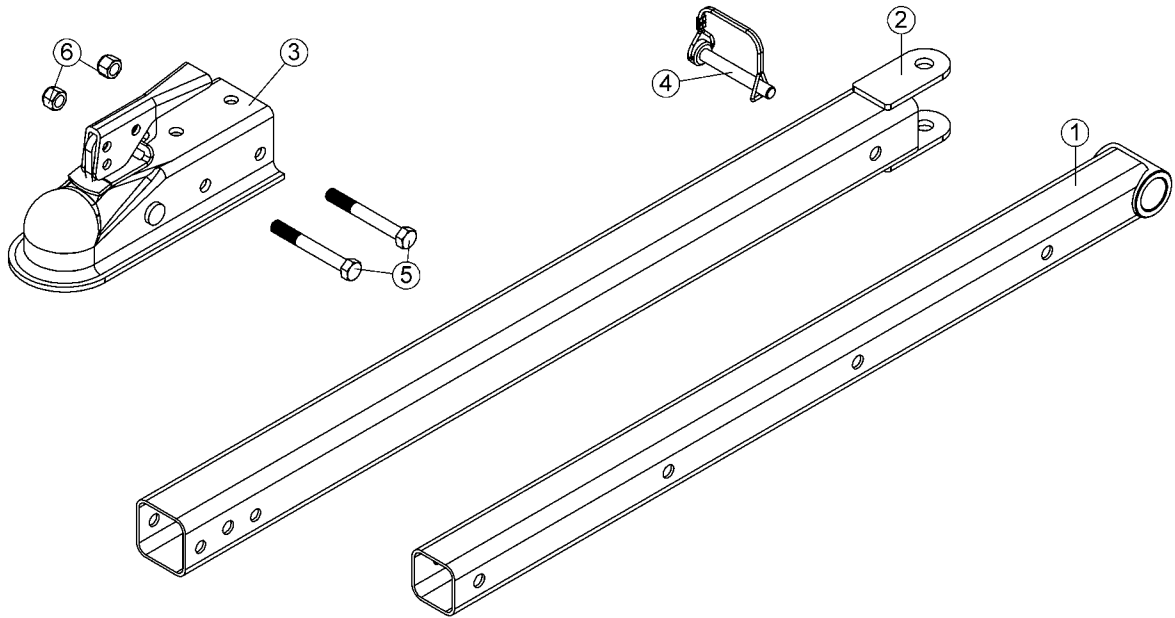

NOMENCLATURE ET LISTE DES PIÈCES / PARTS BREAKDOWN & PART LIST

Barre d'attache assemblée #501023

Hitch bar assembly #501023

| REF. | ENGLISH DESCRIPTION | DESCRIPTION FRANÇAISE | QTY. | PART# |
|------|---------------------------------|--------------------------------------|------|----------------------|
| 1 | Hitch arm extension | Extension du bras d'attache | 1 | 107574 |
| 2 | Hitch arm | Bras d'attache | 1 | 107573 |
| 3 | Hitch | Attache | 1 | 106130 |
| 4 | Lock pin | Tige de verrouillage | 1 | 103563 |
| 5 | Hex. bolt 3/8" n.c. x 3" GR5 | Boulon hex. 3/8" n.c. x 3" GR5 | 2 | O/L (300NC.5P_3-8x3) |
| 6 | Nylon Insert lock Nut 3/8" n.c. | Écrou à garniture de nylon 3/8" n.c. | 2 | O/L (335NC.P_3-8) |

O/L = Obtain Locally / Obtenir localement

Part numbers starting with **500XXX** are not available for sale, however, separate parts are available for sale individually.Les numéros **500xxx** ne sont pas disponibles pour la vente. Au besoin, veuillez commander les numéros de pièces séparément.

NOMENCLATURE ET LISTE DES PIÈCES / PARTS BREAKDOWN & PART LIST

Support assemblé #501322

Support assembly #501322

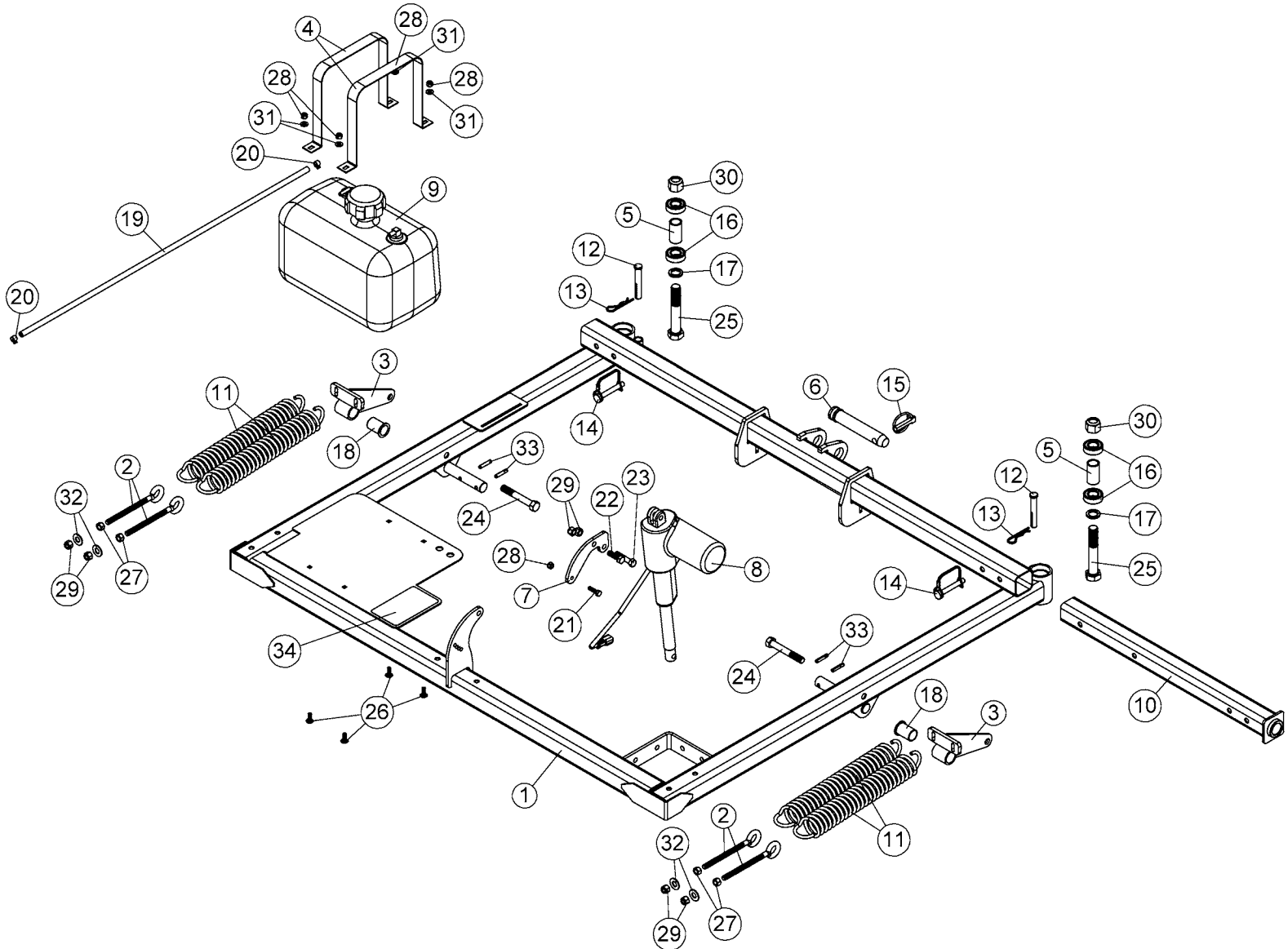

NOMENCLATURE ET LISTE DES PIÈCES / PARTS BREAKDOWN & PART LIST
Support assemblé #501322
Support assembly #501322

| REF. | ENGLISH DESCRIPTION | DESCRIPTION FRANÇAISE | QTY. | PART# |
|------|---|---|------|--------------------------|
| 1 | Support frame | Châssis de support | 1 | 108234 |
| 2 | Eye bolt | Boulon à oeillet | 4 | 108237 |
| 3 | Spring lever | Levier de ressort | 2 | 108238 |
| 4 | Fuel tank tie-down | Attache reservoir | 2 | 108248 |
| 5 | Sleeve | Douille | 2 | 108304 |
| 6 | Top link pin | Goupille de liaison supérieure | 1 | 107530 |
| 7 | Levier d'attache | Fastening lever | 1 | 107532 |
| 8 | Electric actuator | Actuateur électrique | 1 | 107156 |
| 9 | 2.5 Gallon EPA gasoline tank | Réservoir à essence 2.5 gallon EPA | 1 | 107264 |
| 10 | Extension arm | Bras d'extension | 1 | 107528 |
| 11 | Spring | Ressort | 4 | 102918 |
| 12 | Pin | Goupille | 2 | 108064 |
| 13 | Hair pin 3mm | Goupille à ressort 3mm | 2 | 102617 |
| 14 | Lock pin | Tige de verrouillage | 2 | 103563 |
| 15 | Lynch pin | Goupille à anneau | 1 | 106894 |
| 16 | Bearing | Roulement à billes | 4 | 102758 |
| 17 | Washer | Rondelle | 2 | 104113 |
| 18 | Bushing | Coussinet | 2 | 106435 |
| 19 | Low pressure fuel hose EPA 3/16" | Tuyau à essence basse pression EPA 3/16" | 1 | 108284 |
| 20 | Spring action hose clamp for 7/16" hose | Collier de serrage à ressort pour tuyau 7/16" | 2 | 107310 |
| 21 | Hex. bolt 1/4" n.c. x 1" GR5 | Boulon hex. 1/4" n.c. x 1" GR5 | 1 | O/L (300NC.5P_1-4x1) |
| 22 | Hex. bolt 3/8" n.c. x 1 1/4" GR5 | Boulon hex. 3/8" n.c. x 1 1/4" GR5 | 1 | O/L (300NC.5P_3-8x1-1-4) |
| 23 | Hex. bolt 3/8" n.c. x 1 3/4" GR5 | Boulon hex. 3/8" n.c. x 1 3/4" GR5 | 1 | O/L (300NC.5P_3-8x1-3-4) |
| 24 | Hex. bolt 1/2" n.c. x 3 1/2" GR5 | Boulon hex. 1/2" n.c. x 3 1/2" GR5 | 2 | O/L (300NC.5P_1-2x3-1-2) |
| 25 | Hex. bolt 3/4" n.c. x 4 1/2" GR5 | Boulon hex. 3/4" n.c. x 4 1/2" GR5 | 2 | O/L (300NC.5P_3-4x4-1-2) |
| 26 | Carriage bolt 1/4" n.c. x 3/4" GR5 | Boulon à carrosserie 1/4" n.c. x 3/4" GR5 | 4 | O/L (320NC.5P_1-4x3-4) |
| 27 | Hex. nut 3/8" n.c. | Écrou hex. 3/8" n.c. | 4 | O/L (330NC.P_3-8) |
| 28 | Nylon Insert lock Nut 1/4" n.c. | Écrou à garniture de nylon 1/4" n.c. | 5 | O/L (335NC.P_1-4) |
| 29 | Nylon Insert lock Nut 3/8" n.c. | Écrou à garniture de nylon 3/8" n.c. | 6 | O/L (335NC.P_3-8) |
| 30 | Nylon Insert lock Nut 3/4" n.c. | Écrou à garniture de nylon 3/4" n.c. | 2 | O/L (335NC.P_3-4) |
| 31 | Flat washer 1/4" hole | Rondelle plate 1/4" trou | 4 | O/L (360.P_1-4T) |
| 32 | Flat washer 7/16" hole | Rondelle plate 7/16" trou | 4 | O/L (360.P_7-16T) |
| 33 | Roll pin 1/4" x 1 1/4" | Goupille roulée 1/4" x 1 1/4" | 4 | O/L (377.N_1-4x1-1-4) |
| 34 | Decal fuel recommandations | Décalque recommandations carburant | 1 | 108261 |

O/L = Obtain Locally / Obtenir localement

Part numbers starting with **500XXX** are not available for sale, however, separate parts are available for sale individually.

Les numéros **500xxx** ne sont pas disponibles pour la vente. Au besoin, veuillez commander les numéros de pièces séparément.

NOMENCLATURE ET LISTE DES PIÈCES / PARTS BREAKDOWN & PART LIST
Plate-forme assemblée #501332
Deck assembly #501332

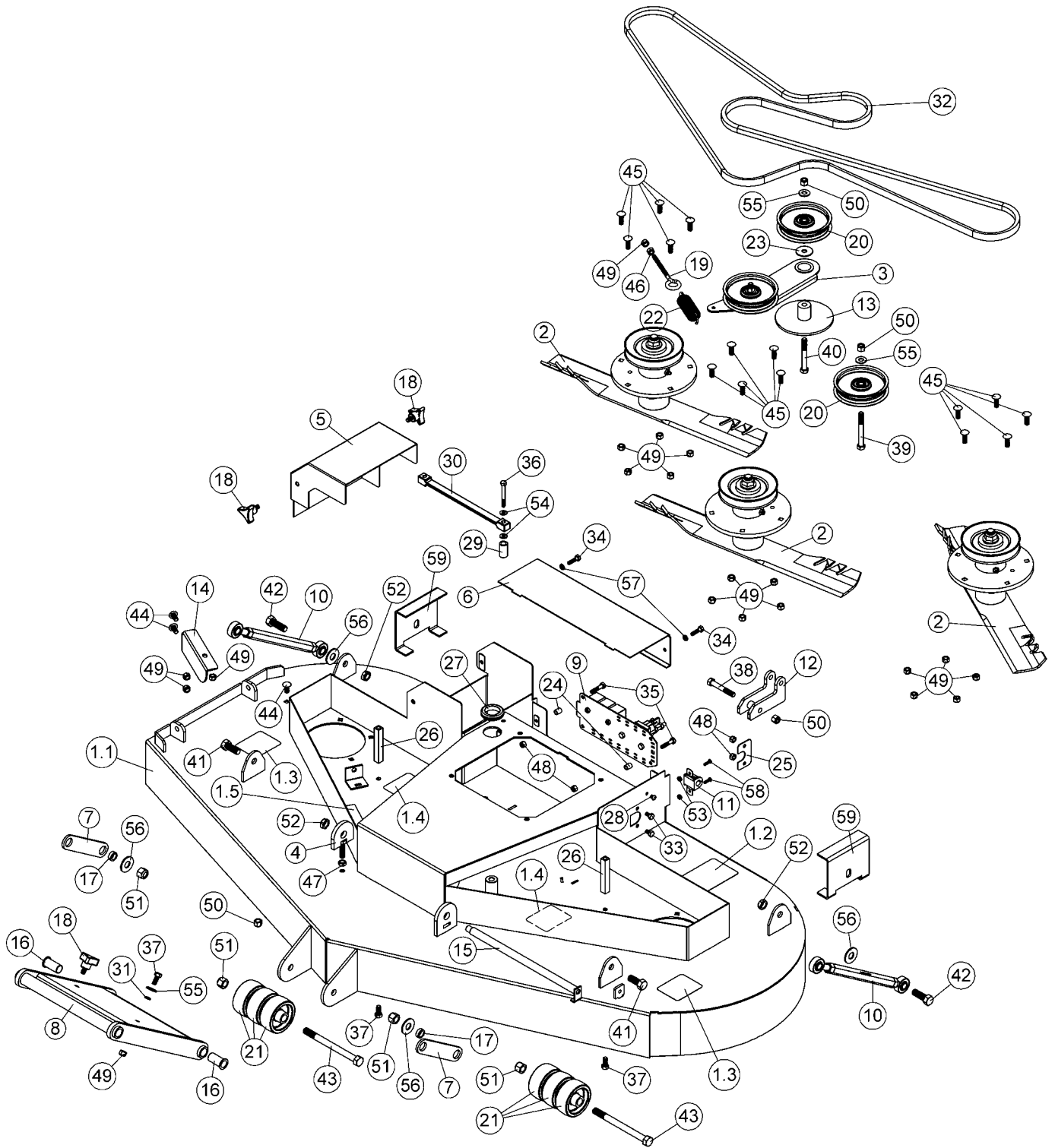

NOMENCLATURE ET LISTE DES PIÈCES / PARTS BREAKDOWN & PART LIST
Plate-forme assemblée #501332
Deck assembly #501332

| REF. | ENGLISH DESCRIPTION | DESCRIPTION FRANÇAISE | QTY. | PART# |
|------|--|--|------|--------|
| 1 | Mower frame #108239 with safety decals | Châssis tondeuse #108239 a/ décal. de séc. | 1 | 108265 |
| 1.1 | Mower frame | Châssis de la tondeuse | 1 | 108239 |
| 1.2 | General message mower decal | Décalque tondeuse message général | 1 | 107585 |
| 1.3 | Mower projection decal | Decalque projection tondeuse | 2 | 107584 |
| 1.4 | Decal danger belts | Decalque danger courroies | 2 | 105128 |
| 1.5 | Decal belt | Décalque courroie | 1 | 108366 |
| 2 | Spindle assembly | Moyeu assemblé | 3 | 501333 |
| 3 | Tensioner assembly | Bras de tension assemblé | 1 | 501334 |
| 4 | Arm support | Support de bras | 1 | 108276 |
| 5 | Battery guard | Garde de la batterie | 1 | 108277 |
| 6 | Guard | Garde | 1 | 108278 |
| 7 | Link | Lien | 2 | 108279 |
| 8 | Bras de support avant | Front support arm | 1 | 108241 |
| 9 | Electric board | Panneau électrique | 1 | 108236 |
| 10 | Rod end assembly | Rotule assemblé | 2 | 108270 |
| 11 | Wire clamp | Serre-fils | 1 | 108259 |
| 12 | Lift lever | Levier de relevage | 1 | 107537 |
| 13 | Pulley support | Support de poulie | 1 | 107538 |
| 14 | Baffle | Défecteur | 1 | 107539 |
| 15 | Pivot pin | Goupille de pivot | 1 | 105857 |
| 16 | Bushing | Coussinet | 2 | 104376 |
| 17 | Sleeve | Douille | 2 | 102909 |
| 18 | Knob | Bouton | 3 | 106861 |
| 19 | Eye bolt | Boulon à oeillet | 1 | 102087 |
| 20 | Flat pulley | Poulie plate | 2 | 102300 |
| 21 | Wheel | Roue | 6 | 107543 |
| 22 | Spring | Ressort | 1 | 107545 |
| 23 | Spacer | Espaceur | 1 | 107541 |
| 24 | Spacer | Espaceur | 2 | 103361 |
| 25 | Plate | Plaque | 1 | 108290 |
| 26 | Cover support | Support de couvercle | 2 | 108293 |
| 27 | Grommet | Oeillet | 1 | 107365 |

O/L = Obtain Locally / Obtenir localement

Part numbers starting with **500XXX** are not available for sale, however, separate parts are available for sale individually.

NOMENCLATURE ET LISTE DES PIÈCES / PARTS BREAKDOWN & PART LIST
Plate-forme assemblée #501332
Deck assembly #501332

| REF. | ENGLISH DESCRIPTION | DESCRIPTION FRANÇAISE | QTY. | PART# |
|------|---|--|------|--------------------------|
| 28 | Cable Tie Mount 0.19" | Support d'attache de nylon 0.19" | 1 | 108281 |
| 29 | Sleeve | Douille | 1 | 102418 |
| 30 | Rubber strap | Sangle en caoutchouc | 1 | 107363 |
| 31 | O-Ring | Anneau d'étanchéité | 1 | 108313 |
| 32 | V-belt, B-124 | Courroie en V, B-124 | 1 | 102484 |
| 33 | Hex. bolt 1/4" n.c. x 1/2" GR5 | Boulon hex. 1/4" n.c. x 1/2" GR5 | 2 | O/L (300NC.5P_1-4x1-2) |
| 34 | Hex. bolt 1/4" n.c. x 1" GR5 | Boulon hex. 1/4" n.c. x 1" GR5 | 2 | O/L (300NC.5P_1-4x1) |
| 35 | Hex. bolt 1/4" n.c. x 1 1/4" GR5 | Boulon hex. 1/4" n.c. x 1 1/4" GR5 | 2 | O/L (300NC.5P_1-4x1-1-4) |
| 36 | Hex. bolt 1/4" n.c. x 2 1/4" GR5 | Boulon hex. 1/4" n.c. x 2 1/4" GR5 | 1 | O/L (300NC.5P_1-4x2-1-4) |
| 37 | Hex. bolt 5/16" n.c. x 3/4" GR5 | Boulon hex. 5/16" n.c. x 3/4" GR5 | 3 | O/L (300NC.5P_5-16x3-4) |
| 38 | Hex. bolt 3/8" n.c. x 2 1/2" GR5 | Boulon hex. 3/8" n.c. x 2 1/2" GR5 | 1 | O/L (300NC.5P_3-8x2-1-2) |
| 39 | Hex. bolt 3/8" n.c. x 3 1/4" GR5 | Boulon hex. 3/8" n.c. x 3 1/4" GR5 | 1 | O/L (300NC.5P_3-8x3-1-4) |
| 40 | Hex. bolt 3/8" n.c. x 3" GR5 | Boulon hex. 3/8" n.c. x 3" GR5 | 1 | O/L (300NC.5P_3-8x3) |
| 41 | Hex. bolt 1/2" n.c. x 1 1/4" GR5 | Boulon hex. 1/2" n.c. x 1 1/4" GR5 | 2 | O/L (300NC.5P_1-2x1-1-4) |
| 42 | Hex. bolt 1/2" n.c. x 1 1/2" GR5 | Boulon hex. 1/2" n.c. x 1 1/2" GR5 | 2 | O/L (300NC.5P_1-2x1-1-2) |
| 43 | Hex. bolt 1/2" n.c. x 6" GR5 | Boulon hex. 1/2" n.c. x 6" GR5 | 2 | O/L (300NC.5P_1-2x6) |
| 44 | Carriage bolt 5/16" n.c. x 3/4 " GR5 | Boulon à carrosserie 5/16" n.c. x 3/4 " GR5 | 3 | O/L (320NC.5P_5-16x3-4) |
| 45 | Carriage bolt 5/16" n.c. x 1 " GR5 | Boulon à carrosserie 5/16" n.c. x 1 " GR5 | 15 | O/L (320NC.5P_5-16x1) |
| 46 | Hex. nut 5/16" n.c. GR5 | Écrou hex. 5/16" n.c. GR5 | 1 | O/L (330NC.P_5-16) |
| 47 | Hex. nut 3/8" n.c. (thin) | Écrou hex. 3/8" n.c. (mince) | 1 | O/L (331NC.P_3-8) |
| 48 | Nylon Insert lock Nut 1/4" n.c. | Écrou à garniture de nylon 1/4" n.c. | 4 | O/L (335NC.P_1-4) |
| 49 | Nylon Insert lock Nut 5/16" n.c. GR5 | Écrou à garniture de nylon 5/16" n.c. GR5 | 20 | O/L (335NC.P_5-16) |
| 50 | Nylon Insert lock Nut 3/8" n.c. | Écrou à garniture de nylon 3/8" n.c. | 4 | O/L (335NC.P_3-8) |
| 51 | Nylon Insert lock Nut 1/2" n.c. | Écrou à garniture de nylon 1/2" n.c. | 4 | O/L (335NC.P_1-2) |
| 52 | Nylon insert lock nut 1/2" n.c. (thin) | Écrou à garniture de nylon 1/2" n.c. (mince) | 3 | O/L (336NC.P_1-2) |
| 53 | Nylon insert locknut #8 x 32 (thin) GR2 | Écrou à garni. de nylon #8 x 32 (mince) GR2 | 2 | O/L (336NC.P_#8x32) |
| 54 | Flat washer 1/4" hole | Rondelle plate 1/4" trou | 2 | O/L (360.P_1-4T) |
| 55 | Flat washer 3/8" hole | Rondelle plate 3/8" trou | 3 | O/L (360.P_3-8T) |
| 56 | Flat washer 9/16" hole | Rondelle plate 9/16" trou | 4 | O/L (360.P_9-16T) |
| 57 | Lock washer 1/4" | Rondelle de blocage 1/4" | 2 | O/L (362.P_1-4) |
| 58 | Machine screw Pan head no.8 x 32 x 5/8" | Vis mécanique à tête Pan no.8 x 32 x 5/8" | 2 | O/L (395NC.P_#8x32x5-8) |
| 59 | Stopper | Butée | 2 | 108364 |

O/L = Obtain Locally / Obtenir localement

Part numbers starting with **500XXX** are not available for sale, however, separate parts are available for sale individually.

Les numéros **500xxx** ne sont pas disponibles pour la vente. Au besoin, veuillez commander les numéros de pièces séparément.

NOMENCLATURE ET LISTE DES PIÈCES / PARTS BREAKDOWN & PART LIST

Moyeu assemblé #501333 Spindle assembly #501333

| REF. | ENGLISH DESCRIPTION | DESCRIPTION FRANÇAISE | QTY. | PART# |
|------|--|--|------|----------------------------|
| 1 | Spindle | Moyeu | 1 | 108268 |
| 2 | Shaft | Arbre | 1 | 108269 |
| 3 | Bearing | Roulement a billes | 2 | 107359 |
| 4 | Blade | Lame | 1 | 107266 |
| 5 | Key 1/4 x 1/4 x 3/4" | Clé 1/4 x 1/4 x 3/4" | 1 | 107657 |
| 6 | Clutch spacer | Espaceur d'embrayage | 1 | 106616 |
| 7 | V-pulley | Poulie en V | 1 | 107461 |
| 8 | Spacer | Espaceur | 1 | 108363 |
| 9 | Hex. bolt 5/8" n.c. x 7" GR8 | Boulon hex 5/8" n.c. x 7" GR8 | 1 | O/L (300NC.8P_5-8x7) |
| 10 | Nylon insert flange lock nut 5/8" n.c. GR8 | Écrou à bride/garniture de nylon 5/8" n.c. GR8 | 1 | O/L (340NC.8P_5-8) |
| 11 | Relief fitting 1/8" | Soupape de pression 1/8" | 2 | O/L (370.Z_1-8-NPT-Relief) |

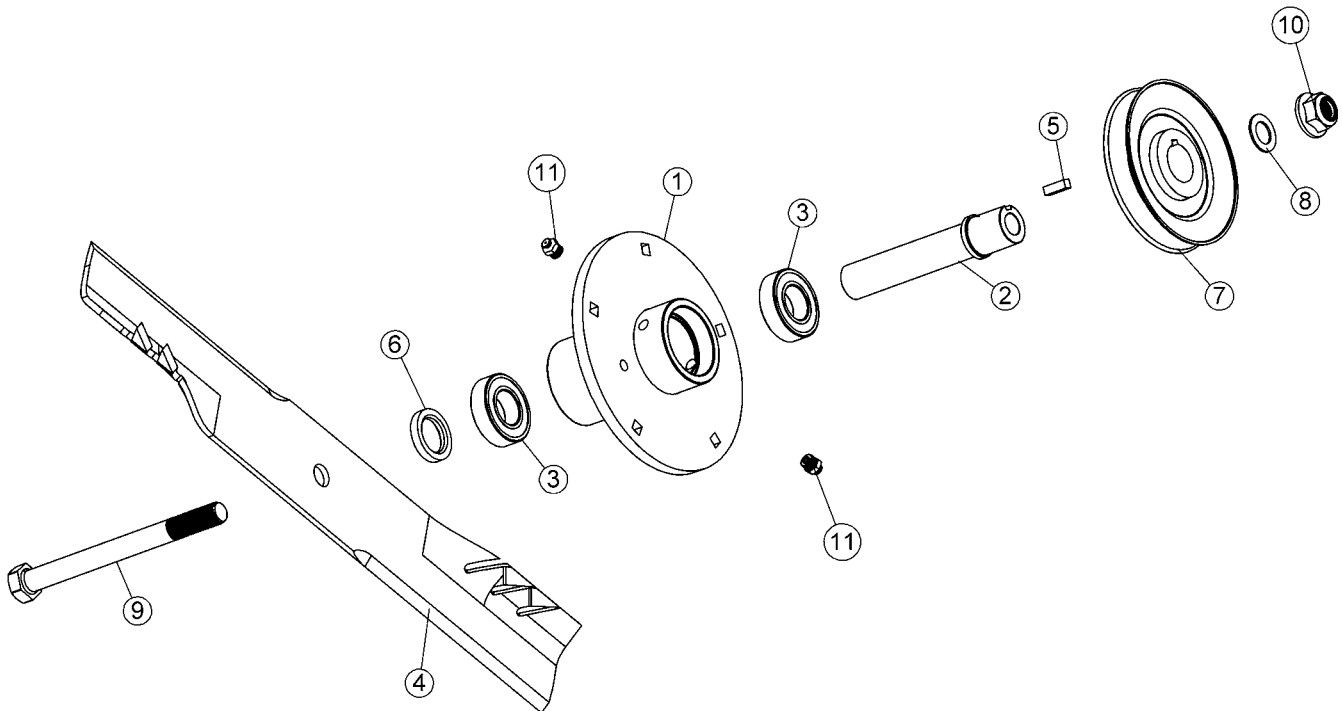

O/L = Obtain Locally / Obtenir localement

Part numbers starting with **500XXX** are not available for sale, however, separate parts are available for sale individually.

Les numéros **500xxx** ne sont pas disponibles pour la vente. Au besoin, veuillez commander les numéros de pièces séparément.

NOMENCLATURE ET LISTE DES PIÈCES / PARTS BREAKDOWN & PART LIST
Bras de tension assemblé #501334
Tensioner assembly #501334

| REF. | ENGLISH DESCRIPTION | DESCRIPTION FRANÇAISE | QTY. | PART# |
|------|----------------------------------|--------------------------------------|------|--------------------------|
| 1 | Bender | Tensionneur | 1 | 108275 |
| 2 | Flat pulley | Poulie plate | 1 | 102300 |
| 3 | Hex. bolt 3/8" n.c. x 1 3/4" GR5 | Boulon hex. 3/8" n.c. x 1 3/4" GR5 | 1 | O/L (300NC.5P_3-8x1-3-4) |
| 4 | Nylon Insert lock Nut 3/8" n.c. | Écrou à garniture de nylon 3/8" n.c. | 1 | O/L (335NC.P_3-8) |
| 5 | Flat washer 3/8" hole | Rondelle plate 3/8" trou | 3 | O/L (360.P_3-8T) |
| 6 | Grease fitting 1/4" n.f. | Graisseur 1/4" n.f. | 1 | O/L (370.Z_1-4-NF) |

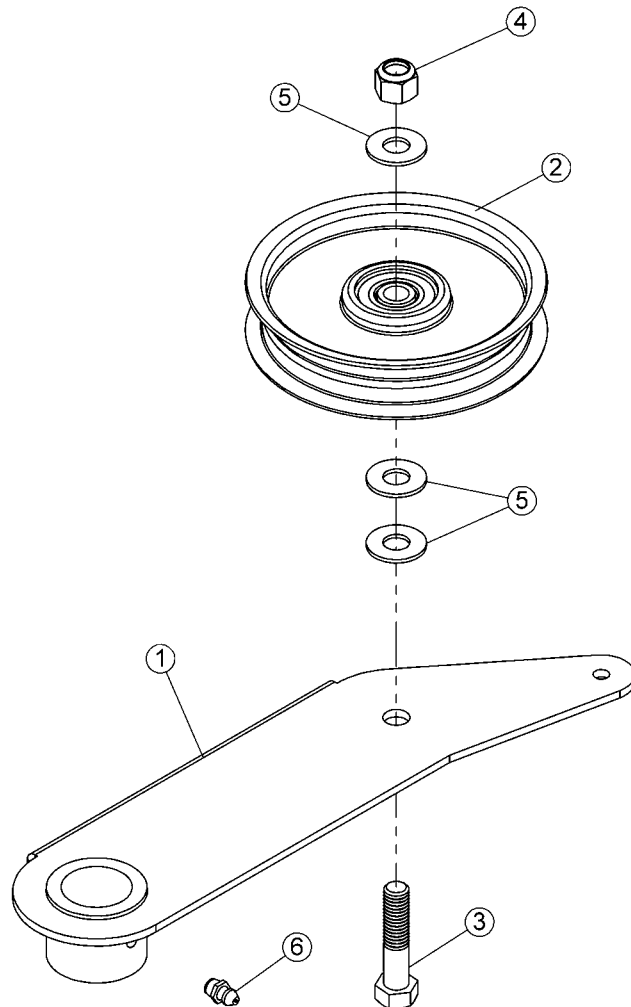

O/L = Obtain Locally / Obtenir localement

Part numbers starting with **500XXX** are not available for sale, however, separate parts are available for sale individually.

Les numéros **500xxx** ne sont pas disponibles pour la vente. Au besoin, veuillez commander les numéros de pièces séparément.

NOMENCLATURE ET LISTE DES PIÈCES / PARTS BREAKDOWN & PART LIST
Panneau électrique #108236
Electric board #108236

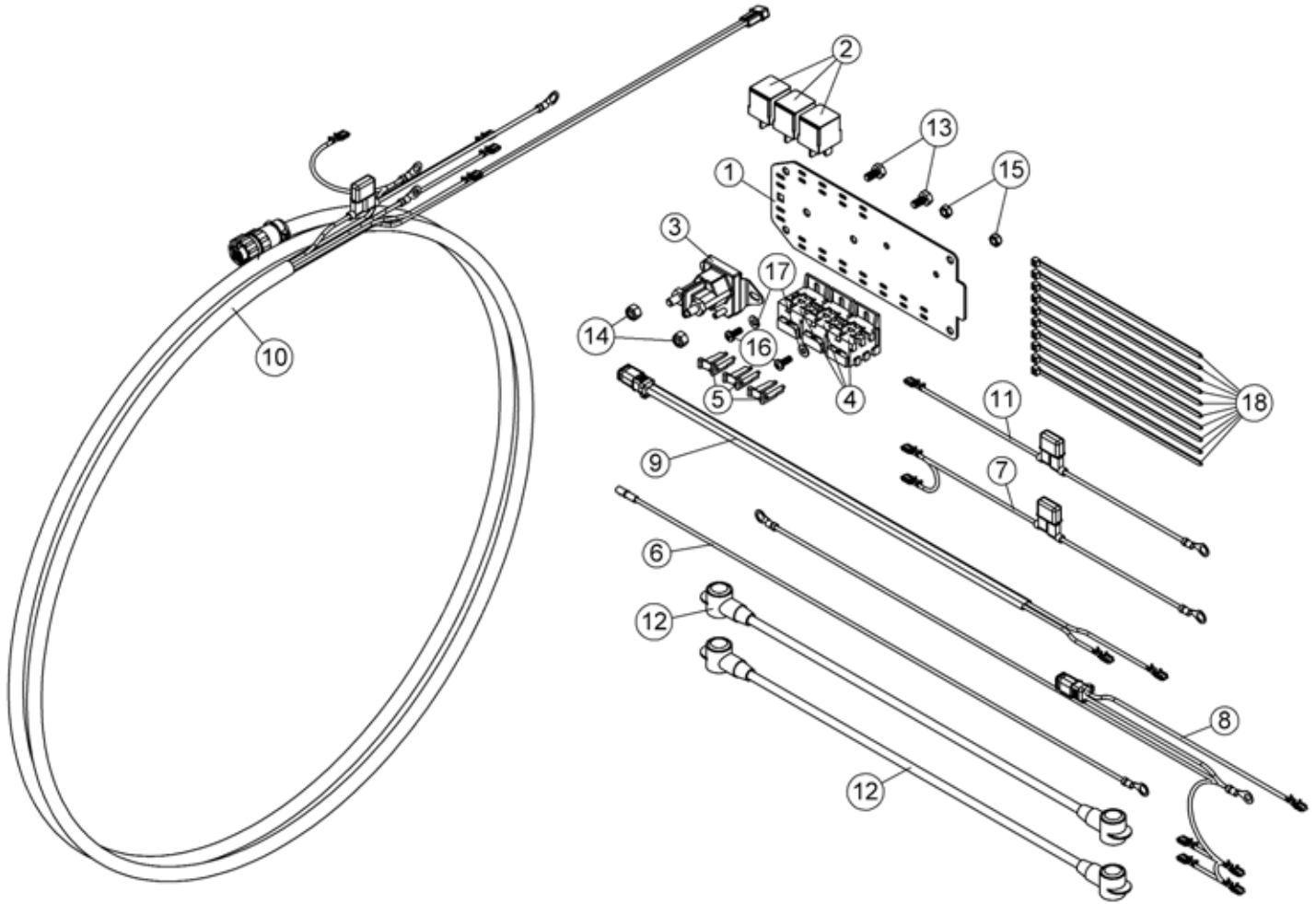

NOMENCLATURE ET LISTE DES PIÈCES / PARTS BREAKDOWN & PART LIST
Panneau électrique #108236
Electric board #108236

| REF. | ENGLISH DESCRIPTION | DESCRIPTION FRANÇAISE | QTY. | PART# |
|------|--|---|------|--------------------------|
| 1 | Board | Panneau | 1 | 108235 |
| 2 | Relay | Relais | 3 | 104405 |
| 3 | Relay | Relais | 1 | 107274 |
| 4 | Relay connector | Connecteur de relais | 3 | 107501 |
| 5 | Relay connector key | Clef du connecteur de relais | 3 | 107502 |
| 6 | Wire assembly | Fil assemblé | 1 | 108228 |
| 7 | Wire assembly | Fil assemblé | 1 | 108229 |
| 8 | Wire assembly | Fil assemblé | 1 | 108230 |
| 9 | Wire assembly | Fil assemblé | 1 | 108231 |
| 10 | Wire assembly | Fil assemblé | 1 | 108232 |
| 11 | Wire assembly | Fil assemblé | 1 | 108233 |
| 12 | Wire asseblly | Fil assemblé | 2 | 108308 |
| 13 | Hex. bolt 1/4" n.c. x 1/2" GR5 | Boulon hex. 1/4" n.c. x 1/2" GR5 | 2 | O/L (300NC.5P_1-4x1-2) |
| 14 | Nylon Insert lock Nut 1/4" n.c. | Écrou à garniture de nylon 1/4" n.c. | 2 | O/L (335NC.P_1-4) |
| 15 | Nylon Insert lock Nut #10x24 n.c. | Écrou à garniture de nylon #10x24 n.c. | 2 | O/L (335NC.P_#10X24) |
| 16 | Machine screw Pan head no.10 x 24 x 1/2" | Vis mécanique tête pan no.10 x 24 x1/2" | 2 | O/L (395NC.P_#10x24x1-2) |
| 17 | Flat washer #10 hole | Rondelle plate #10 trou | 2 | O/L (360.P_#10T) |
| 18 | Tie wrap 8" | Attache de nylon 8" | 10 | O/L (426-8) |

O/L = Obtain Locally / Obtenir localement

Part numbers starting with 500XXX are not available for sale, however, separate parts are available for sale individually.

Les numéros 500xxx ne sont pas disponibles pour la vente. Au besoin, veuillez commander les numéros de pièces séparément.



***WHEN PERFORMANCE
& DEPENDABILITY
ARE NON NEGOTIABLE!***

**Bercomac Limitée
92, Fortin North, Adstock, Quebec, Canada, G0N 1S0**

WWW.BERCOMAC.COM

PRINTED IN CANADA

(ORIGINAL NOTICE)