

206-206-549B - Transaxle

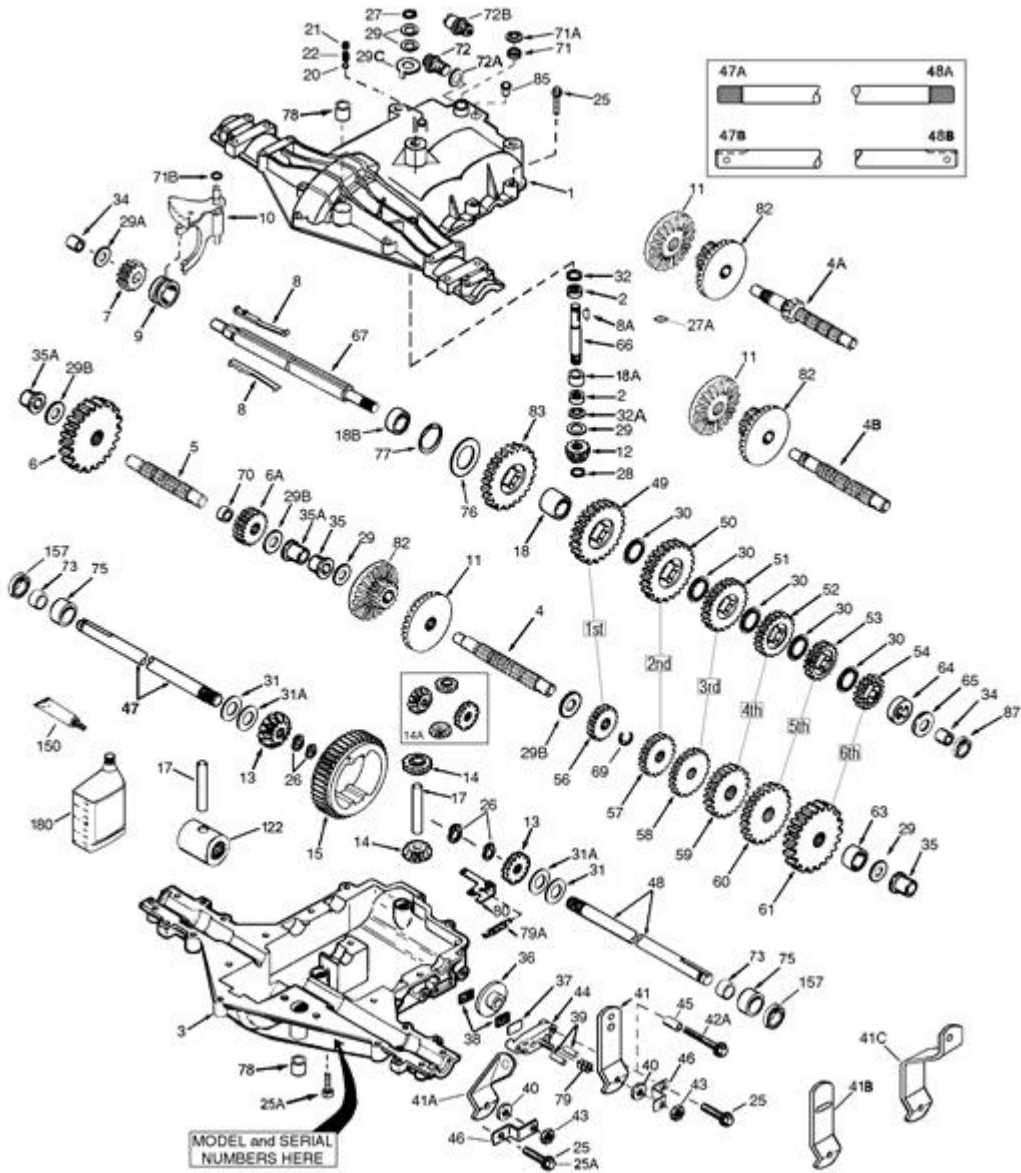

| Ref # | Part # | Description | Context Note | Foot Note | Qty | Min | Order | UOM |
|-------|---------|------------------------------------|--------------|-----------|-----|-----|-------|-----|
| 1 | 772148 | Transaxle Cover (w/switch feature) | | | 1 | | | |
| 2 | 780086A | Needle Bearing 5/8" ID | | | 1 | | | |
| 3 | 770128 | Transaxle Case | | | 1 | | | |
| 4 | 776395 | Countershaft | | | 1 | | | |
| 5 | 776409 | Output Shaft | | | 1 | | | |
| 6 | 778364 | Spur Gear (38 teeth) | | | 1 | | | |
| 6A | 778369 | Spur Gear (15 teeth) | | | 1 | | | |
| 7 | 778330 | Spur Gear (11 teeth) | | | 1 | | | |
| 8 | 792180 | Shift Key | | | 1 | | | |
| 8A | 792047 | Woodruff Key #9 | | | 1 | | | |
| 9 | 784352 | Shift Collar | | | 1 | | | |
| 10 | 784389 | Shift Rod & Fork | | | 1 | | | |
| 11 | 778334 | Bevel Gear (30 teeth) | | | 1 | | | |
| 12 | 778309 | Input Bevel Pinion (13 teeth) | | | 1 | | | |
| 13 | 778368 | Bevel Gear (13 teeth) (Incl. 14) | | | 1 | | | |
| 14 | 778368 | Bevel Pinion (13 teeth) (Incl. 13) | | | 1 | | | |
| 15 | 778370 | Ring Gear (43 teeth) | | | 1 | | | |
| 17 | 786188 | Drive Pin | | | 1 | | | |
| 18 | 786102 | Spacer 1.130 | | | 1 | | | |
| 20 | 792077A | Ball 5/16" DIA | | | 1 | | | |
| 21 | 792211 | Set Screw 3/8-16 x 3/8" | | | 1 | | | |
| 22 | 792079 | Spring | | | 1 | | | |
| 25 | 792073A | Screw 1/4-20 x 1-1/4" | | | 1 | | | |
| 25A | 792177 | Screw 1/4-20 x 1-3/8" | | | 1 | | | |
| 26 | 792125 | Retaining Ring (pkg of 2) | | | 1 | | | |
| 27 | 792035 | Retaining Ring | | | 1 | | | |
| 28 | 788040 | Retaining Ring | | | 1 | | | |
| 29 | 780072 | Thrust Washer .627 ID | | | 1 | | | |
| 29A | 780160 | Thrust Washer .563 ID | | | 1 | | | |
| 29B | 780051 | Thrust Washer .762 ID | | | 1 | | | |
| 30 | 780108 | Cup Washer 1.127 ID | | | 1 | | | |
| 31 | 780001 | Washer (.056 wide) (USE AS NEEDED) | | | 1 | | | |
| 31A | 780195 | Flat Washer (.062 wide) | | | 1 | | | |
| 32 | 788083 | Oil Seal 5/8" | | | 1 | | | |
| 34 | 780194 | Bushing 9/16" ID | | | 1 | | | |
| 35 | 780193 | Flanged Bushing 5/8" ID | | | 1 | | | |
| 35A | 780197 | Flanged Bushing 3/4" | | | 1 | | | |
| 47 | 774943 | Axle (12-7/16" long) | | | 1 | | | |
| 48 | 774837 | Axle (17" long) | | | 1 | | | |
| 49 | 778356 | Spur Gear (29 teeth) | | | 1 | | | |
| 50 | 778338 | Spur Gear (27 teeth) | | | 1 | | | |
| 51 | 778354 | Spur Gear (23 teeth) | | | 1 | | | |
| 52 | 778313 | Spur Gear (19 teeth) | | | 1 | | | |
| 53 | 778350 | Spur Gear (16 teeth) | | | 1 | | | |
| 54 | 778346 | Spur Gear (15 teeth) | | | 1 | | | |
| 56 | 778355 | Spur Gear (11 teeth) | | | 1 | | | |
| 57 | 778337 | Spur Gear (13 teeth) | | | 1 | | | |
| 58 | 778353 | Spur Gear (17 teeth) | | | 1 | | | |
| 59 | 778351 | Spur Gear (21 teeth) | | | 1 | | | |
| 60 | 778349 | Spur Gear (24 teeth) | | | 1 | | | |

| Ref # | Part # | Description | Context Note | Foot Note | Qty | Min Order | UOM |
|-------|---------|-----------------------------------|--------------|-----------|-----|-----------|-----|
| 61 | 778345 | Spur Gear (25 teeth) | | | 1 | | |
| 65 | 780189 | Flat Washer .563 ID | | | 1 | | |
| 66 | 776422 | Input Shaft | | | 1 | | |
| 67 | 776396 | Shifter & Brake Shaft | | | 1 | | |
| 69 | 792170 | Retaining Ring | | | 1 | | |
| 70 | 786187 | Spacer .890 | | | 1 | | |
| 71B | 788092 | "O" Ring .426 ID | | | 1 | | |
| 72A | 788098 | O-ring (.489 ID) | | | 1 | | |
| 72B | 786194 | Neutral Safety Switch | | | 1 | | |
| 73 | 780140 | Needle Bearing | | | 1 | | |
| 75 | 786084 | Sleeve | | | 1 | | |
| 76 | 780090 | Flat Washer 1.128 ID | | | 1 | | |
| 77 | 788078A | Inverted Retaining Ring | | | 1 | | |
| 82 | 778333 | Bevel & Spur Gear (30 & 13 teeth) | | | 1 | | |
| 83 | 778338 | Spur Gear (27 teeth) | | | 1 | | |
| 85 | 792154 | Oil Fill Plug | | | 1 | | |
| 87 | 788089A | Oil Seal 9/16" | | | 1 | | |
| 150 | 788093A | Liquid Gasket RTV Silicone | | | 1 | | |
| 157 | 788088A | Oil Seal 3/4" | | | 1 | | |
| 180 | 730229A | Gear Oil 80W90 | | | 1 | | |